

# **POM<sup>®</sup>**

**CHAIN**

**ISO 9001:2000  
CERTIFIED**

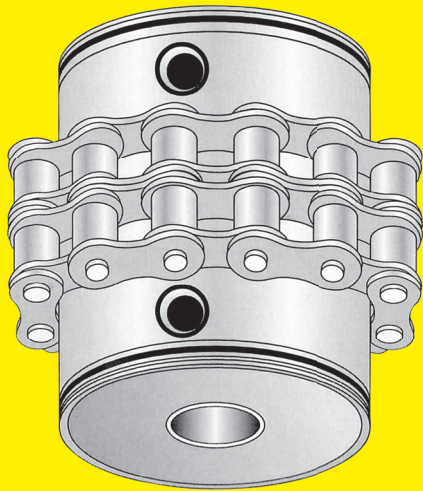

**PRECISION  
ROLLER CHAIN**

**SOLID BUSH  
SOLID ROLLER**



**P.S.M. MACHINERY LTD., PART.**

**PIN**

Pins act as chain bearing members to receive shearing and bending force when load is applied to chain. Therefore, pins must have high strength and toughness as well as resistance to wear.

**LINK PLATE**

The chain link plates act as the main tension members when load is applied to chain. As such, link plates must have maximum strength and resistance to fatigue to withstand demanding conditions of heavy, pulsating and shock loads.

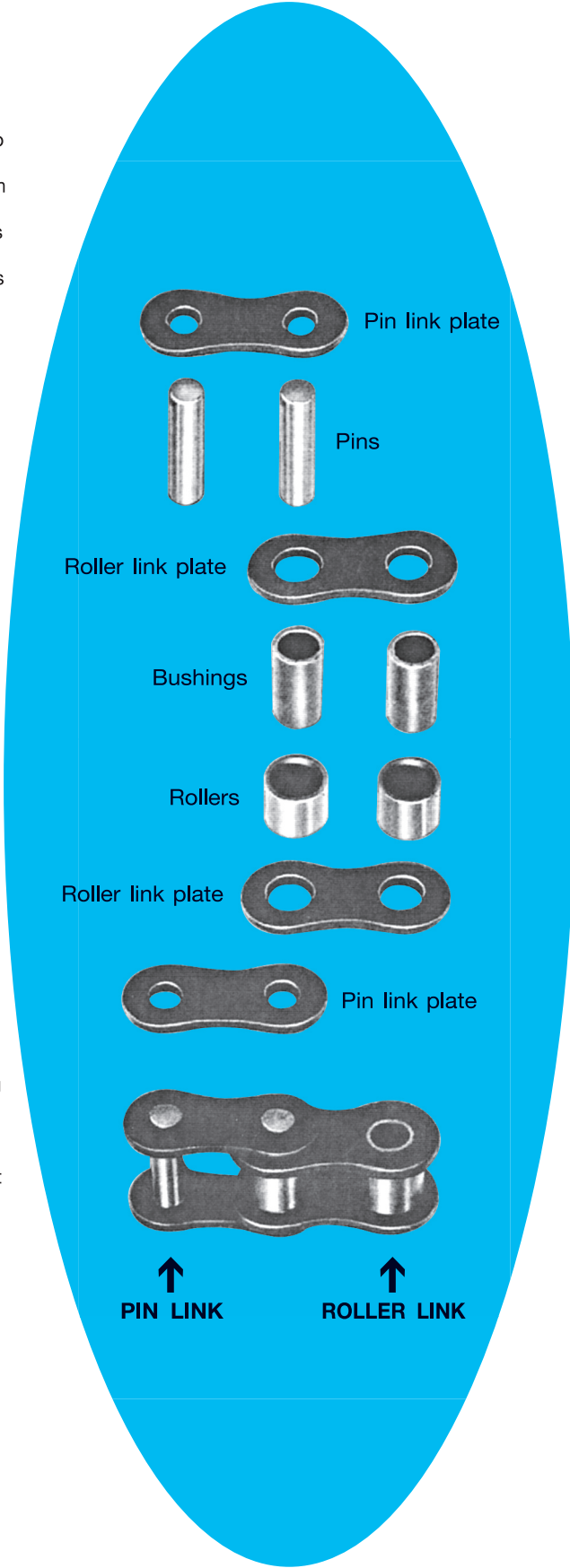

**ROLLER**

The rollers act as shock absorbing members to protect other component parts when chain engages with sprocket teeth, thus must have toughness with proper surface hardness.

**BUSHING**

The bushings act as chain bearing members along with pins. Bushings have particularly high wear resisting properties together with proper strength and toughness.

↑  
**PIN LINK**

↑  
**ROLLER LINK**

**PIN LINK**

An outside link consisting of two pin link plates assembled with two pins. There are three types of pin links :

Riveted :

Standard type of pin link.

Double Cotter :

Pin link with two cotters.

Long Solid Cotter :

Pin link with one long cotter.

**PIN LINKS**



Riveted



Double cotter

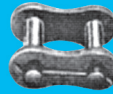

Long solid cotter

**ROLLER LINK**

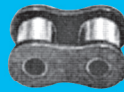

Roller link

**CONNECTING LINKS**



Spring clip



Cotter pin

**OFFSET LINKS**



Two pitch offset link



One pitch offset link

**CONNECTING LINK**

An outside link consisting of a pin link plate, two assembled pins and a detachable pin link plate. There are two types of connecting links :

Spring Clip Type :

The detachable pin link plate is retained by a spring clip which engages grooves cut in the ends of the pins.

Cotter Pin Type :

With two cotters.

**ROLLER LINK**

An inside link consisting of two roller link plates, two bushings and two rollers.

**OFFSET LINK**

A link consisting of two offset link plates, a bushing, a roller, a removable pin, and cotter.

The two pitch offset link consisting of a roller link and an offset link, which are connected by a riveted press-fit pin.

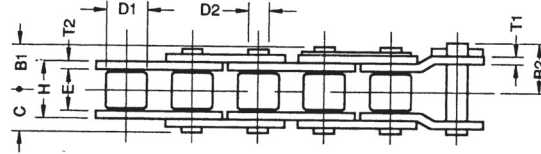
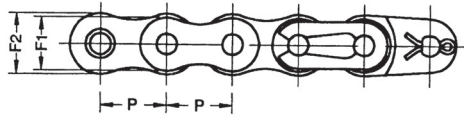

ANSI Chain No.	Pitch x Width		Roller		Pin			Links					Transverse Pitch K	Avg. Ulti Tensile Strength kgf	Approx. Weight kg/m
	P	x E	D1	C	B1	B2	D2	T1	T2	H	F1	F2			
	inch	mm	mm	mm	mm	mm	mm	mm	mm	mm	mm	mm			
PM 25	1/4 x 1/8	6.35 x 3.18	3.30	3.89	4.80	-	2.32	0.76	0.76	4.80	5.01	5.81	-	480	0.13
PM 35	3/8 x 3/16	9.525 x 4.78	5.08	5.81	7.01	7.66	3.59	1.28	1.28	7.46	7.80	9.04	-	1150	0.32
PM 40	1/2 x 5/16	12.70 x 7.92	7.92	8.16	9.36	10.56	3.98	1.49	1.49	11.17	10.41	12.06	-	1950	0.62
PM 41	1/2 x 1/4	12.70 x 6.35	7.77	6.64	7.98	8.43	3.59	1.28	1.28	9.06	8.50	9.90	-	1200	0.41
PM 50	5/8 x 3/8	15.875 x 9.52	10.16	10.15	11.55	12.32	5.09	2.01	2.01	13.84	13.01	15.08	-	3200	1.01
PM 60	3/4 x 1/2	19.05 x 12.70	11.91	12.63	14.00	15.43	5.96	2.38	2.38	17.75	15.64	18.09	-	4500	1.45
PM 80	1 x 5/8	25.4 x 15.88	15.87	16.38	18.38	20.05	7.94	3.18	3.18	22.60	20.82	24.13	-	8000	2.55
PM 100	1-1/4 x 3/4	31.75 x 19.05	19.05	20.04	-	23.90	3.99	3.99	3.99	27.45	26.03	30.16	-	12000	3.95
PM 120	1-1/2 x 1	38.1 x 25.4	22.22	24.96	-	30.96	11.11	4.80	4.80	35.45	31.24	36.19	-	17000	5.64
PM 140	1-3/4 x 1	44.45 x 25.40	25.40	27.08	-	31.97	12.71	5.57	5.57	37.18	36.44	42.22	-	22000	7.38
PM 160	2 x 1-1/4	50.80 x 31.75	28.57	32.54	-	37.3	14.29	6.49	6.49	45.21	41.65	48.26	-	27500	9.40
PM 180	2 1/4 x 1 13/32	57.15 x 35.71	35.71	36.20	-	44.95	17.46	7.14	7.14	50.85	46.86	54.29	-	36500	12.67
PM 200	2 1/2 x 1 1/2	63.50 x 38.10	39.67	40.15	-	46.35	19.85	7.93	7.93	54.88	52.07	60.32	-	49500	15.90
PM 240	3 x 1.875	76.20 x 47.63	47.63	48.95	-	55.35	23.81	9.53	9.53	67.81	62.48	72.39	-	69550	24.4

- |  |  |
|--|--|
| <p><b>CONVENTIONAL</b></p> <ol style="list-style-type: none"> <li>1. Steel Strip</li> <li>2. Cut and Curl</li> <li>3. Curl Further</li> <li>4. Complete Curl</li> <li>5. Heat Treated</li> </ol> | <p><b>SOLID BUSHING &amp; SOLID ROLLER (SBSR)</b></p> <ol style="list-style-type: none"> <li>1. Alloy Steel Bar</li> <li>2. Cut</li> <li>3. Cold Forged</li> <li>4. Punch Out Bottom</li> <li>5. Heat Treated</li> </ol> |
|--|--|

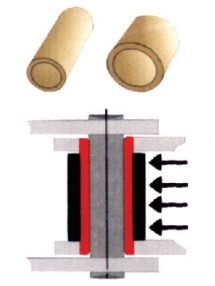
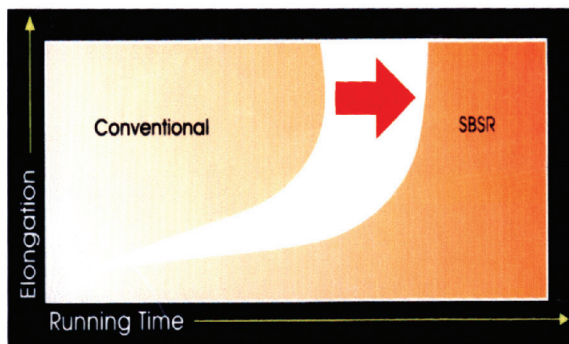
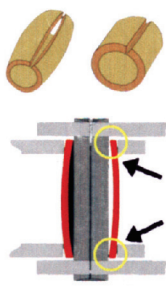

\* NEW SOLID BUSHING & SOLID ROLLER CHAIN No. 40, 50, 60, 80 (SBSR)



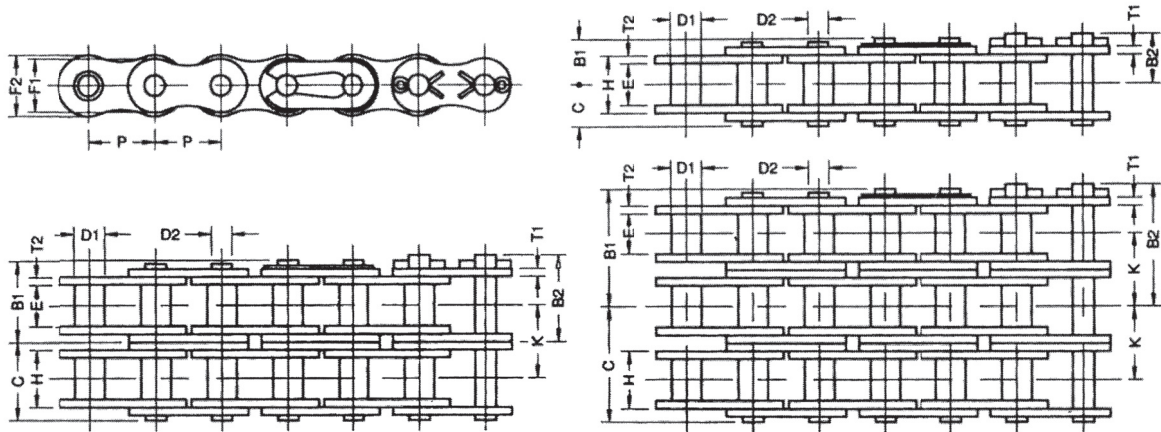

ANSI Chain No.	Pitch x Width		Roller	Pin				Links					Transverse Pitch	Avg. Ulti Tensile Strength	Approx. Weight		
	P	x E		D1	C	B1	B2	D2	T1	T2	H	F1				F2	K
	inch	mm		mm	mm	mm	mm	mm	mm	mm	mm	mm				mm	mm
PM 25-2	1/4 x 1/8	6.35 x 3.18	3.30	7.10	8.05	-	2.32	0.76	0.76	4.80	5.01	5.81	6.40	960	0.25		
PM 35-2	3/8 x 3/16	9.525 x 4.78	5.08	11.14	11.88	12.72	3.59	1.28	1.28	7.46	7.80	9.04	10.13	2300	0.63		
PM 40-2	1/2 x 5/16	12.70 x 7.92	7.92	15.39	16.79	17.79	3.98	1.49	1.49	11.17	10.41	12.06	14.38	3900	1.22		
PM 50-2	5/8 x 3/8	15.875 x 9.52	10.16	19.10	20.50	21.50	5.09	2.01	2.01	13.84	13.01	15.08	18.11	6400	2.00		
PM 60-2	3/4 x 1/2	19.05 x 12.70	11.91	24.00	25.40	26.72	5.96	2.38	2.38	17.75	15.64	18.09	22.78	9000	2.87		
PM 80-2	1 x 5/8	25.4 x 15.88	15.87	30.98	33.08	35.08	7.94	3.18	3.18	22.60	20.82	24.13	29.29	16000	5.05		
PM 100-2	1-1/4 x 3/4	31.75 x 19.05	19.05	37.9	-	42.19	9.54	3.99	3.99	27.45	26.03	30.16	35.76	24000	7.86		
PM 120-2	1-1/2 x 1	38.1 x 25.4	22.22	47.93	-	52.3	11.11	4.80	4.80	35.45	31.24	36.19	45.44	32600	11.20		
PM 140-2	1-3/4 x 1	44.45 x 25.40	25.40	51.50	-	56.77	12.71	5.57	5.57	37.18	36.44	42.22	48.87	42800	14.66		
PM 160-2	2 x 1-1/4	50.80 x 31.75	28.57	62.19	-	66.8	14.29	6.49	6.49	45.21	41.65	48.26	58.55	54000	18.64		
PM 180-2	2 1/4 x 1 13/32	57.15 x 35.71	35.71	69.12	-	77.87	17.46	7.14	7.14	50.85	46.86	54.29	65.84	73000	25.14		
PM 200-2	2 1/2 x 1 1/2	63.50 x 38.10	39.67	75.89	-	80.55	19.85	7.93	7.93	54.88	52.07	60.32	71.55	94000	31.37		
PM 240-2	3 x 1.875	76.20 x 47.63	47.63	92.90	-	99.20	23.81	9.53	9.53	67.81	62.48	72.39	87.83	139100	48.4		

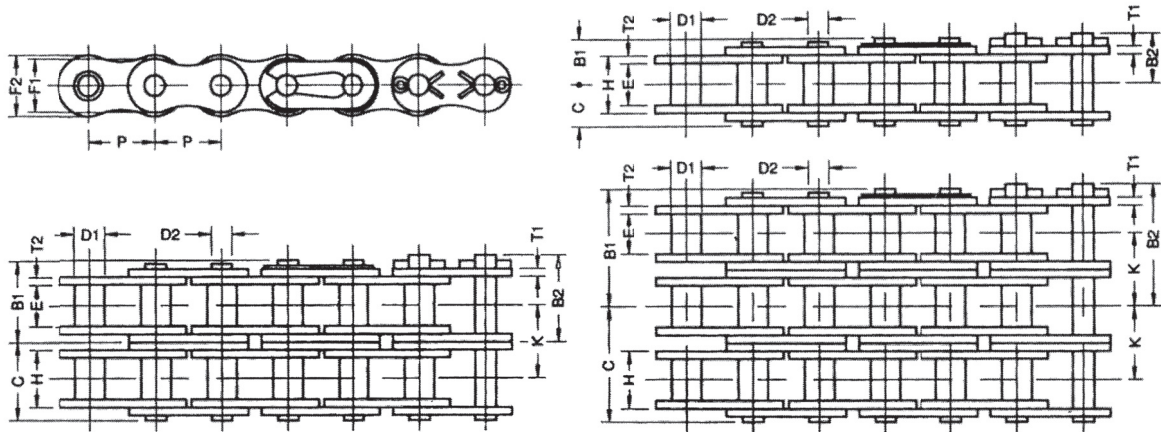

ANSI Chain No.	Pitch x Width		Roller	Pin				Links					Transverse Pitch K	Avg. Ulti Tensile Strength kgf	Approx. Weight kg/m	
	P	x E		D1	C	B1	B2	D2	T1	T2	H	F1				F2
	inch	mm		mm	mm	mm	mm	mm	mm	mm	mm	mm				mm
PM 25-3	1/4 x 1/8	6.35 x 3.18	3.30	10.29	11.20	-	2.32	0.76	0.76	4.80	5.01	5.81	6.40	1440	0.37	
PM 35-3	3/8 x 3/16	9.525 x 4.78	5.08	16.02	17.15	17.84	3.59	1.28	1.28	7.46	7.80	9.04	10.13	3450	0.63	
PM 40-3	1/2 x 5/16	12.70 x 7.92	7.92	22.54	24.04	24.94	3.98	1.49	1.49	11.17	10.41	12.06	14.38	5850	1.82	
PM 50-3	5/8 x 3/8	15.875 x 9.52	10.16	28.20	29.90	30.95	5.09	2.01	2.01	13.84	13.01	15.08	18.11	9600	2.98	
PM 60-3	3/4 x 1/2	19.05 x 12.70	11.91	35.46	36.86	38.16	5.96	2.38	2.38	17.75	15.64	18.09	22.78	13500	4.28	
PM 80-3	1 x 5/8	25.4 x 15.88	15.87	45.48	47.78	49.38	7.94	3.18	3.18	22.60	20.82	24.13	29.29	24000	7.54	
PM 100-3	1-1/4 x 3/4	31.75 x 19.05	19.05	55.8	-	60.09	9.54	3.99	3.99	27.45	26.03	30.16	35.76	36000	11.75	
PM 120-3	1-1/2 x 1	38.1 x 25.4	22.22	70.4	-	75.36	11.11	4.80	4.80	35.45	31.24	36.19	45.44	48900	16.73	
PM 140-3	1-3/4 x 1	44.45 x 25.40	25.40	76.28	-	80.57	12.71	5.57	5.57	37.18	36.44	42.22	48.87	64200	21.93	
PM 160-3	2 x 1-1/4	50.80 x 31.75	28.57	91.54	-	96.1	14.29	6.49	6.49	45.21	41.65	48.26	58.55	81000	27.89	
PM 180-3	2 1/4 x 1 13/32	57.15 x 35.71	35.71	102.04	-	110.80	17.46	7.14	7.14	50.85	46.86	54.29	65.84	109500	37.60	
PM 200-3	2 1/2 x 1 1/2	63.50 x 38.10	39.67	111.67	-	116.33	19.85	7.93	7.93	54.88	52.07	60.32	71.55	141000	47.29	
PM 240-3	3 x 1.875	76.20 x 47.63	47.63	136.80	-	143.20	23.81	9.53	9.53	67.81	62.48	72.39	87.83	208650	72.4	

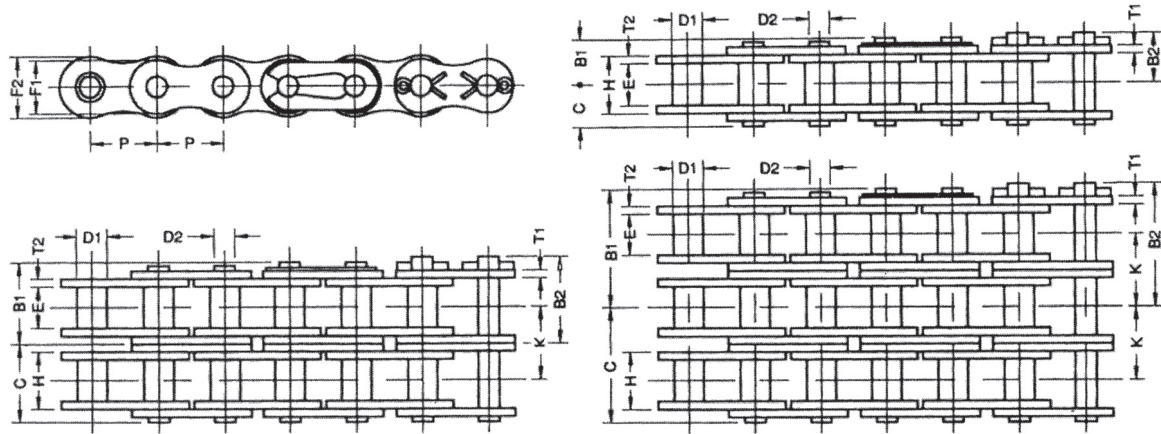

ANSI Chain No.	Pitch x Width		Roller	Pin				Links					Transverse Pitch	Avg. Ulti Tensile Strength	Approx. Weight		
	P	x E		D1	C	B1	B2	D2	T1	T2	H	F1				F2	K
	inch	mm		mm	mm	mm	mm	mm	mm	mm	mm	mm				mm	mm
PM 35-4	3/8 x 3/16	9.525 x 4.78	5.08	21.02	22.25	22.95	3.59	1.28	1.28	7.46	7.80	9.04	10.13	4600	1.25		
PM 40-4	1/2 x 5/16	12.70 x 7.92	7.92	29.73	31.54	32.14	3.98	1.49	1.49	11.17	10.41	12.06	14.38	7800	2.43		
PM 50-4	5/8 x 3/8	15.875 x 9.52	10.16	37.60	38.90	39.70	5.09	2.01	2.01	13.84	13.01	15.08	18.11	12800	3.98		
PM 60-4	3/4 x 1/2	19.05 x 12.70	11.91	46.85	48.25	49.57	5.96	2.38	2.38	17.75	15.64	18.09	22.78	18000	5.70		
PM 80-4	1 x 5/8	25.4 x 15.88	15.87	60.63	62.23	64.53	7.94	3.18	3.18	22.60	20.82	24.13	29.29	32000	10.06		
PM 100-4	1-1/4 x 3/4	31.75 x 19.05	19.05	73.7	-	77.89	9.54	3.99	3.99	27.45	26.03	30.16	35.76	48000	15.65		
PM 120-4	1-1/2 x 1	38.1 x 25.4	22.22	93.1	-	97.7	11.11	4.80	4.80	35.45	31.24	36.19	45.44	65200	22.28		

## D-1, D-3 :

These are extended pin attachments which are modified pins with extension. The extended pin has the same diameter as the chain pin.

## A-1, K-1 :

These are bent attachments which are modified link plates with bent lugs on one side or both sides, with one hole.

## WA-1, WA-2, WK-1, WK-2 :

These are wide contour bent attachments which are bent link plates with full link plate width, with one hole or two holes.

## WM35, WM1, WM35-2, WM2 :

These are wide contour straight attachments which are modified link plates with straight lugs on one side or both sides, with one hole or two holes.

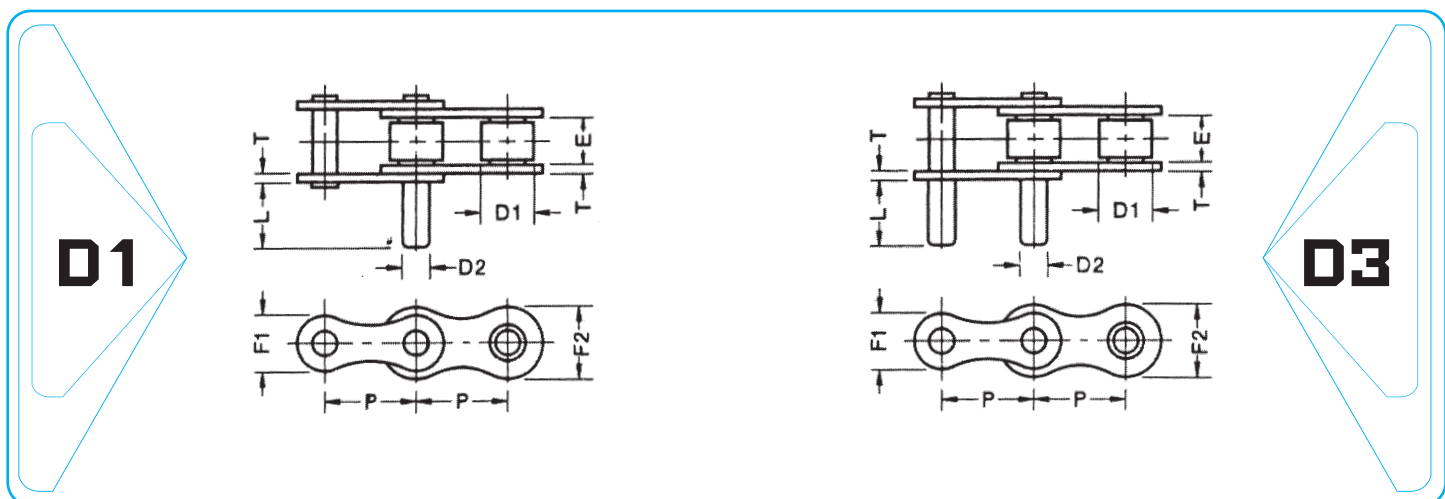

ANSI Chain No.	Pitch x Width		Roller	Pin			Links			Avg. Ulti Tensile Strength
	P	x E		D1	D2	L	T	F1	F2	
	inch	mm	mm	mm	mm	mm	mm	mm	kgf	
PM 35	3/8 x 3/16	9.525 x 4.78	5.08	3.59	9.52	1.28	7.80	9.04	1150	
PM 41	1/2 x 1/4	12.70 x 6.35	7.77	3.59	9.52	1.28	8.50	9.90	1200	
PM 40	1/2 x 5/16	12.70 x 7.92	7.92	3.98	9.52	1.49	10.41	12.06	1950	
PM 50	5/8 x 3/8	15.875 x 9.52	10.16	5.09	11.91	2.01	13.01	15.08	3200	
PM 60	3/4 x 1/2	19.05 x 12.70	11.91	5.96	14.27	2.38	15.64	18.09	4500	
PM 80	1 x 5/8	25.4 x 15.88	15.87	7.94	19.05	3.18	20.82	24.13	8000	
PM 100	1-1/4 x 3/4	31.75 x 19.05	19.05	9.54	23.83	3.99	26.03	30.16	12000	
PM 120	1-1/2 x 1	38.1 x 25.40	22.22	11.11	28.58	4.80	31.24	36.19	17000	
PM 140	1-3/4 x 1	44.45 x 25.40	25.40	12.71	33.32	5.57	36.44	42.22	22000	

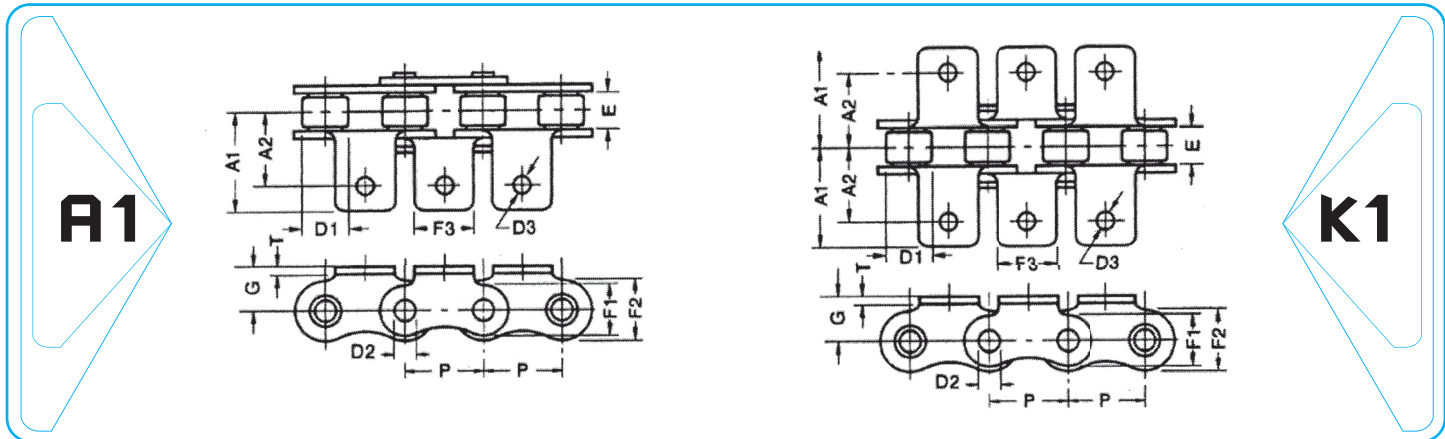

ISO Chain No.	Pitch x Width		Roller D1	Pin D2	Links			Attachment					Avg. Ulti Tensile Strength kgf
	P	E			T	F1	F2	A1	A2	F3	D3	G	
	inch	mm			mm	mm	mm	mm	mm	mm	mm	mm	
PM 35	3/8 x 3/16	9.525 x 4.78	5.08	3.59	1.28	7.80	9.04	13.10	9.52	7.94	2.78	6.35	1150
PM 41	1/2 x 1/4	12.70 x 6.35	7.77	3.59	1.28	8.50	9.90	16.27	11.90	9.52	3.57	7.14	1200
PM 40	1/2 x 5/16	12.70 x 7.92	7.92	3.98	1.49	10.41	12.06	17.47	12.70	9.52	3.57	7.92	1950
PM 50	5/8 x 3/8	15.875 x 9.52	10.16	5.09	2.01	13.01	15.08	24.60	15.88	14.28	5.16	10.31	3200
PM 60	3/4 x 1/2	19.05 x 12.70	11.91	5.96	2.38	15.64	18.09	27.78	19.05	15.88	5.16	11.91	4500
PM 80	1 x 5/8	25.4 x 15.88	15.87	7.94	3.18	20.82	24.13	39.29	25.40	19.05	6.75	15.88	8000
PM 100	1-1/4 x 3/4	31.75 x 19.05	19.05	9.54	3.99	26.03	30.16	43.00	31.75	25.40	8.33	19.84	12000
PM 120	1-1/2 x 1	38.1 x 25.40	22.22	11.11	4.80	31.24	36.19	53.00	38.10	28.58	9.92	23.01	17000

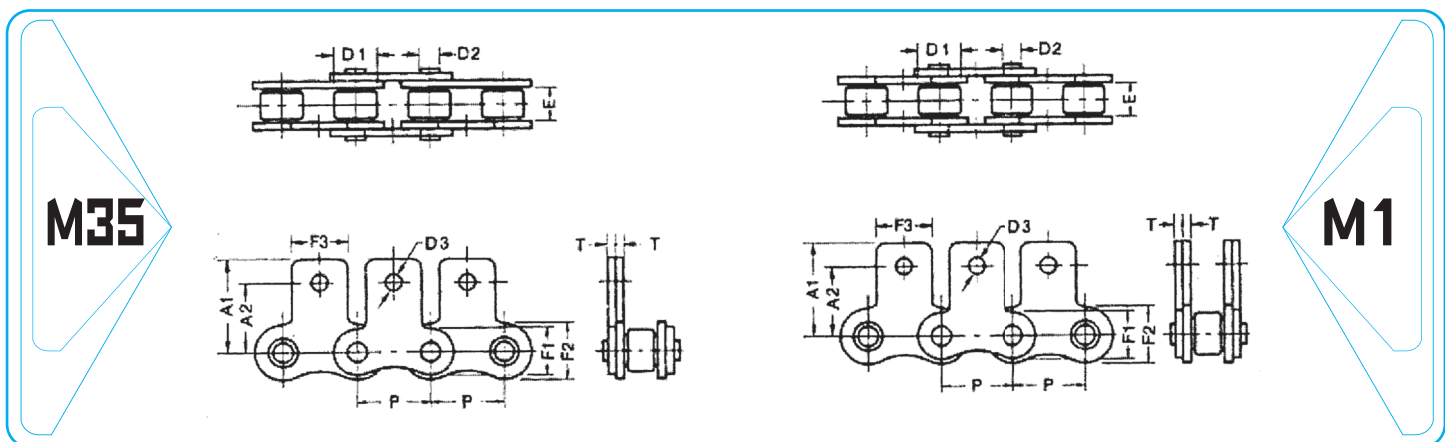

ISO Chain No.	Pitch x Width		Roller D1	Pin D2	Links			Attachment				Avg. Ulti Tensile Strength kgf
	P	E			T	F1	F2	A1	A2	F3	D3	
	inch	mm			mm	mm	mm	mm	mm	mm	mm	
PM 35	3/8 x 3/16	9.525 x 4.78	5.08	3.59	1.28	7.80	9.04	13.49	9.52	7.94	2.78	1150
PM 41	1/2 x 1/4	12.70 x 6.35	7.77	3.59	1.28	8.50	9.90	16.46	12.70	9.52	3.57	1200
PM 40	1/2 x 5/16	12.70 x 7.92	7.92	3.98	1.49	10.41	12.06	17.46	12.70	9.52	3.57	1950
PM 50	5/8 x 3/8	15.875 x 9.52	10.16	5.09	2.01	13.01	15.08	24.45	15.88	14.28	5.16	3200
PM 60	3/4 x 1/2	19.05 x 12.70	11.91	5.96	2.38	15.64	18.09	26.19	18.26	15.88	5.16	4500
PM 80	1 x 5/8	25.4 x 15.88	15.87	7.94	3.18	20.82	24.13	34.00	24.61	19.05	6.75	8000
PM 100	1-1/4 x 3/4	31.75 x 19.05	19.05	9.54	3.99	26.03	30.16	41.86	31.75	25.40	8.33	12000
PM 120	1-1/2 x 1	38.1 x 25.40	22.22	11.11	4.80	31.24	36.19	49.73	36.53	28.58	9.92	17000



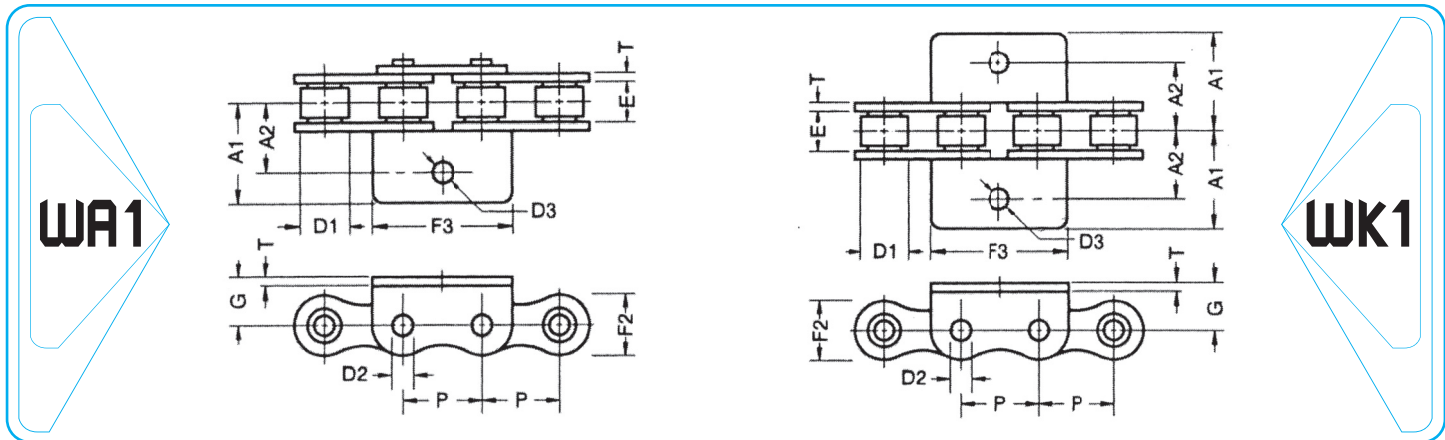

ISO Chain No.	Pitch x Width		Roller D1	Pin D2	Links		Attachment					Avg. Ulti Tensile Strength kgf
	P	x E			T	F2	A1	A2	F3	D3	G	
	inch	mm	mm	mm	mm	mm	mm	mm	mm	mm	mm	
PM 35	3/8 x 3/16	9.525 x 4.78	5.08	3.59	1.28	9.04	14.38	9.52	18.33	2.78	6.35	1150
PM 40	1/2 x 5/16	12.70 x 7.92	7.92	3.98	1.49	12.06	17.46	12.70	23.10	3.57	7.92	1950
PM 50	5/8 x 3/8	15.875 x 9.52	10.16	5.09	2.01	15.08	24.70	15.88	28.72	5.16	10.31	3200
PM 60	3/4 x 1/2	19.05 x 12.70	11.91	5.96	2.38	18.09	26.99	19.05	36.25	5.16	11.91	4500
PM 80	1 x 5/8	25.4 x 15.88	15.87	7.94	3.18	24.13	35.23	25.40	48.64	6.75	15.88	8000

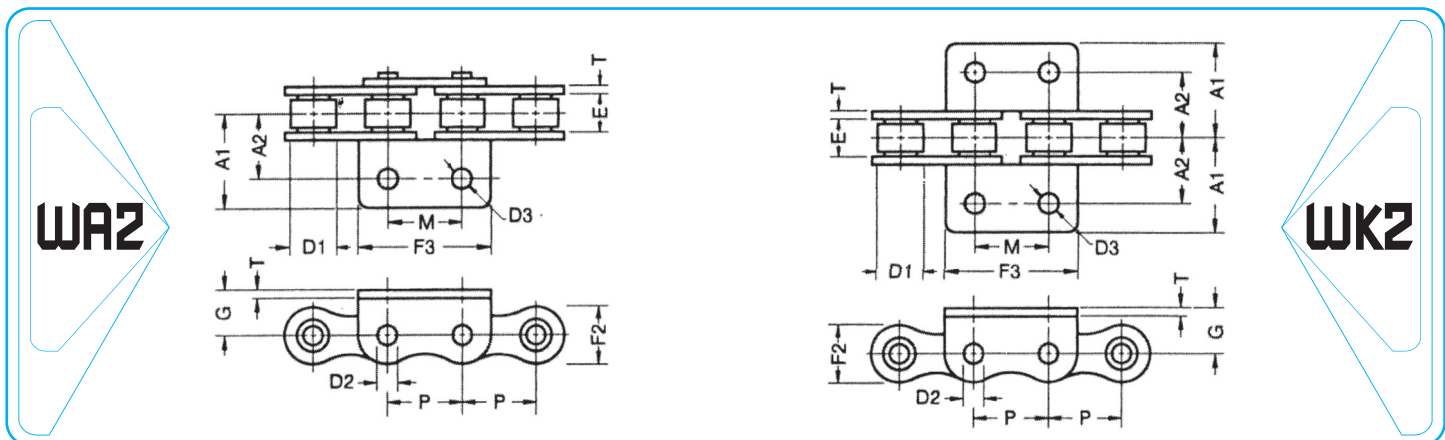

ISO Chain No.	Pitch x Width		Roller D1	Pin D2	Links		Attachment						Avg. Ulti Tensile Strength kgf
	P	x E			T	F2	A1	A2	F3	D3	G	M	
	inch	mm	mm	mm	mm	mm	mm	mm	mm	mm	mm	mm	
PM 35	3/8 x 3/16	9.525 x 4.78	5.08	3.59	1.28	9.04	14.38	9.52	18.33	2.78	6.35	9.52	1150
PM 40	1/2 x 5/16	12.70 x 7.92	7.92	3.58	1.49	12.06	17.46	12.70	23.10	3.57	7.92	12.70	1950
PM 50	5/8 x 3/8	15.875 x 9.52	10.16	5.09	2.01	15.08	24.70	15.88	28.72	5.16	10.31	15.88	3200
PM 60	3/4 x 1/2	19.05 x 12.70	11.91	5.96	2.38	18.09	26.99	19.05	36.25	5.16	11.91	19.05	4500
PM 80	1 x 5/8	25.4 x 15.88	15.87	7.94	3.18	24.13	34.23	25.40	48.64	6.75	15.88	25.40	8000



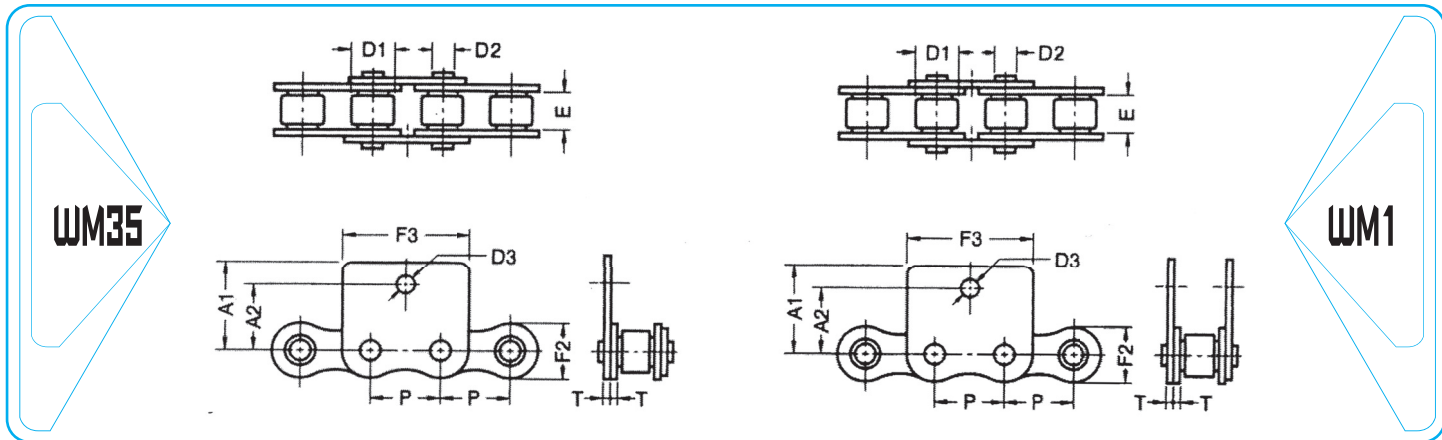

ISO Chain No.	Pitch x Width		Roller	Pin	Links		Attachment				Avg. Ulti Tensile Strength kgf
	P	E			T	F2	A1	A2	F3	D3	
	inch	mm	mm	mm	mm	mm	mm	mm	mm	mm	
PM 35	3/8 x 3/16	9.525 x 4.78	5.08	3.59	1.28	9.04	14.68	9.52	18.33	2.78	1150
PM 40	1/2 x 5/16	12.70 x 7.92	7.92	3.98	1.49	12.06	17.30	12.70	23.10	3.57	1950
PM 50	5/8 x 3/8	15.875 x 9.52	10.16	5.09	2.01	15.08	24.61	15.88	28.72	5.16	3200
PM 60	3/4 x 1/2	19.05 x 12.70	11.91	5.96	2.38	18.09	26.11	18.26	36.25	5.16	4500
PM 80	1 x 5/8	25.4 x 15.88	15.87	7.94	3.18	24.13	34.25	24.61	48.64	6.75	8000

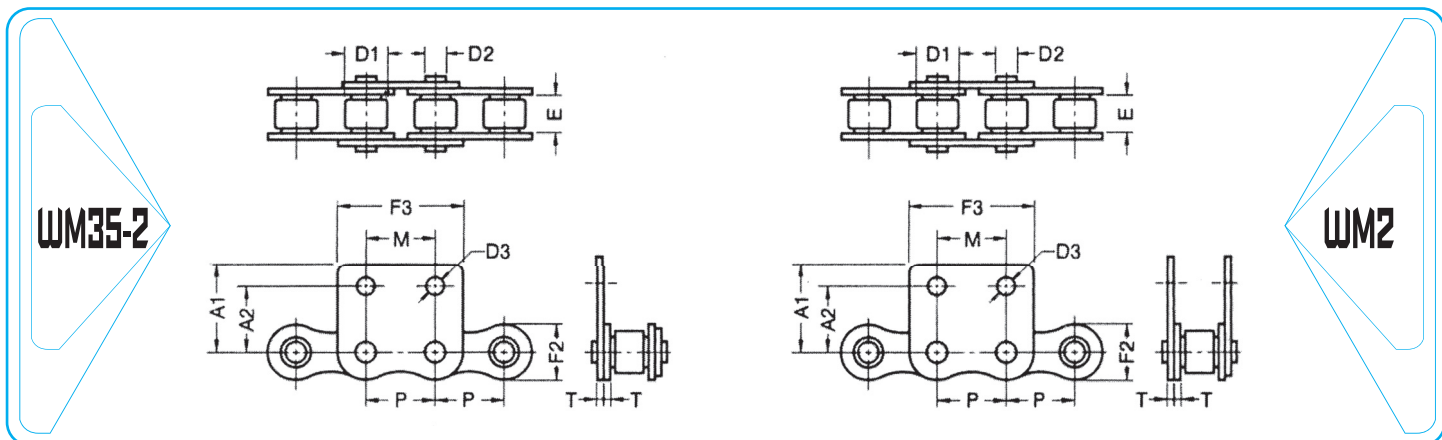

ISO Chain No.	Pitch x Width		Roller	Pin	Links		Attachment					Avg. Ulti Tensile Strength kgf
	P	E			T	F2	A1	A2	F3	D3	M	
	inch	mm	mm	mm	mm	mm	mm	mm	mm	mm	mm	
PM 35	3/8 x 3/16	9.525 x 4.78	5.08	3.59	1.28	9.04	14.68	9.52	18.33	2.78	9.52	1150
PM 40	1/2 x 5/16	12.70 x 7.92	7.92	3.98	1.49	12.06	17.30	12.70	23.10	3.57	12.70	1950
PM 50	5/8 x 3/8	15.875 x 9.52	10.16	5.09	2.01	15.08	24.61	15.88	28.72	5.16	15.88	3200
PM 60	3/4 x 1/2	19.05 x 12.70	11.91	5.96	2.38	18.09	26.11	18.26	36.25	5.16	19.05	4500
PM 80	1 x 5/8	25.4 x 15.88	15.87	7.94	3.18	24.13	34.25	24.61	48.64	6.75	25.40	8000

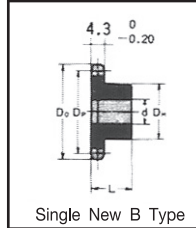
**PITCH 3/8" FOR SPROCKET INDUCTION**

Single New B Type

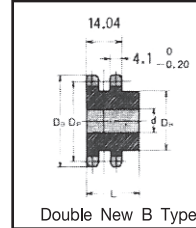

Double New B Type

No. of Teeth	Pitch Dia. Dp	Out-Side Dia. Do	SINGLE B TYPE						DOUBLE-B-TYPE					
			Bore d		Hub		Approx. Weight (kg)	Material	Bore d		Hub		Approx. Weight (kg)	Material
			Stock	Max.	D <sub>H</sub>	L			Stock	Max.	D <sub>H</sub>	L		
PM 10	30.84	35	9	14	20	20	0.07	S45C						
PM 11	33.81	38	9	14	27	20	0.08	S45C						
PM 12	36.80	41	10	16	31	20	0.10	S45C	10	14	26	32	0.18	S45C
PM 13	39.80	44	10	18	32	20	0.11	S45C	10	18	32	32	1.21	S45C
PM 14	42.80	47	10	18	32	20	0.14	S45C	12	20	35	32	0.25	S45C
PM 15	45.82	50	10	20	35	20	0.16	S45C	12	20	35	32	0.28	S45C
PM 16	48.82	53	10	20	37	20	0.19	S45C	12	20	37	32	0.32	S45C
PM 17	51.84	56	12	25	41	20	0.22	S45C	12	25	41	32	0.38	S45C
PM 18	54.84	59	12	25	44	20	0.26	S45C	12	25	44	32	0.44	S45C
PM 19	57.86	62	12	28	47	20	0.29	S45C	12	28	47	32	0.49	S45C
PM 20	60.88	65	12	30	50	20	0.33	S45C	13	30	50	35	0.60	S45C
PM 21	63.91	68	12	32	53	20	0.35	S45C	13	32	53	35	0.67	S45C
PM 22	66.93	71	12	35	56	20	0.39	S45C	13	35	55	35	0.73	S45C
PM 23	69.95	75	12	38	60	20	0.43	S45C	15	35	57	35	0.78	S45C
PM 24	72.97	78	12	32	53	22	0.44	S45C	15	35	57	35	0.83	S45C
PM 25	76.00	81	12	32	53	22	0.46	S45C	15	35	57	35	0.87	S45C
PM 26	79.02	84	12	32	53	22	0.47	S45C	15	35	57	35	0.91	S45C
PM 27	82.04	87	12	32	53	22	0.48	S45C	15	35	57	35	0.98	S45C
PM 28	85.06	90	12	32	53	22	0.49	S45C	15	35	57	35	1.03	S45C
PM 29	88.09	93	12	32	53	22	0.50	S45C						
PM 30	91.13	96	12	32	53	22	0.52	S45C	15	35	57	35	1.07	S45C
PM 31	94.16	99	12	32	53	22	0.54	S45C						
PM 32	97.18	102	12	32	53	22	0.55	S45C	15	35	57	35	1.17	S45C
PM 33	100.20	105	12	32	53	22	0.57	S45C						S45C
PM 34	103.23	108	12	32	53	22	0.59	S45C						S45C
PM 35	106.25	111	12	32	53	22	0.60	S45C	15	35	57	35	1.33	S45C
PM 36	109.30	114	13	32	53	22	0.77	S45C	15	35	57	35	1.38	S45C
PM 37	112.32	117	13	42	63	25	0.79	S45C						
PM 38	115.34	120	13	42	63	25	0.80	S45C	15	35	57	35	1.55	S45C
PM 39	118.36	123	13	42	63	25	0.81	S45C						
PM 40	121.41	126	13	42	63	25	0.84	S45C	19	48	73	40	2.05	S45C
PM 41	124.43	129	16	42	63	25	0.91	S45C						
PM 42	127.46	132	16	42	63	25	0.93	S45C	19	48	73	40	2.18	S45C
PM 43	130.48	135	16	42	63	25	0.95	S45C						
PM 44	133.53	138	16	42	63	25	0.97	S45C						
PM 45	136.55	142	16	42	63	25	1.00	S45C	19	48	73	40	2.38	S45C
PM 48	145.64	151	16	42	63	25	1.07	S45C	19	48	73	40	2.60	S45C
PM 50	151.70	157	16	42	63	25	1.10	S45C	19	48	73	40	2.90	S45C
PM 54	163.81	169	16	42	63	25	1.20	S45C	19	48	73	40	3.07	S45C
PM 55	166.85	172	16	42	63	25	1.25	S45C						
PM 60	182.00	187	16	42	63	25	1.30	S45C	19	48	73	40	3.51	S45C
PM 65	197.15	202	18	45	68	25	1.60	S45C	19	48	73	40	4.10	S45C
PM 70	212.30	217	18	45	68	25	1.80	S45C	19	48	73	40	4.64	S45C
PM 75	227.46	232	18	45	68	25	1.90	S45C						

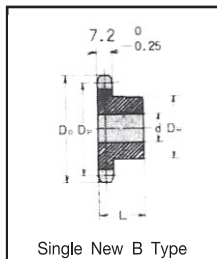
**PITCH 1/2" FOR SPROCKET INDUCTION**

Single New B Type

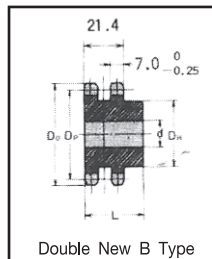

Double New B Type

No. of Teeth	Pitch Dia. Dp	Out-Side Dia. Do	SINGLE B TYPE						DOUBLE - B - TYPE					
			Bore d		Hub		Approx. Weight (kg)	Material	Bore d		Hub		Approx. Weight (kg)	Material
			Stock	Max.	D <sub>H</sub>	L			Stock	Max.	D <sub>H</sub>	L		
PM 10	41.10	46	11	20	32	22	0.17	S45C						
PM 11	45.08	51	11	20	37	22	0.18	S45C						
PM 12	49.07	55	11	22	40	22	0.20	S45C	14	20	35	35	0.33	S45C
PM 13	53.07	59	14	20	37	22	0.25	S45C	14	22	39	35	0.40	S45C
PM 14	57.07	63	14	25	42	22	0.30	S45C	14	25	43	35	0.47	S45C
PM 15	61.08	67	14	28	46	22	0.35	S45C	14	28	47	35	0.56	S45C
PM 16	65.10	71	14	30	50	22	0.40	S45C	14	30	50	35	0.65	S45C
PM 17	69.12	76	14	32	54	22	0.47	S45C	14	32	54	35	0.75	S45C
PM 18	73.14	80	14	35	57	22	0.50	S45C	14	38	59	35	0.87	S45C
PM 19	77.16	84	14	40	62	22	0.58	S45C	14	42	63	35	0.99	S45C
PM 20	81.18	88	15	45	67	25	0.63	S45C	14	45	67	40	1.30	S45C
PM 21	85.21	92	15	48	71	25	0.64	S45C	14	45	68	40	1.40	S45C
PM 22	89.24	96	15	51	75	25	0.65	S45C	14	48	72	40	1.60	S45C
PM 23	93.27	100	15	51	77	25	0.70	S45C	14	51	76	40	1.75	S45C
PM 24	97.30	104	15	42	63	25	0.75	S45C	14	55	80	40	1.90	S45C
PM 25	101.33	108	15	42	63	25	0.78	S45C	18	57	84	40	2.10	S45C
PM 26	105.36	112	15	42	63	25	0.80	S45C	18	60	88	40	2.30	S45C
PM 27	109.40	116	15	42	63	25	0.95	S45C	18	60	92	40	2.40	S45C
PM 28	113.43	120	15	42	63	25	1.00	S45C	18	66	96	40	2.60	S45C
PM 29	117.46	124	15	42	63	25	1.02	S45C						
PM 30	121.50	128	15	42	63	25	1.05	S45C	18	66	100	40	3.00	S45C
PM 31	125.53	133	15	45	68	28	1.20	S45C						
PM 32	129.57	137	15	45	68	28	1.25	S45C	23	66	100	50	3.10	S45C
PM 33	133.61	141	15	45	68	28	1.30	S45C						
PM 34	137.64	145	15	45	68	28	1.35	S45C						
PM 35	141.68	149	15	45	68	28	1.40	S45C	23	66	100	50	3.60	S45C
PM 36	145.72	153	17	45	68	28	1.50	S45C	23	66	100	50	3.70	S45C
PM 37	149.75	157	17	45	68	28	1.55	S45C						
PM 38	153.79	161	17	45	68	28	1.60	S45C	23	66	100	50	4.00	S45C
PM 39	157.83	165	17	45	68	28	1.60	S45C						
PM 40	161.87	169	17	45	68	28	1.70	S45C	23	66	100	50	4.30	S45C
PM 41	165.91	173	18	48	73	32	2.00	S45C						
PM 42	169.95	177	18	48	73	32	2.05	S45C	23	63	93	50	4.60	S45C
PM 43	173.98	181	18	48	73	32	2.10	S45C						
PM 44	178.02	185	18	48	73	32	2.00	S45C						
PM 45	182.06	189	18	48	73	32	2.25	S45C	23	63	93	50	5.50	S45C
PM 48	194.18	201	18	48	73	32	2.45	S45C	23	63	93	50	6.00	S45C
PM 50	202.26	209	18	48	73	32	2.60	S45C	23	63	93	50	6.50	S45C
PM 54	218.42	226	18	48	73	32	2.90	S45C	23	63	93	50	7.40	S45C
PM 60	242.66	250	18	48	73	32	3.40	S45C	23	63	93	50	8.80	S45C
PM 65	262.87	270	20	55	83	32	4.10	S45C	23	63	93	50	10.20	S45C
PM 70	283.07	290	20	55	83	32	4.57	S45C	23	63	93	50	11.50	S45C
PM 72	291.16	299	20	55	83	32	4.80	S45C						
PM 75	303.28	311	20	55	83	32	5.70	S45C						

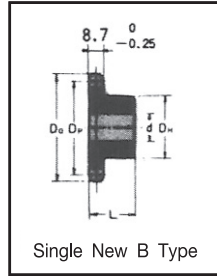
**PITCH 5/8" FOR SPROCKET INDUCTION**

Single New B Type

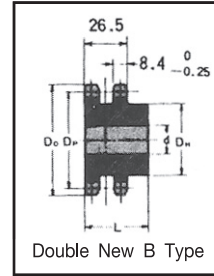

Double New B Type

No. of Teeth	Pitch Dia. D <sub>p</sub>	Out-Side Dia. D <sub>o</sub>	SINGLE B TYPE						DOUBLE-B-TYPE					
			Bore d		Hub		Approx. Weight (kg)	Material	Bore d		Hub		Approx. Weight (kg)	Material
			Stock	Max.	D <sub>H</sub>	L			Stock	Max.	D <sub>H</sub>	L		
PM 10	51.38	58	15	22	40	25	0.30	S45C						
PM 11	56.35	64	15	22	46	25	0.32	S45C						
PM 12	61.34	69	15	28	51	25	0.40	S45C	14	25	42	40	0.61	S45C
PM 13	66.34	74	15	31	51	25	0.48	S45C	14	30	49	40	0.74	S45C
PM 14	71.34	79	15	32	52	25	0.50	S45C	14	32	54	40	0.89	S45C
PM 15	76.35	84	15	35	57	25	0.63	S45C	14	38	59	40	1.90	S45C
PM 16	81.37	89	15	39	62	25	0.75	S45C	14	42	64	45	1.31	S45C
PM 17	86.39	94	15	43	67	25	0.80	S45C	14	45	68	45	1.51	S45C
PM 18	91.42	100	15	43	72	28	0.93	S45C	14	48	74	45	1.81	S45C
PM 19	96.45	105	15	43	73	28	1.00	S45C	14	55	79	45	2.00	S45C
PM 20	101.48	110	15	45	73	28	1.10	S45C	18	55	84	45	2.20	S45C
PM 21	106.51	115	15	45	73	28	1.15	S45C	18	60	89	45	2.50	S45C
PM 22	111.55	120	17	45	73	28	1.23	S45C	18	64	94	50	3.00	S45C
PM 23	116.58	125	17	45	73	28	1.30	S45C	18	66	99	50	3.30	S45C
PM 24	121.62	130	17	45	73	28	1.35	S45C	18	70	105	50	3.65	S45C
PM 25	126.66	135	17	45	73	28	1.40	S45C	18	70	105	50	3.67	S45C
PM 26	131.70	140	17	45	73	28	1.50	S45C	18	70	105	50	3.70	S45C
PM 27	136.74	145	17	45	73	28	1.55	S45C	18	70	105	50	3.90	S45C
PM 28	141.79	150	17	45	73	28	1.60	S45C	18	75	110	50	4.10	S45C
PM 29	146.83	155	17	45	73	28	1.70	S45C						
PM 30	151.87	161	17	45	73	28	1.80	S45C	18	80	120	50	4.60	S45C
PM 31	156.92	166	17	45	73	28	1.85	S45C						
PM 32	161.96	171	17	45	73	28	1.95	S45C	23	80	120	50	5.00	S45C
PM 33	167.01	176	17	45	73	28	2.05	S45C						
PM 34	172.05	181	17	45	73	28	2.15	S45C						
PM 35	177.10	186	17	45	73	28	2.20	S45C	23	80	117	50	5.80	S45C
PM 36	182.14	191	20	55	83	35	2.85	S45C	23	80	117	50	6.00	S45C
PM 37	187.19	196	20	55	83	35	2.95	S45C						
PM 38	192.24	201	20	55	83	35	3.05	S45C	23	80	117	50	6.70	S45C
PM 39	197.29	206	20	55	83	35	3.15	S45C						
PM 40	202.33	211	20	55	83	35	3.25	S45C	23	80	117	56	6.20	S45C
PM 41	207.38	216	20	55	83	35	3.40	S45C						
PM 42	212.43	221	20	55	83	35	3.50	S45C	23	66	98	56	8.40	S45C
PM 43	217.48	226	20	55	83	35	3.60	S45C						
PM 44	222.53	231	20	55	83	35	3.70	S45C						
PM 45	227.58	237	20	55	83	35	3.85	S45C	23	66	98	56	9.50	S45C
PM 48	242.73	252	20	55	83	35	4.20	S45C	23	66	98	56	10.60	S45C
PM 50	252.83	262	20	55	83	35	4.50	S45C	23	66	98	56	11.40	S45C
PM 54	273.02	282	20	55	83	35	3.10	S45C	23	66	98	63	13.50	S45C
PM 60	303.33	312	20	55	83	35	6.00	S45C	23	66	98	63	16.30	S45C
PM 65	328.58	338	23	63	93	40	7.40	S45C	23	66	98	63	18.80	S45C
PM 70	353.84	363	23	63	93	40	8.30	S45C	23	66	98	63	21.60	S45C
PM 72	363.94	373	23	63	93	40	8.70	S45C						
PM 75	379.10	388	23	63	93	40	9.35	S45C						

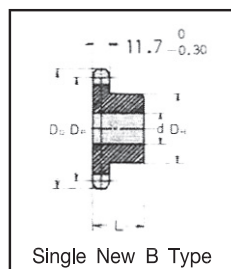
**PITCH 3/4" FOR SPROCKET INDUCTION**

Single New B Type

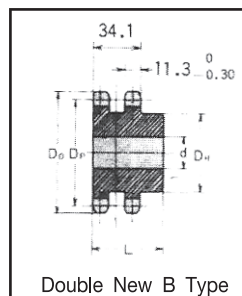

Double New B Type

No. of Teeth	Pitch Dia. Dp	Out-Side Dia. Do	SINGLE B TYPE						DOUBLE-B-TYPE					
			Bore d		Hub		Approx. Weight (kg)	Material	Bore d		Hub		Approx. Weight (kg)	Material
			Stock	Max.	D <sub>H</sub>	L			Stock	Max.	D <sub>H</sub>	L		
PM 10	61.65	70	15	32	49	32	0.55	S45C						
PM 11	67.62	76	15	32	51	32	0.60	S45C						
PM 12	73.60	83	15	32	51	32	0.70	S45C	16	30	50	50	1.10	S45C
PM 13	79.60	89	15	35	57	32	0.80	S45C	18	38	60	50	1.30	S45C
PM 14	85.61	95	17	40	62	32	0.90	S45C	18	45	66	56	1.70	S45C
PM 15	91.62	101	17	45	68	32	1.00	S45C	18	48	72	56	2.10	S45C
PM 16	97.65	107	17	48	73	32	1.25	S45C	18	51	78	56	2.40	S45C
PM 17	103.67	113	17	48	73	32	1.60	S45C	18	55	82	56	2.80	S45C
PM 18	109.71	119	17	55	83	40	1.70	S45C	18	60	90	56	3.10	S45C
PM 19	115.74	126	17	55	83	40	1.80	S45C	18	63	94	56	3.60	S45C
PM 20	121.78	132	17	55	83	40	2.15	S45C	23	66	100	56	4.00	S45C
PM 21	127.82	138	17	55	83	40	2.25	S45C	23	66	100	56	4.50	S45C
PM 22	133.86	144	17	55	83	40	2.38	S45C	23	66	100	56	5.00	S45C
PM 23	139.90	150	17	55	83	40	2.50	S45C	23	66	100	56	4.80	S45C
PM 24	145.95	156	17	55	83	40	2.60	S45C	23	80	120	56	5.10	S45C
PM 25	151.99	162	17	55	83	40	2.75	S45C	23	80	120	56	5.50	S45C
PM 26	158.04	168	17	55	83	40	2.88	S45C	23	80	120	56	5.80	S45C
PM 27	164.09	174	21	55	83	40	3.00	S45C	23	80	120	56	6.20	S45C
PM 28	170.14	180	21	55	83	40	3.17	S45C	23	80	120	56	6.70	S45C
PM 29	176.20	187	21	55	83	40	3.30	S45C						
PM 30	182.25	193	21	55	83	40	3.45	S45C	28	89	130	56	7.50	S45C
PM 31	188.30	199	21	55	83	40	3.64	S45C						
PM 32	194.35	205	21	55	83	40	3.80	S45C	28	89	127	56	8.40	S45C
PM 33	200.41	211	21	55	83	40	4.00	S45C						
PM 34	206.46	217	21	55	83	40	4.15	S45C						
PM 35	212.52	223	21	55	83	40	4.33	S45C	28	89	127	56	9.90	S45C
PM 36	218.57	229	21	55	83	40	4.52	S45C	28	66	98	56	10.40	S45C
PM 37	224.63	235	21	55	83	40	4.70	S45C						
PM 38	230.69	241	21	55	83	40	4.90	S45C	28	66	98	56	11.50	S45C
PM 39	236.74	247	21	55	83	45	5.10	S45C						
PM 40	242.80	253	21	55	83	45	5.30	S45C	28	66	98	56	12.60	S45C
PM 41	248.86	260	23	63	93	45	6.00	S45C						
PM 42	254.92	266	23	63	93	45	6.40	S45C	28	75	107	56	13.90	S45C
PM 43	260.98	272	23	63	93	45	6.60	S45C						
PM 44	267.03	278	23	63	93	45	6.88	S45C						
PM 45	273.09	284	23	63	93	45	7.10	S45C	28	75	107	71	17.00	S45C
PM 48	291.27	302	23	63	93	45	7.85	S45C	28	75	107	71	19.10	S45C
PM 50	303.39	314	23	63	93	45	8.40	S45C	28	75	107	71	20.60	S45C
PM 54	327.63	338	23	63	93	45	9.50	S45C	28	75	107	71	23.80	S45C
PM 60	363.99	375	23	63	93	45	11.30	S45C	28	75	107	71	29.00	S45C
PM 65	394.30	405	26	75	107	45	13.50	S45C	28	75	107	71	33.70	S45C
PM 70	424.61	436	26	75	107	45	15.30	S45C	28	75	107	71	38.80	S45C
PM 72	436.73	448	26	75	107	45	16.00	S45C						
PM 75	454.92	466	26	75	107	45	17.20	S45C						

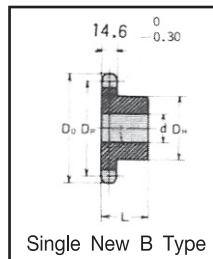

**PITCH 1" FOR SPROCKET INDUCTION**

Single New B Type

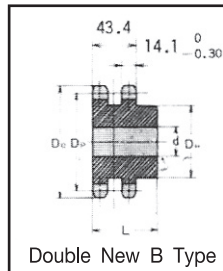

Double New B Type

No. of Teeth	Pitch Dia. Dp	Out-Side Dia. Do	SINGLE B TYPE						DOUBLE-B-TYPE					
			Bore d		Hub		Approx. Weight (kg)	Material	Bore d		Hub		Approx. Weight (kg)	Material
			Stock	Max.	D <sub>H</sub>	L			Stock	Max.	D <sub>H</sub>	L		
PM 10	82.19	93	17	38	55	40	1.10	S45C						
PM 11	90.15	102	17	38	60	40	1.25	S45C						
PM 12	98.14	110	21	45	67	40	1.60	S45C	23	46	69	63	2.50	S45C
PM 13	106.14	118	21	51	77	40	1.90	S45C	23	55	80	63	3.10	S45C
PM 14	114.15	127	21	51	77	40	2.15	S45C	23	60	88	63	3.60	S45C
PM 15	122.17	135	21	63	93	40	2.30	S45C	23	63	95	63	4.20	S45C
PM 16	130.20	143	21	63	93	40	2.50	S45C	23	66	100	71	5.50	S45C
PM 17	138.23	151	21	63	93	40	2.95	S45C	23	66	100	71	6.30	S45C
PM 18	146.27	159	21	63	93	40	3.15	S45C	23	80	120	71	6.40	S45C
PM 19	154.32	167	22	63	93	40	3.40	S45C	23	80	120	71	7.00	S45C
PM 20	162.37	176	22	63	93	40	3.60	S45C	23	89	130	71	7.60	S45C
PM 21	170.42	184	22	63	93	40	3.85	S45C	23	89	130	71	8.30	S45C
PM 22	178.48	192	26	75	107	45	5.00	S45C	33	80	117	71	10.10	S45C
PM 23	186.54	200	26	75	107	45	5.23	S45C	33	80	117	71	10.90	S45C
PM 24	194.60	208	26	75	107	45	5.50	S45C	33	80	117	80	11.60	S45C
PM 25	202.66	216	26	75	107	45	5.80	S45C	33	80	117	80	12.50	S45C
PM 26	210.72	224	26	75	107	45	6.10	S45C	33	80	117	80	13.30	S45C
PM 27	218.79	233	26	75	107	45	6.40	S45C	33	80	117	80	14.20	S45C
PM 28	226.86	241	26	75	107	45	6.75	S45C	33	80	117	80	15.00	S45C
PM 29	234.93	249	26	75	107	45	7.10	S45C						
PM 30	243.00	257	26	75	107	45	7.40	S45C	33	80	117	80	17.00	S45C
PM 31	251.07	265	26	75	107	45	7.80	S45C						
PM 32	259.14	273	26	75	107	45	8.15	S45C	33	80	117	80	19.10	S45C
PM 33	267.21	281	26	75	107	45	8.50	S45C						
PM 34	275.29	289	26	75	107	45	8.90	S45C						
PM 35	283.36	297	26	75	107	45	9.30	S45C	33	80	117	80	22.50	S45C
PM 36	291.43	306	30	80	117	50	10.60	S45C	33	80	117	80	23.70	S45C
PM 37	299.51	314	30	80	117	50	11.00	S45C						
PM 38	307.58	322	30	80	117	50	11.40	S45C	38	89	127	80	26.20	S45C
PM 39	315.66	330	30	80	117	50	11.90	S45C						
PM 40	323.74	338	30	80	117	50	12.40	S45C	38	89	127	90	30.00	S45C
PM 41	331.81	346	30	80	117	50	12.80	S45C						
PM 42	339.89	354	30	80	117	50	13.30	S45C	38	89	127	90	32.90	S45C
PM 43	347.97	362	30	80	117	50	13.80	S45C						
PM 44	356.04	370	30	80	117	50	14.30	S45C						
PM 45	364.12	378	30	80	117	50	14.90	S45C	38	89	127	90	37.30	S45C
PM 48	388.36	403	30	80	117	50	16.50	S45C	38	89	127	90	42.00	S45C
PM 50	404.52	419	30	80	117	50	17.65	S45C	38	89	127	90	45.30	S45C
PM 54	436.84	451	30	80	117	50	20.00	S45C	38	89	127	90	52.40	S45C
PM 60	485.33	500	30	80	117	50	24.10	S45C	38	89	127	90	64.00	S45C
PM 65	525.73	540	38	89	127	63	28.80	S45C	38	89	127	90	74.90	S45C
PM 70	566.15	581	38	89	127	63	32.80	S45C	38	89	127	90	86.40	S45C
PM 72	582.31	597	38	89	127	63	34.50	S45C						
PM 75	606.56	621	38	89	127	63	37.10	S45C						



**PITCH 1.1/4" FOR SPROCKET INDUCTION**

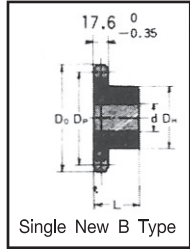

Single New B Type

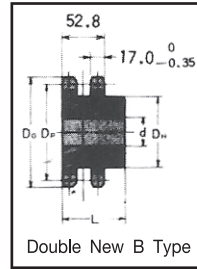

Double New B Type

No. of Teeth	Pitch Dia. Dp	Out-Side Dia. Do	SINGLE B TYPE						DOUBLE-B-TYPE					
			Bore d		Hub		Approx. Weight (kg)	Material	Bore d		Hub		Approx. Weight (kg)	Material
			Stock	Max.	D <sub>H</sub>	L			Stock	Max.	D <sub>H</sub>	L		
PM 10	102.74	116	22	51	65	50	2.30	S45C						
PM 11	112.70	127	22	51	75	50	2.40	S45C						
PM 12	122.67	138	22	57	86	50	2.90	S45C	28	60	90	80	5.00	S45C
PM 13	132.67	148	22	63	94	50	3.10	S45C	28	66	100	80	6.00	S45C
PM 14	142.68	158	22	66	98	50	3.60	S45C	28	75	110	80	7.30	S45C
PM 15	152.71	168	22	66	98	50	4.20	S45C	28	80	120	80	7.60	S45C
PM 16	162.74	179	22	66	98	50	4.60	S45C	28	89	130	80	8.60	S45C
PM 17	172.79	189	22	75	107	50	5.30	S45C	28	89	130	80	9.90	S45C
PM 18	182.84	199	22	75	107	50	5.70	S45C	28	89	130	80	11.00	S45C
PM 19	192.90	209	26	75	107	50	6.10	S45C	28	89	130	90	13.90	S45C
PM 20	202.96	220	26	75	107	50	6.50	S45C	28	89	130	90	15.00	S45C
PM 21	213.03	230	26	75	107	50	7.00	S45C	28	89	130	90	16.30	S45C
PM 22	223.10	240	30	80	117	56	7.90	S45C	28	89	127	90	17.60	S45C
PM 23	233.17	250	30	80	117	56	8.50	S45C	28	89	127	90	19.00	S45C
PM 24	243.25	260	30	80	117	56	8.80	S45C	38	95	137	90	20.70	S45C
PM 25	253.32	270	30	80	117	56	9.30	S45C	38	95	137	90	22.30	S45C
PM 26	263.40	281	30	80	117	56	9.80	S45C	38	95	137	90	24.00	S45C
PM 27	273.49	291	30	80	117	56	10.30	S45C	38	95	137	90	25.50	S45C
PM 28	283.57	301	30	80	117	56	10.90	S45C	38	95	137	90	27.30	S45C
PM 29	293.66	311	30	80	117	56	11.50	S45C						
PM 30	303.75	321	30	80	117	56	12.10	S45C	38	95	137	90	31.00	S45C
PM 31	313.83	331	35	80	117	56	13.00	S45C						
PM 32	323.92	341	35	80	117	56	13.40	S45C	38	95	137	90	35.00	S45C
PM 33	334.01	352	35	80	117	56	14.50	S45C						
PM 34	344.11	362	35	80	117	56	16.10	S45C						
PM 35	354.20	372	35	89	127	63	16.60	S45C	38	95	137	90	41.40	S45C
PM 36	364.29	382	35	89	127	63	17.50	S45C	38	95	137	90	43.60	S45C
PM 37	374.38	392	35	89	127	63	18.00	S45C						
PM 38	384.48	402	35	89	127	63	18.90	S45C	38	95	137	90	48.30	S45C
PM 39	394.57	412	35	89	127	63	20.00	S45C						
PM 40	404.67	422	35	89	127	63	20.40	S45C	38	103	147	100	55.30	S45C
PM 41	414.77	433	35	89	127	63	21.50	S45C						
PM 42	424.86	443	35	89	127	63	22.60	S45C	38	103	147	100	60.60	S45C
PM 43	434.96	453	35	89	127	63	23.50	S45C						
PM 44	445.06	463	35	89	127	63	24.00	S45C						
PM 45	455.16	473	35	89	127	63	24.70	S45C	38	103	147	100	69.00	S45C
PM 48	485.45	503	35	89	127	63	27.50	S45C	38	103	147	100	78.00	S45C
PM 50	505.65	524	38	89	127	63	30.00	S45C						
PM 54	546.05	564	38	103	147	80	37.40	S45C	38	103	147	100	97.80	S45C
PM 60	606.66	625	38	103	147	80	44.30	S45C	*38	103	147	125	123.00	S45C
PM 65	657.17	675	38	103	147	80	53.00	S45C						
PM 70	707.68	726	*38	103	147	100	63.00	S45C						
PM 72	727.89	746	*38	103	147	100	66.00	S45C						
PM 75	758.20	777	*38	103	147	100	70.00	S45C						

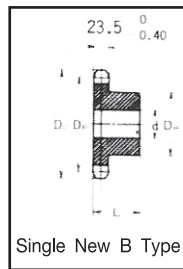
**PITCH 1.1/2" FOR SPROCKET INDUCTION**

Single New B Type

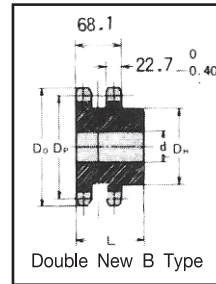

Double New B Type

No. of Teeth	Pitch Dia. Dp	Out-Side Dia. Do	SINGLE B TYPE						DOUBLE-B-TYPE					
			Bore d		Hub		Approx. Weight (kg)	Material	Bore d		Hub		Approx. Weight (kg)	Material
			Stock	Max.	D <sub>H</sub>	L			Stock	Max.	D <sub>H</sub>	L		
PM 10	123.29	140	26	60	80	56	3.80	S45C						
PM 11	135.24	153	26	60	91	56	4.00	S45C						
PM 12	147.21	165	26	66	98	56	4.80	S45C	28	66	100	100	9.10	S45C
PM 13	159.20	177	26	66	98	56	5.30	S45C	28	75	115	100	11.00	S45C
PM 14	171.22	190	26	75	107	56	6.30	S45C	28	80	120	100	12.20	S45C
PM 15	183.25	202	30	80	117	63	7.80	S45C	38	80	120	100	13.90	S45C
PM 16	195.29	214	30	80	117	63	8.40	S45C	38	95	140	100	15.60	S45C
PM 17	207.35	227	30	80	117	63	9.10	S45C	38	95	140	100	17.50	S45C
PM 18	219.41	239	30	80	117	63	9.90	S45C	38	103	150	100	20.00	S45C
PM 19	231.48	251	30	80	117	63	10.70	S45C	38	103	150	100	22.00	S45C
PM 20	243.55	263	30	89	117	63	12.10	S45C	38	103	150	100	24.40	S45C
PM 21	255.63	276	35	89	127	63	13.00	S45C	38	103	150	100	26.70	S45C
PM 22	267.72	288	35	89	127	63	13.40	S45C	38	103	147	100	30.00	S45C
PM 23	279.80	300	35	89	127	63	14.50	S45C	38	103	147	100	33.00	S45C
PM 24	291.90	312	35	89	127	63	15.20	S45C	38	110	157	100	36.20	S45C
PM 25	303.99	324	35	89	127	63	16.20	S45C	38	110	157	100	39.20	S45C
PM 26	316.09	337	35	89	127	63	17.20	S45C	38	110	157	100	42.10	S45C
PM 27	328.19	349	35	89	127	63	19.00	S45C	38	110	157	100	45.30	S45C
PM 28	340.29	361	38	95	137	71	20.90	S45C	38	110	157	100	48.50	S45C
PM 30	364.50	385	38	95	137	71	23.20	S45C	38	110	157	100	55.30	S45C
PM 32	388.71	410	38	95	137	71	25.70	S45C	38	110	157	100	62.70	S45C
PM 35	425.04	446	38	95	137	71	29.70	S45C	38	110	157	100	74.70	S45C
PM 36	437.15	458	38	95	137	71	32.00	S45C	*38	110	157	100	78.90	S45C
PM 38	461.38	483	38	95	137	71	35.00	S45C	*38	110	157	100	87.70	S45C
PM 40	485.60	507	38	103	147	80	38.20	S45C	*43	125	177	140	105.00	S45C
PM 42	509.84	531	38	103	147	80	42.00	S45C	*43	125	177	140	115.00	S45C
PM 45	546.19	568	38	103	147	80	47.60	S45C	*43	125	177	140	130.00	S45C
PM 48	582.54	604	38	103	147	80	53.00	S45C	*43	125	177	140	148.00	S45C
PM 50	606.78	628	38	103	147	80	58.00	S45C	*43	125	177	140	160.00	S45C
PM 54	655.26	677	*38	103	147	100	70.00	S45C	*43	125	177	140	185.00	S45C
PM 60	727.99	750	*38	118	167	100	88.00	S45C	*43	125	177	160	230.00	S45C
PM 65	788.60	811	*38	118	167	100	100.00	S45C						
PM 70	849.22	871	*38	118	167	112	117.00	S45C						
PM 75	909.84	932	*38	118	167	112	130.00	S45C						

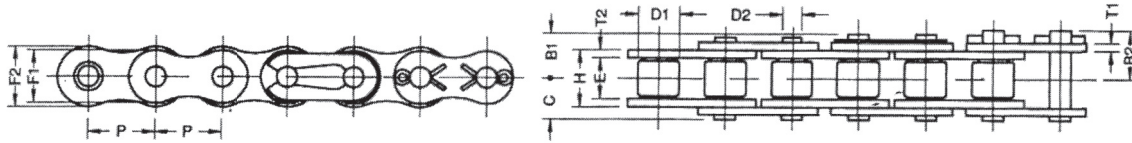

ISO Chain No.	Pitch x Width		Roller	Pin				Links					Avg. Ulti Tensile Strength	Approx. Weight				
	P	x		E	D1	C	B1	B2	D2	T1	T2	H			F1	F2		
	inch			mm	mm	mm	mm	mm	mm	mm	mm	mm			mm	mm	kgf	kg/m
PM 25SS	1/4	x	1/8	6.35	x	3.18	3.30	3.89	4.80	-	2.32	0.76	0.76	4.80	5.01	5.81	240	0.13
PM 35SS	3/8	x	3/16	9.525	x	4.78	5.08	5.81	7.01	7.66	3.59	1.28	1.28	7.46	7.80	9.04	770	0.32
PM 40SS	1/2	x	5/16	12.70	x	7.92	7.92	8.16	9.36	10.56	3.98	1.49	1.49	11.17	10.41	12.06	1200	0.62
PM 41SS	1/2	x	1/4	12.70	x	6.35	7.77	6.64	7.98	8.43	3.59	1.28	1.28	9.06	8.50	9.90	700	0.41
PM 50SS	5/8	x	3/8	15.875	x	9.52	10.16	10.15	11.55	12.32	5.09	2.01	2.01	13.84	13.01	15.08	2000	1.01
PM 60SS	3/4	x	1/2	19.05	x	12.70	11.91	12.63	14.00	15.43	5.96	2.38	2.38	17.75	15.64	18.09	2850	1.45
PM 80SS	1	x	5/8	25.4	x	15.88	15.87	16.38	18.38	20.05	7.94	3.18	3.18	22.60	20.82	24.13	5200	2.55
PM 100SS	1 1/4	x	3/4	31.75	x	19.05	19.05	20.04	-	23.90	9.54	3.99	3.99	27.45	26.03	30.16	6000	3.95

ANSI Chain No.	Pitch x Width		Roller	Pin				Links					Avg. Ulti Tensile Strength	Approx. Weight				
	P	x		E	D1	C	B1	B2	D2	T1	T2	H			F1	F2		
	inch			mm	mm	mm	mm	mm	mm	mm	mm	mm			mm	mm	kgf	kg/m
PM 05BSS	0.315	x	0.118	8	x	3	5.00	3.87	4.82	-	2.31	0.78	0.78	4.77	7.10	7.10	300	0.164
PM 06BSS	3/8	x	7/32	9.525	x	5.72	6.35	6.43	7.39	8.14	3.28	1.28	1.28	8.53	8.20	8.20	650	0.41
PM 08BSS	1/2	x	5/16	12.7	x	7.75	8.51	8.17	9.17	10.57	4.45	1.49	1.58	11.30	10.92	11.80	1000	0.66
PM 10BSS	5/8	x	3/8	15.875	x	9.65	10.16	9.78	11.18	12.17	5.08	1.71	1.71	13.28	13.72	14.70	1450	0.92
PM 12BSS	3/4	x	7/16	19.05	x	11.68	12.07	11.18	12.28	14.48	5.72	1.86	1.86	15.62	16.10	16.10	1700	1.21
PM 16BSS	1	x	0.67	25.40	x	17.02	15.88	17.82	20.79	21.69	8.28	3.18	3.99	25.45	21.00	21.00	4800	2.66

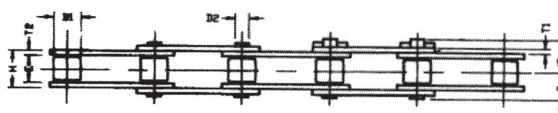
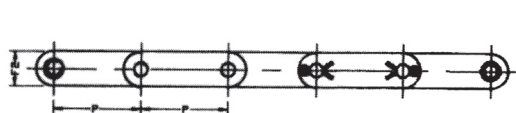

STAN-  
DARD  
ROLLERS

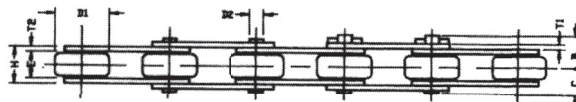
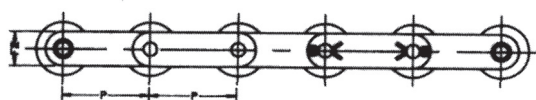

LARGE  
ROLLERS

ISO Chain No.	Pitch x Width		Roller	Pin			Links				Avg. Ulti Tensile Strength kgf	Approx. Weight kg/m
	P	x E		D1	C	B	D2	T1	T2	H		
	inch	mm	mm	mm	mm	mm	mm	mm	mm	mm		
PM 2040SS	1 x 5/16	25.4 x 7.92	7.92	8.16	10.56	3.98	1.49	1.49	11.17	12.06	1250	0.472
PM 2050SS	1 <sup>1</sup> / <sub>4</sub> x 3/8	31.75 x 9.52	10.16	10.15	12.32	5.09	2.01	2.01	13.84	15.08	2250	0.804
PM 2060SS	1 <sup>1</sup> / <sub>2</sub> x 1/2	38.10 x 12.70	11.91	12.63	15.43	5.96	2.38	2.38	17.75	18.09	2800	1.13
PM 2080SS	2 x 5/8	50.8 x 15.88	15.87	16.38	19.73	7.94	3.18	3.18	22.60	24.13	4800	2.08
PM 2042SS	1 x 5/16	25.4 x 7.92	15.88	8.16	10.56	3.98	1.49	1.49	11.17	12.06	1800	0.827
PM 2052SS	1 <sup>1</sup> / <sub>4</sub> x 3/8	31.75 x 9.52	19.05	10.15	12.32	5.09	2.01	2.01	13.84	15.08	2250	1.27
PM 2062SS	1 <sup>1</sup> / <sub>2</sub> x 1/2	38.10 x 12.70	22.22	12.63	15.43	5.96	2.38	2.38	17.75	18.09	2800	1.85
PM 2082SS	2 x 5/8	50.8 x 15.88	28.58	16.38	19.73	7.94	3.18	3.18	22.60	24.13	4800	3.14

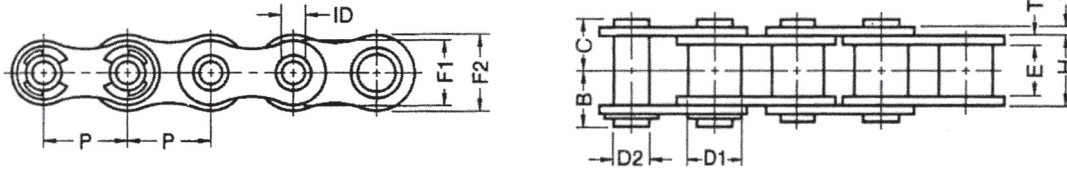

ANSI Chain No.	Pitch x Width		Roller D1 mm	Pin				Links				Avg. Ulti Tensile Strength kgf	Approx. Weight kg/m	
	P	x		E	C	B	ID	D2	T	H	F1			F2
	inch			mm	mm	mm	mm	mm	mm	mm	mm			mm
PM 40HP	1/2	x	5/16	7.92	8.29	8.97	4.0	5.71	1.49	11.17	10.41	12.06	1300	0.52
PM 50HP	5/8	x	3/8	10.16	10.25	10.84	5.12	7.29	2.01	13.84	13.01	15.08	2100	0.82
PM 60HP	3/4	x	1/2	11.91	12.90	13.92	5.98	8.42	2.38	17.75	15.64	18.09	2700	1.00
PM 80HP	1	x	5/8	15.87	16.64	17.59	8.08	11.42	3.18	22.60	20.82	24.13	5200	2.10

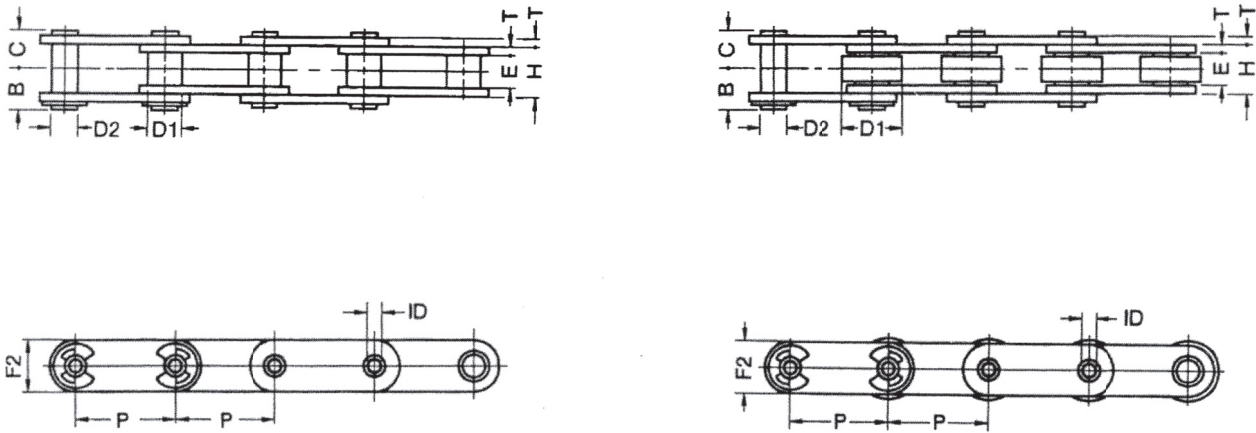

ANSI Chain No.	Pitch x Width		Roller D1 mm	Pin				Links			Avg. Ulti Tensile Strength kgf	Approx. Weight kg/m	
	P	x		E	C	B	ID	D2	T	H			F2
	inch			mm	mm	mm	mm	mm	mm	mm			mm
PM C2040HP	1	x	5/16	7.92	8.29	8.97	4.10	5.71	1.49	11.17	12.06	1300	0.42
PM C2050HP	1 1/4	x	3/8	10.16	10.25	10.84	5.12	7.29	2.01	13.84	15.08	2100	0.72
PM C2060HP	1 1/2	x	1/2	11.91	12.90	13.92	5.98	8.42	2.38	17.75	18.09	2700	1.01
PM C2080HP	2	x	5/8	15.87	16.64	17.59	8.08	11.42	3.18	22.60	24.13	5200	2.54
PM C2042HP	1	x	5/16	15.88	8.29	8.97	4.0	5.71	1.49	11.17	12.06	1300	0.83
PM C2052HP	1 1/4	x	3/8	19.05	10.25	10.84	5.12	7.29	2.01	13.84	15.08	2100	1.28
PM C2062HP	1 1/2	x	1/2	22.22	12.90	13.92	5.98	8.42	2.38	17.75	18.09	2700	1.85
PM C2082HP	2	x	5/8	28.58	16.64	17.59	8.08	11.42	3.18	22.60	24.13	5200	3.58



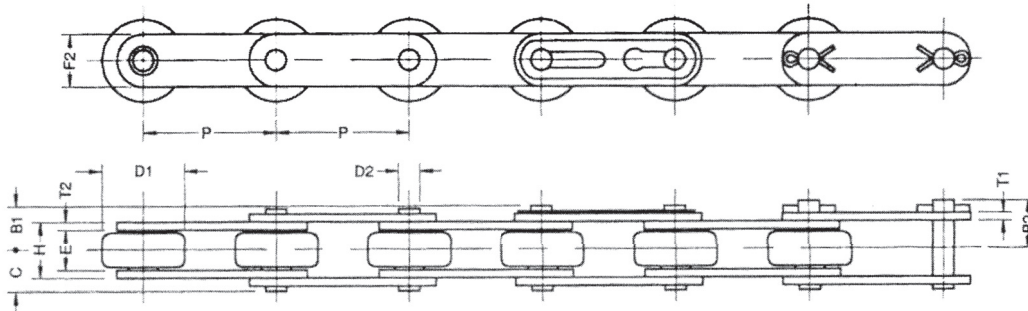
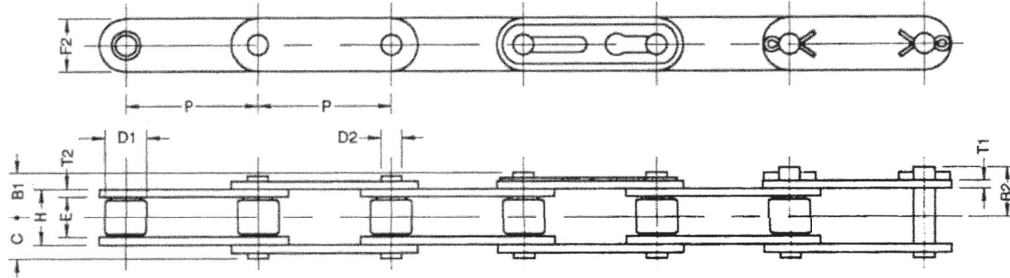

ANSI Chain No.	Pitch x Width		Roller D1 mm	Pin				Links				Avg. Ulti Tensile Strength kgf	Approx. Weight kg/m
	P	x E		C	B1	B2	D2	T1	T2	H	F2		
	inch	mm		mm	mm	mm	mm	mm	mm	mm	mm		
PM C2040	1 x 5/16	25.4 x 7.92	7.92	8.16	9.36	10.56	3.98	1.49	1.49	11.17	12.06	1800	0.472
PM C2050	1 1/4 x 3/8	31.75 x 9.52	10.16	10.15	11.55	12.32	5.09	2.01	2.01	13.84	15.08	3000	0.804
PM C2060	1 1/2 x 1/2	38.1 x 12.70	11.91	12.63	14.00	15.43	5.96	2.38	2.38	17.75	18.09	4200	1.13
PM C2080H	2 x 5/8	50.8 x 15.88	15.87	18.28	-	22.18	7.94	3.99	3.99	24.28	24.13	9000	2.38
PM C2100H	2 1/2 x 3/4	63.5 x 19.05	19.05	21.45	-	25.44	9.54	4.80	4.80	29.10	30.16	14000	3.66
PM C2120H	3 x 1	76.2 x 25.40	22.22	27.06	-	31.96	11.11	5.57	5.57	37.18	36.19	16500	5.18
PM C2160H	4 x 1 1/4	101.6 x 31.75	28.57	34.00	-	39.00	14.29	7.15	7.15	46.88	48.26	31500	8.55

ANSI Chain No.	Pitch x Width		Roller D1 mm	Pin				Links				Avg. Ulti Tensile Strength kgf	Approx. Weight kg/m
	P	x E		C	B1	B2	D2	T1	T2	H	F2		
	inch	mm		mm	mm	mm	mm	mm	mm	mm	mm		
PM C2042	1 x 5/16	25.4 x 7.92	15.88	8.16	9.36	10.56	3.98	1.49	1.49	11.17	12.06	1800	0.827
PM C2052	1 1/4 x 3/8	31.75 x 9.52	19.05	10.15	11.55	12.32	5.09	2.01	2.01	13.84	15.08	3000	1.270
PM C2062	1 1/2 x 1/2	38.1 x 12.70	22.22	12.63	14.00	15.43	5.96	2.38	2.38	17.75	18.09	4200	1.85
PM C2082H	2 x 5/8	50.8 x 15.88	28.58	18.28	-	22.18	7.94	3.99	3.99	24.28	24.13	9000	3.44
PM C2102H	2 1/2 x 3/4	63.5 x 19.05	39.67	21.45	-	25.44	9.54	4.80	4.80	29.10	30.16	14000	5.88
PM C2122H	3 x 1	76.2 x 25.40	44.45	27.06	-	31.96	11.11	5.57	5.57	37.18	36.19	16500	8.09
PM C2162H	4 x 1 1/4	101.6 x 31.75	57.15	34.00	-	39.00	14.29	7.15	7.15	46.88	48.26	31500	13.08
CA 550	1.630 x 0.780	41.40 x 19.81	16.86	17.58	-	21.08	7.19	2.75	-	25.91	20.17	5500	1.87
CA 555	1.630 x 1/2	41.40 x 12.70	16.86	15.05	-	18.60	7.19	3.18	-	19.10	20.17	5700	1.78
CA 557	1.630 x 3/4	41.40 x 19.05	17.75	19.00	-	22.60	7.99	3.18	-	26.05	22.30	6200	2.37



## STANDARD ROLLERS

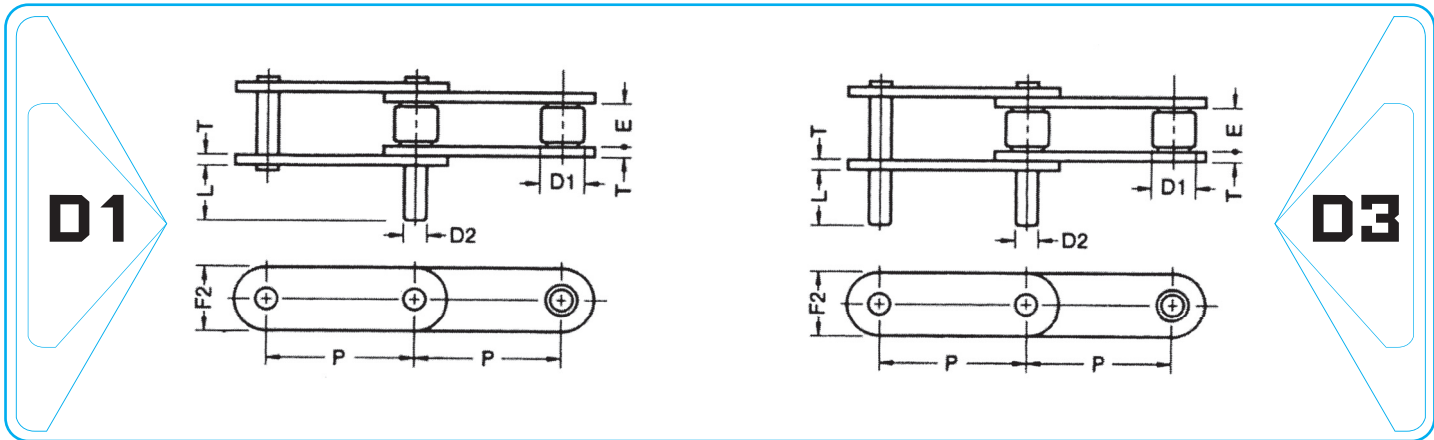

ISO Chain No.	Pitch x Width		Roller	Pin			Links		Avg. Ulti Tensile Strength kgf
	P	x E		D1	D2	L	T	F2	
	inch	mm	mm	mm	mm	mm	mm	mm	
PM 2040	1 x 5/16	25.4 x 7.92	7.92	3.98	9.52	1.49	12.06	1800	
PM 2050	1¼ x 3/8	31.75 x 9.52	10.16	5.09	11.91	2.01	15.08	3000	

## LARGE ROLLERS

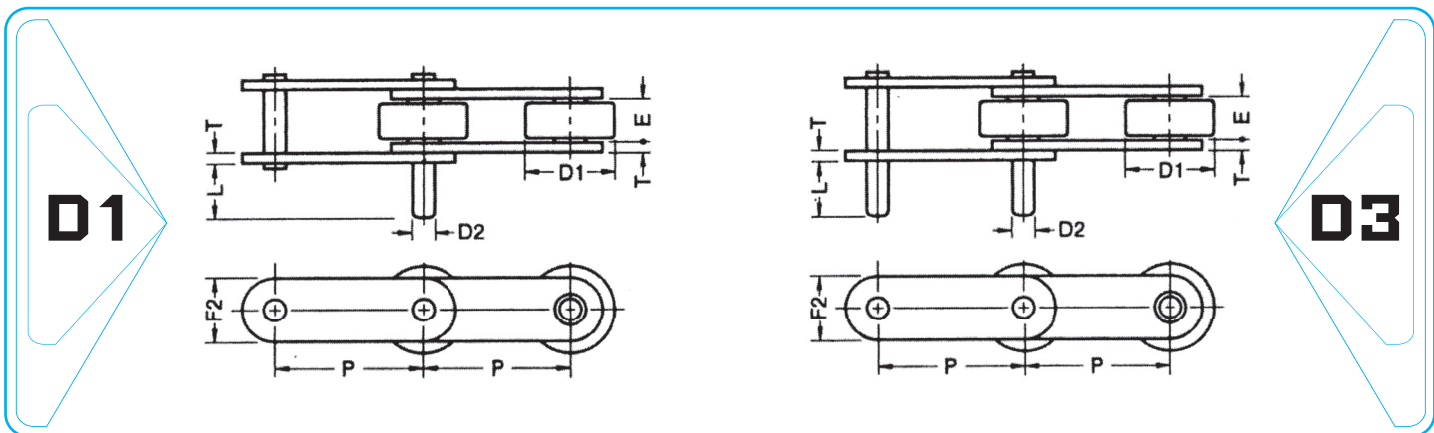

ISO Chain No.	Pitch x Width		Roller	Pin			Links		Avg. Ulti Tensile Strength kgf
	P	x E		D1	D2	L	T	F2	
	inch	mm	mm	mm	mm	mm	mm	mm	
PM 2042	1 x 5/16	25.4 x 7.92	15.88	3.98	9.52	1.49	12.06	1800	
PM 2052	1¼ x 3/8	31.75 x 9.52	19.05	5.09	11.91	2.01	15.08	3000	

# ANSI ROLLER CHAIN ATTACHMENT

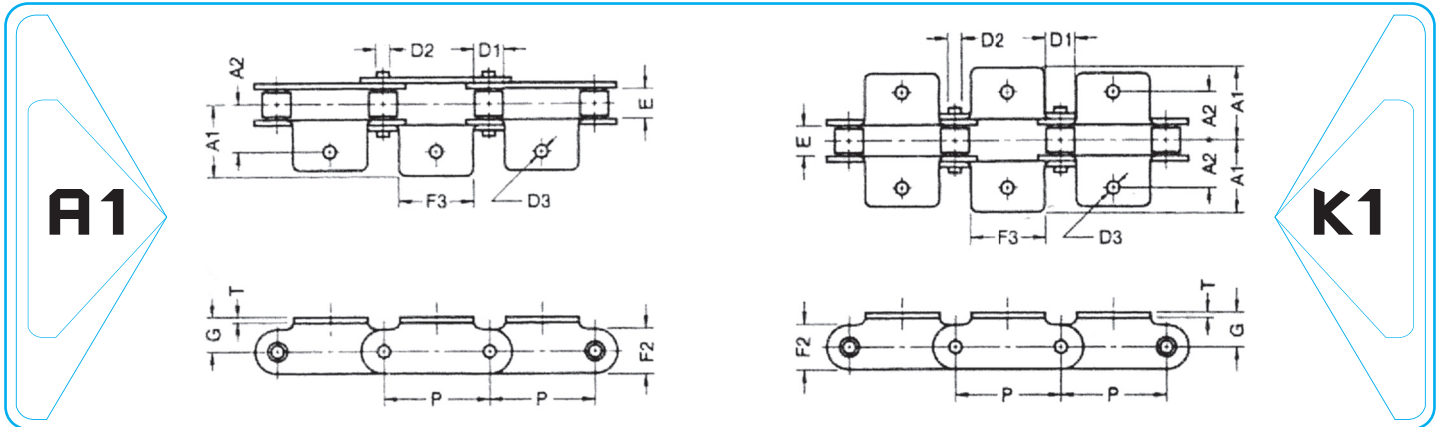

ISO Chain No.	Pitch x Width		Roller D1	Pin D2	Links		Attachment					Avg. Ulti Tensile Strength kgf
	P	x E			T	F2	A1	A2	F3	D3	G	
	inch	mm	mm	mm	mm	mm	mm	mm	mm	mm	mm	
PM 2040	1 x 5/16	25.4 x 7.92	7.92	3.98	1.49	12.06	18.85	12.70	19.05	3.57	9.12	1800
PM 2050	1 1/4 x 3/8	31.75 x 9.52	10.16	5.09	2.01	15.08	24.00	15.88	25.40	5.16	11.13	3000

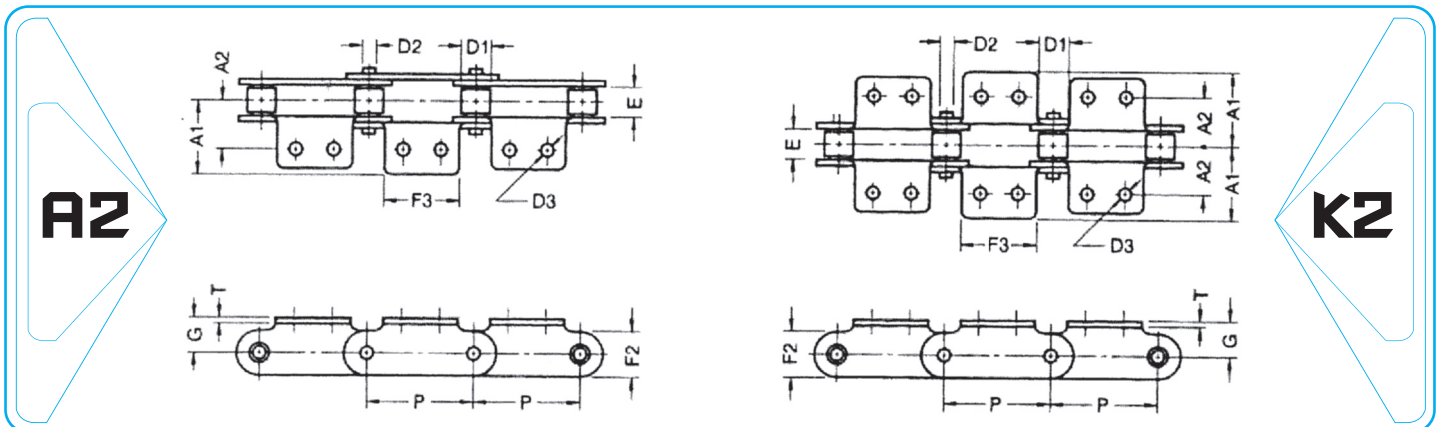

ISO Chain No.	Pitch x Width		Roller D1	Pin D2	Links		Attachment						Avg. Ulti Tensile Strength kgf
	P	x E			T	F2	A1	A2	F3	D3	G	M	
	inch	mm	mm	mm	mm	mm	mm	mm	mm	mm	mm	mm	
PM 2042	1 x 5/16	25.4 x 7.92	15.88	3.98	1.49	12.06	18.85	12.70	19.05	3.57	9.12	9.52	1800
PM 2052	1 1/4 x 3/8	31.75 x 9.52	19.05	5.09	2.01	15.08	24.00	15.88	25.40	5.16	11.13	11.91	3000

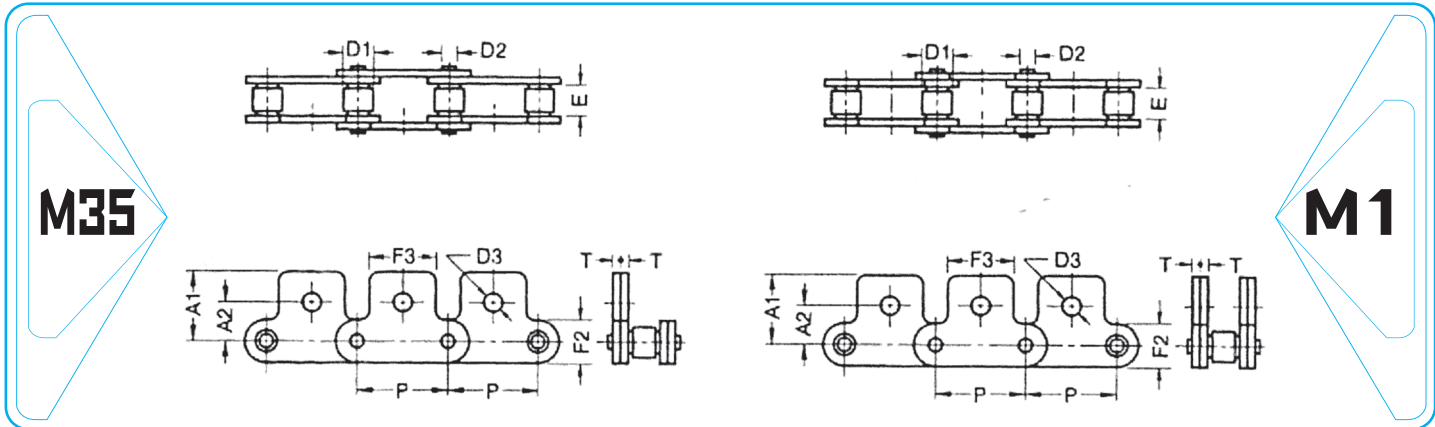

ISO Chain No.	Pitch x Width		Roller	Pin	Links		Attachment				Avg. Ulti Tensile Strength kgf
	P	x E			T	F2	A1	A2	F3	D3	
	inch	mm	mm	mm	mm	mm	mm	mm	mm	mm	
PM 2040	1 x 5/16	25.4 x 7.92	7.92	3.98	1.49	12.06	19.28	11.12	19.05	5.16	1800
PM 2050	1 1/4 x 3/8	31.75 x 9.52	10.16	5.09	2.01	15.08	24.60	14.27	25.40	6.35	3000

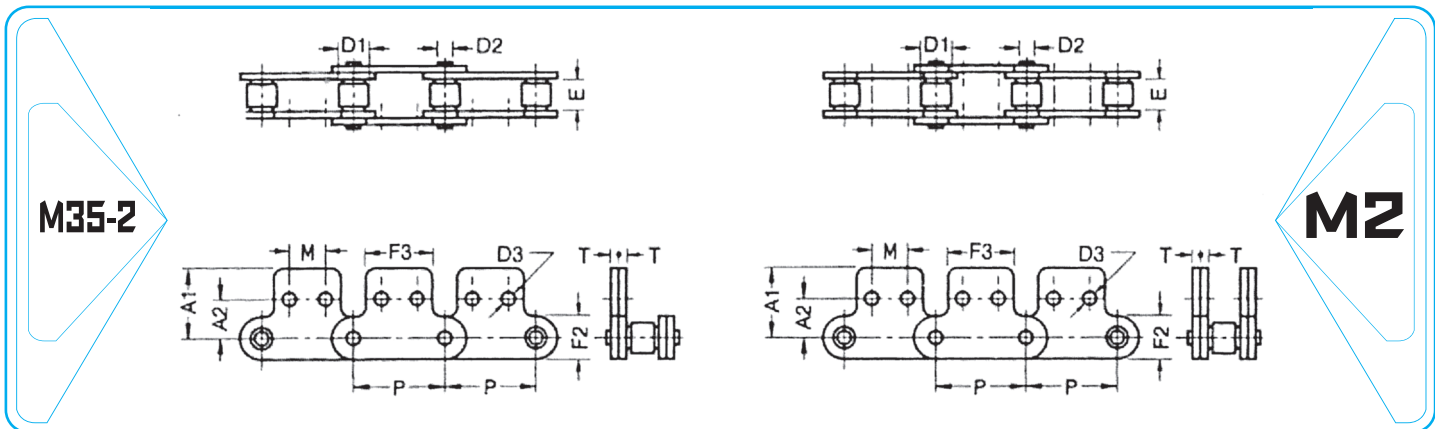

ISO Chain No.	Pitch x Width		Roller	Pin	Links		Attachment					Avg. Ulti Tensile Strength kgf
	P	x E			T	F2	A1	A2	F3	D3	G	
	inch	mm	mm	mm	mm	mm	mm	mm	mm	mm		
PM 2042	1 x 5/16	25.4 x 7.92	15.88	3.98	1.49	12.06	19.28	13.49	19.05	3.57	9.12	1800
PM 2052	1 1/4 x 3/8	31.75 x 9.52	19.05	5.09	2.01	15.08	24.60	5.88	25.40	5.16	11.13	3000

## STANDARD ROLLERS

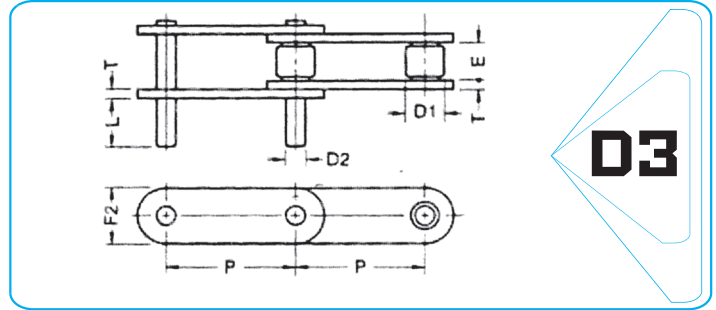
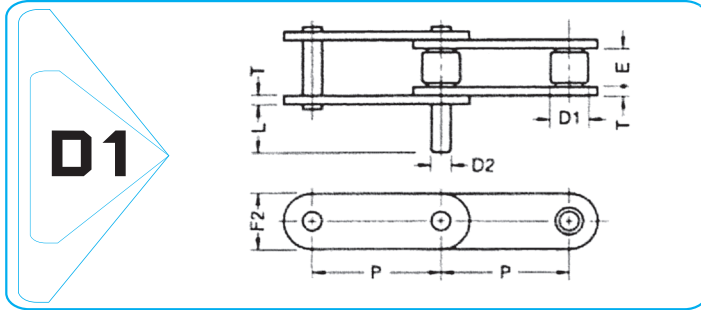

ANSI Chain No.	Pitch x Width			Roller D1 mm	Pin			Links		Avg. Ulti Tensile Strength kgf
	P	x	E		D2	L	T	F2		
	inch		mm		mm	mm	mm	mm		
PM C2060H	1½ x 1/2		38.1 x 12.70	11.91	5.96	14.27	3.18	18.09	5500	
PM C2080H	2 x 5/8		50.8 x 15.88	15.87	7.94	19.05	3.99	24.13	9000	
PM C2100H	2½ x 3/4		63.5 x 19.05	19.05	9.54	23.62	4.80	30.16	14000	
PM C2120H	3 x 1		76.2 x 25.40	22.22	11.11	28.58	5.57	36.19	16500	
PM C2160H	4 x 1¼		101.6 x 31.75	28.57	14.29	38.10	7.15	48.26	31500	

## LARGE ROLLERS

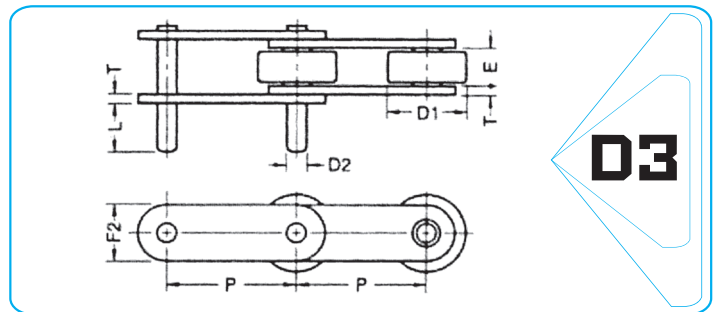
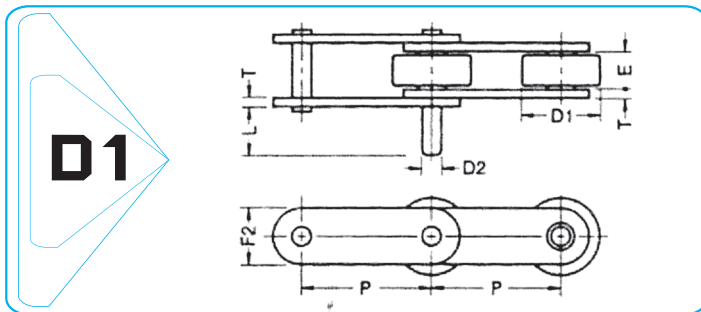

ANSI Chain No.	Pitch x Width			Roller D1 mm	Pin			Links		Avg. Ulti Tensile Strength kgf
	P	x	E		D2	L	T	F2		
	inch		mm		mm	mm	mm	mm		
PM C2062H	1½ x 1/2		38.1 x 12.70	22.22	5.96	14.27	3.18	18.09	5500	
PM C2082H	2 x 5/8		50.8 x 15.88	28.58	7.94	19.05	3.99	24.13	9000	
PM C2102H	2½ x 3/4		63.5 x 19.05	39.67	9.54	23.62	4.80	30.16	14000	
PM C2122H	3 x 1		76.2 x 25.40	44.45	11.11	28.58	5.57	36.19	16500	
PM C2162H	4 x 1¼		101.6 x 31.75	57.15	14.29	38.10	7.15	48.26	31500	

## FOR C2060H

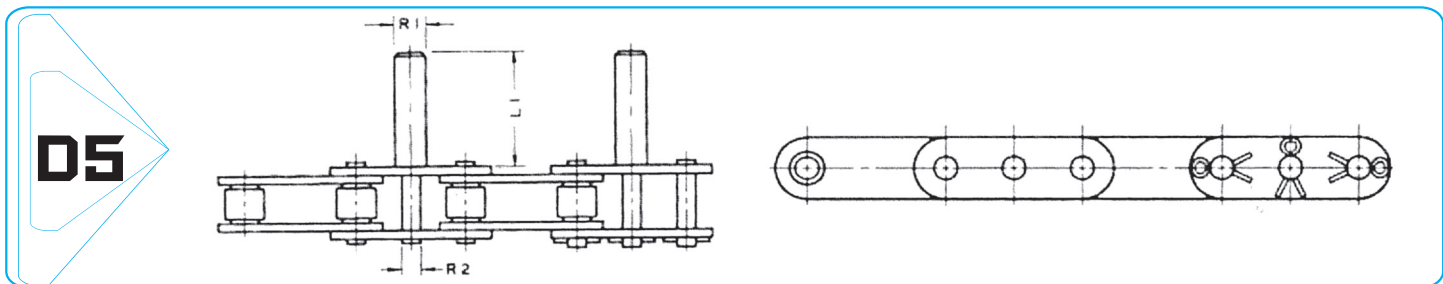

Dimensions-mm

Attachment	Type	R1	R2	L1
D-5	A	12.70	7.87	41.28
D-5	B	14.29	7.87	41.28

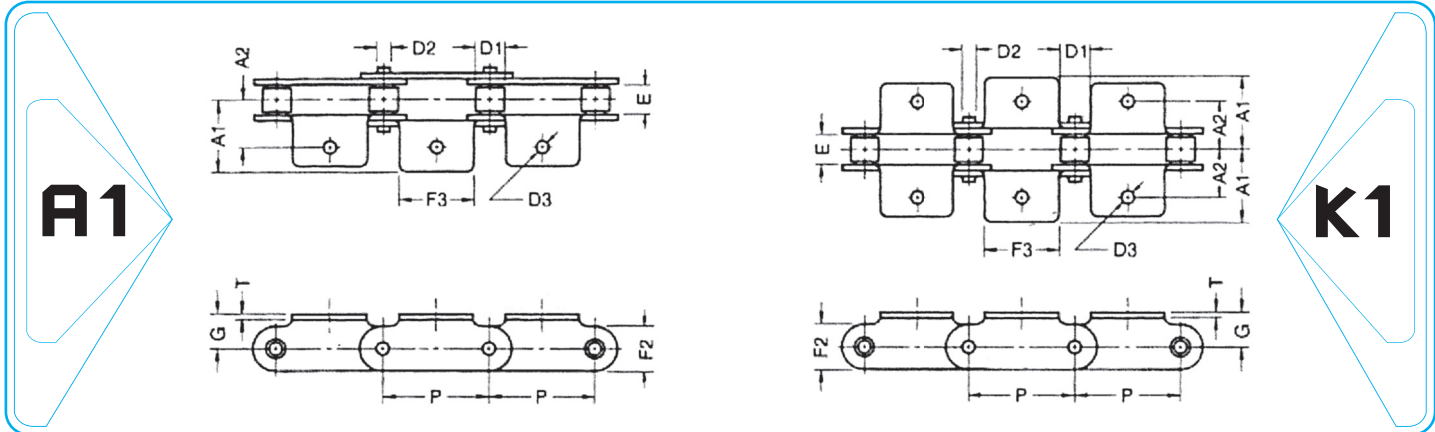

ISO Chain No.	Pitch x Width		Roller	Pin	Links		Attachment					Avg. Ulti Tensile Strength kgf
	P	x E			T	F2	A1	A2	F3	D3	G	
	inch	mm	mm	mm	mm	mm	mm	mm	mm	mm	mm	
PM 2060H	1½ x 1/2	38.1 x 12.70	11.91	5.96	3.18	18.09	30.56	21.44	28.58	5.16	14.68	5500
PM 2080H	2 x 5/8	50.8 x 15.88	15.87	7.94	3.99	24.13	38.50	27.79	38.10	6.75	19.05	9000
PM 2100H	2½ x 3/4	63.5 x 19.05	19.05	9.54	4.80	30.16	49.91	33.32	47.62	8.33	23.42	14000
PM 2120H	3 x 1	76.2 x 25.40	22.22	11.11	5.57	36.19	60.71	39.67	57.15	9.92	27.79	16500
PM 2160H	4 x 1¼	101.6 x 31.75	28.57	14.29	7.15	48.26	80.19	52.37	75.30	13.24	36.53	31500

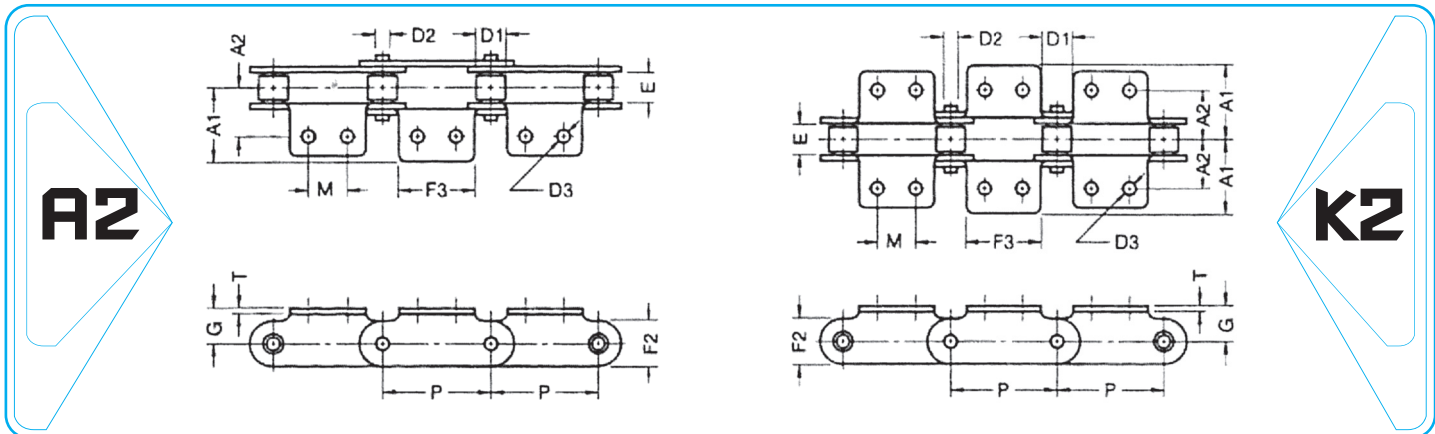

ISO Chain No.	Pitch x Width		Roller	Pin	Links		Attachment					Avg. Ulti Tensile Strength kgf	
	P	x E			T	F2	A1	A2	F3	D3	G		M
	inch	mm	mm	mm	mm	mm	mm	mm	mm	mm	mm		
PM 2062H	1½ x 1/2	38.1 x 12.70	22.22	5.96	3.18	18.09	30.56	21.44	28.58	5.16	14.68	14.27	5500
PM 2082H	2 x 5/8	50.8 x 15.88	28.58	7.94	3.99	24.13	38.50	27.79	38.10	6.75	19.05	19.05	9000
PM 2102H	2½ x 3/4	63.5 x 19.05	39.67	9.54	4.80	30.16	49.91	33.32	47.62	8.33	23.42	23.83	14000
PM 2122H	3 x 1	76.2 x 25.40	44.45	11.11	5.57	36.19	60.71	39.67	57.15	9.92	27.79	28.58	16500
PM 2162H	4 x 1¼	101.6 x 31.75	57.15	14.29	7.15	48.26	80.19	52.37	75.30	13.24	36.53	38.10	31500



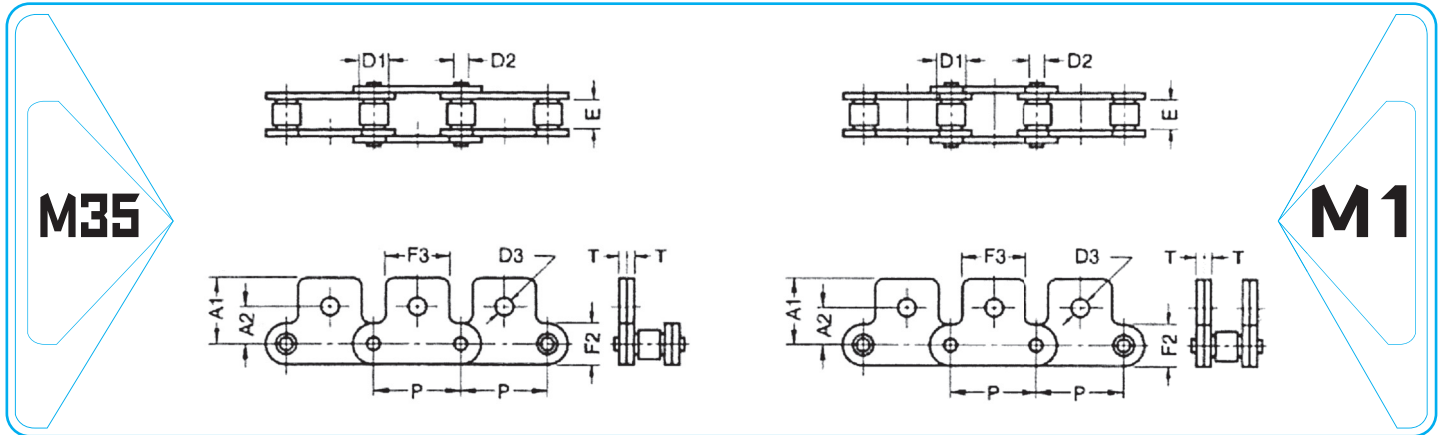

ISO Chain No.	Pitch x Width		Roller	Pin	Links		Attachment				Avg. Ulti Tensile Strength kgf
	P	x E			T	F2	A1	A2	F3	D3	
	inch	mm	D1 mm	D2 mm	mm	mm	mm	mm	mm	mm	
PM 2060H	1½ x 1/2	38.1 x 12.70	11.91	5.96	3.18	18.09	29.77	17.48	28.58	8.33	5500
PM 2080H	2 x 5/8	50.8 x 15.88	15.87	7.94	3.99	24.13	38.10	22.22	38.10	9.92	9000
PM 2100H	2½ x 3/4	63.5 x 19.05	19.05	9.54	4.80	30.16	50.40	28.58	47.62	13.10	14000
PM 2120H	3 x 1	76.2 x 25.40	22.22	11.11	5.57	36.19	59.93	33.32	57.15	14.68	16500
PM 2160H	4 x 1¼	101.6 x 31.75	28.57	14.29	7.15	48.26	76.83	44.45	75.30	19.46	31500

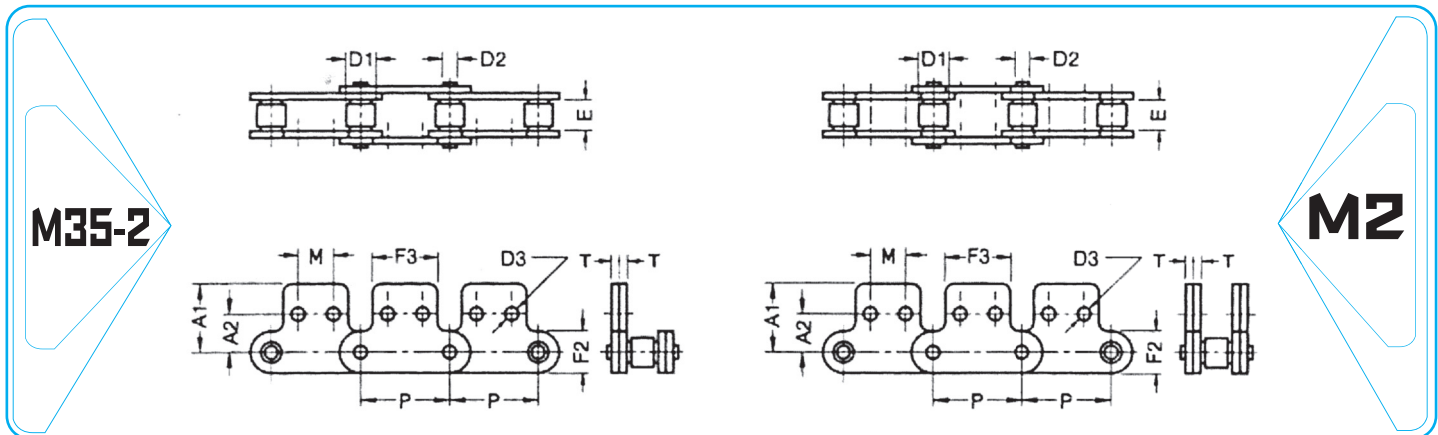

ISO Chain No.	Pitch x Width		Roller	Pin	Links		Attachment					Avg. Ulti Tensile Strength kgf
	P	x E			T	F2	A1	A2	F3	D3	G	
	inch	mm	D1 mm	D2 mm	mm	mm	mm	mm	mm	mm	mm	
PM 2062H	1½ x 1/2	38.1 x 12.70	22.22	5.96	3.18	18.09	29.77	19.05	28.58	5.16	14.27	5500
PM 2082H	2 x 5/8	50.8 x 15.88	28.58	7.94	3.99	24.13	38.10	25.40	38.10	6.75	19.05	9000
PM 2102H	2½ x 3/4	63.5 x 19.05	39.67	9.54	4.80	30.16	50.40	31.75	47.62	8.33	23.82	14000
PM 2122H	3 x 1	76.2 x 25.40	44.45	11.11	5.57	36.19	59.93	37.31	55.15	9.92	28.58	16500
PM 2162H	4 x 1¼	101.6 x 31.75	57.15	14.29	7.15	48.26	76.83	50.80	75.30	13.24	38.10	31500



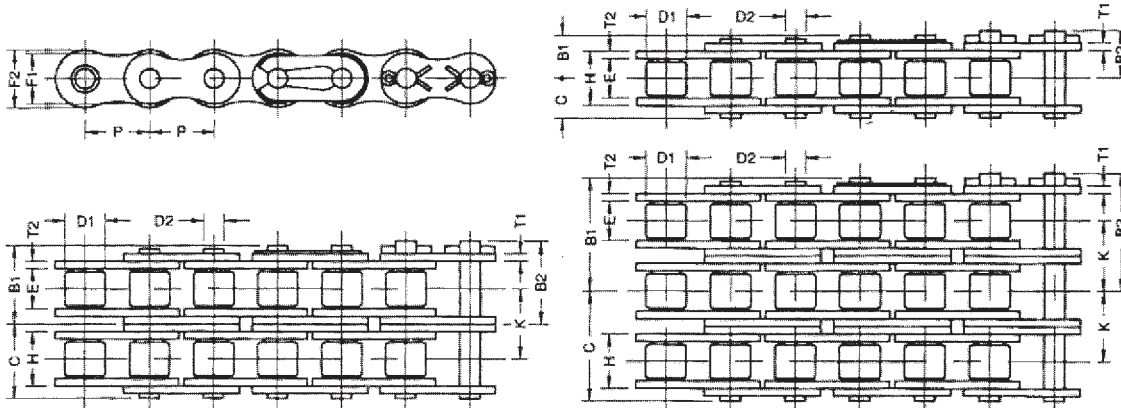

ANSI Chain No.	Pitch x Width		Roller	Pin				Links					Transverse Pitch	Avg. Ulti Tensile Strength	Approx Weight				
	P	x		E	D1	C	B1	B2	D2	T1	T2	H				F1	F2	K	
	inch			mm	mm	mm	mm	mm	mm	mm	mm	mm				mm	mm	mm	
PM 04B	0.236	x	0.116	6	x	2.8	4.00	3.17	4.56	-	1.85	0.62	0.62	4.10	5.00	5.00	-	340	0.133
PM 05B	0.315	x	0.118	8	x	3	5.00	3.87	4.82	-	2.31	0.78	0.78	4.77	7.10	7.10	-	580	0.164
PMC 06B-1	3/8	x	7/32	9.525	x	5.72	6.35	6.43	7.39	8.14	3.28	1.28	1.28	8.53	8.20	8.20	-	1050	0.41
PMC 06B-2	3/8	x	7/32	9.525	x	5.72	6.35	11.51	12.41	13.30	3.28	1.0	1.28	8.53	8.20	8.20	10.24	1850	0.74
PMC 06B-3	3/8	x	7/32	9.525	x	5.72	6.35	16.63	17.53	18.45	3.28	1.0	1.28	8.53	8.20	8.20	10.24	2970	1.10
PM 08B-1	1/2	x	5/16	12.7	x	7.75	8.51	8.17	9.17	10.57	4.45	1.49	1.58	11.30	10.92	11.80	-	2000	0.66
PM 08B-2	1/2	x	5/16	12.7	x	7.75	8.51	15.39	16.30	17.60	4.45	1.49	1.58	11.30	10.92	11.80	13.92	3450	1.30
PM 08B-3	1/2	x	5/16	12.7	x	7.75	8.51	22.05	23.05	24.45	4.45	1.49	1.58	11.30	10.92	11.80	13.92	4950	1.95
PM 10B-1	5/8	x	3/8	15.875	x	9.65	10.16	9.78	11.18	12.17	5.08	1.71	1.71	13.28	13.72	14.70	-	2650	0.92
PM 10B-2	5/8	x	3/8	15.875	x	9.65	10.16	18.20	19.70	20.70	5.08	1.71	1.71	13.28	13.72	14.70	16.59	5300	1.81
PM 10B-3	5/8	x	3/8	15.875	x	9.65	10.16	26.50	28.00	29.20	5.08	1.71	1.71	13.28	13.72	14.70	16.59	7950	2.70
PM 12B-1	3/4	x	7/16	19.05	x	11.68	12.07	11.18	12.28	14.48	5.72	1.86	1.86	15.62	16.10	16.10	-	3400	1.21
PM 12B-2	3/4	x	7/16	19.05	x	11.68	12.07	21.16	22.16	23.95	5.72	1.86	1.86	15.62	16.10	16.10	19.46	6800	2.40
PM 12B-3	3/4	x	7/16	19.05	x	11.68	12.07	30.85	31.85	33.90	5.72	1.86	1.86	15.62	16.10	16.10	19.46	10200	3.59
PM 16B-1	1	x	0.67	25.40	x	17.02	15.88	17.82	20.79	21.69	8.28	3.18	3.99	25.45	21.00	21.00	-	7500	2.66
PM 16B-2	1	x	0.67	25.40	x	17.02	15.88	33.68	35.99	37.49	8.28	3.18	3.99	25.45	21.00	21.00	31.88	14300	5.27
PM 16B-3	1	x	0.67	25.40	x	17.02	15.88	49.73	52.25	53.53	8.28	3.18	3.99	25.45	21.00	21.00	31.88	21300	7.88
PM 20B-1	1 1/4	x	0.77	31.75	x	19.56	19.05	19.95	-	24.25	10.19	3.18	4.46	29.01	26.40	26.40	-	11000	3.62
PM 20B-2	1 1/4	x	0.77	31.75	x	19.56	19.05	37.90	-	42.40	10.19	3.18	4.46	29.01	26.40	26.40	36.45	20900	7.16
PM 20B-3	1 1/4	x	0.77	31.75	x	19.56	19.05	56.25	-	61.25	10.19	3.18	4.46	29.01	26.40	26.40	36.45	31400	10.75
PM 24B-1	1 1/2	x	1	38.10	x	25.40	25.40	26.90	-	31.89	14.63	4.80	5.57	37.92	33.40	33.40	-	19000	6.65
PM 24B-2	1 1/2	x	1	38.10	x	25.40	25.40	50.50	-	56.34	14.63	4.80	5.57	37.92	33.40	33.40	48.36	36200	13.19
PM 24B-3	1 1/2	x	1	38.10	x	25.40	25.40	75.00	-	80.34	14.63	4.80	5.57	37.92	33.40	33.40	48.36	54200	19.69
PM 28B-1	1 3/4	x	1.22	44.5	x	30.99	27.94	32.5	-	37.7	15.90	6.00	7.00	38	36.7	36.7	52.3	22000	8.5
PM 28B-2	1 3/4	x	1.22	44.5	x	30.99	27.94	62.35	-	67.45	15.90	6.00	7.00	38	36.7	36.7	52.3	42000	16.60
PM 28B-3	1 3/4	x	1.22	44.5	x	30.99	27.94	92	-	97.3	15.90	6.00	7.00	38	36.7	36.7	52.3	63000	24.92
PM 32B-1	2.00	x	1.22	50.8	x	30.99	29.21	33.70	-	39.5	17.85	6.00	7.00	45.5	42.2	42.2	-	28600	9.80
PM 32B-2	2.00	x	1.22	50.8	x	30.99	29.21	63.0	-	68.5	17.85	6.00	7.00	45.5	42.2	42.2	58.55	54400	19.30
PM 32B-3	2.00	x	1.22	50.8	x	30.99	29.21	92.0	-	97.5	17.85	6.00	7.00	45.5	42.2	42.2	58.55	81700	28.90



# DOUBLE-PITCH ROLLER CHAIN SPROCKET

## ● Double Pitch Roller Chain Sprockets

The number of teeth of the sprocket is determined so that the chain meshes with one of every two teeth of sprocket per turn of the sprocket. This number of teeth is termed "number of working teeth."  
 In case of odd number of teeth, each tooth of the sprocket meshes with the chain per two turns of the sprocket, thus extending service life of the sprocket.

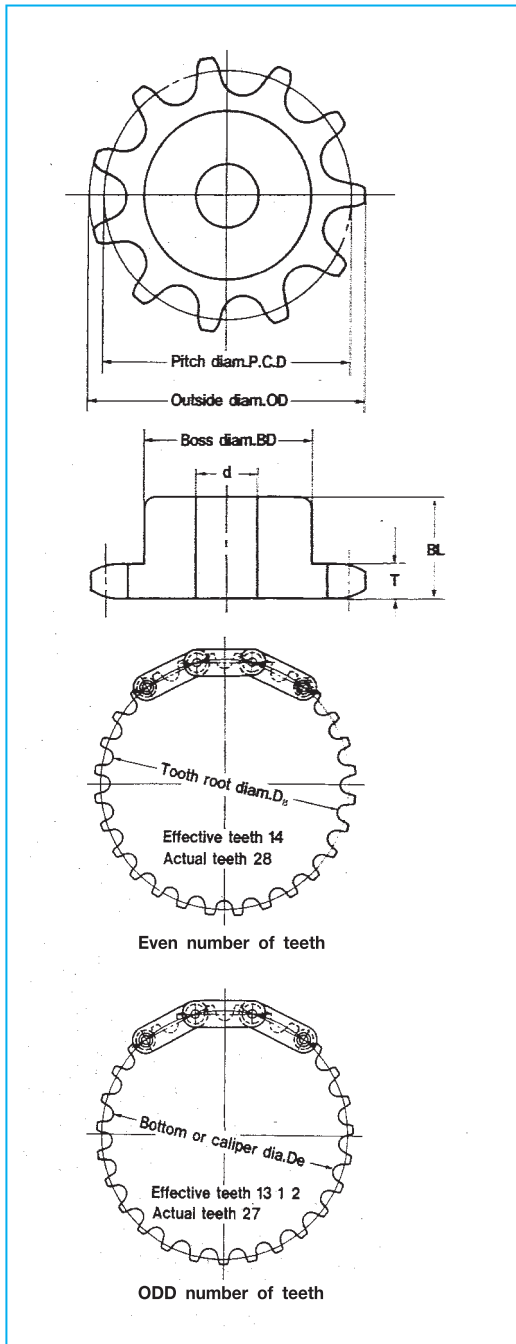

NOTES: Bottom diameter for even number of teeth, Caliper diameter for odd number of teeth.  
 [SHADED ZONE] is hardened teeth stock sprockets.

C2040 (T=7.2) Chain pitch 25.40, Distance between inside links 7.95 mm, roller diam. 7.95 mm

No. of teeth	No. of working teeth	Pitch diam P.C.D	Pitch Diam OD	Tooth root diam ▲	Shaft hole diam d		Boss		Approx weight kg
					Original hole dia.	Max	Diam. BD	Length BL	
15	7 1/2	62.45	67	54.16					
17	8 1/2	70.31	76	62.06					
18	9	74.26	80	66.31					
19	9 1/2	78.23	84	70.01	12.7	30	50	30	0.59
20	10	82.20	88	74.25	12.7	35	56	40	0.90
21	10 1/2	86.17	92	77.98	12.7	35	56	40	0.93
22	11	90.16	96	82.21	12.7	35	56	40	0.96
23	11 1/2	94.15	100	85.98	12.7	35	56	40	0.99
24	12	98.14	104	90.19	12.7	35	56	40	1.02
25	12 1/2	102.14	108	93.98	12.7	35	56	40	1.06
26	13	106.14	112	98.19	12.7	35	56	40	1.10
27	13 1/2	110.14	116	102.00	12.7	35	56	40	1.13
28	14	114.15	120	106.20	12.7	35	56	40	1.17
29	14 1/2	118.16	124	110.03	12.7	35	56	40	1.21

C2050 (T=8.7) Chain pitch 31.75, Distance between inside links 9.53 mm, roller diam. 10.16 mm

No. of teeth	No. of working teeth	Pitch diam P.C.D	Pitch Diam OD	Tooth root diam ▲	Shaft hole diam d		Boss		Approx weight kg
					Original hole dia.	Max	Diam. BD	Length BL	
15	7 1/2	78.06	84	67.47					
17	8 1/2	87.89	94	77.36					
18	9	92.83	100	82.67					
19	9 1/2	97.78	105	87.29	12.7	42	65	40	1.29
20	10	102.75	110	92.59	19.1	46	70	45	1.56
21	10 1/2	107.72	115	97.26	19.1	46	70	45	1.62
22	11	112.70	120	102.54	19.1	46	70	45	1.68
23	11 1/2	117.68	125	107.25	19.1	46	70	45	1.74
24	12	122.67	130	112.51	19.1	46	70	45	1.80
25	12 1/2	127.67	135	117.26	19.1	46	70	45	1.87
26	13	132.67	140	122.51	19.1	46	70	45	1.94
27	13 1/2	137.67	145	127.28	19.1	46	70	45	2.01
28	14	142.68	150	132.52	19.1	46	70	45	2.09
29	14 1/2	147.69	155	137.32	19.1	46	70	45	2.16

C2060 (T=11.7) Chain pitch 38.10, Distance between inside links 12.70 mm, roller diam. 11.91 mm

No. of teeth	No. of working teeth	Pitch diam P.C.D	Pitch Diam OD	Tooth root diam ▲	Shaft hole diam d		Boss		Approx weight kg
					Original hole dia.	Max	Diam. BD	Length BL	
15	7 1/2	93.67	101	81.25					
17	8 1/2	105.47	113	93.11					
18	9	111.40	119	99.49					
19	9 1/2	117.34	126	105.03	19.1	46	70	40	1.76
20	10	123.30	132	111.39	19.1	52	80	45	2.31
21	10 1/2	129.26	138	116.99	19.1	52	80	45	2.42
22	11	135.24	144	123.33	19.1	52	80	45	2.53
23	11 1/2	141.22	150	128.98	19.1	52	80	45	2.65
24	12	147.21	156	135.30	19.1	52	80	45	2.78
25	12 1/2	153.20	162	140.99	19.1	52	80	45	2.91
26	13	159.20	168	147.29	19.1	52	80	45	3.04
27	13 1/2	165.21	174	153.02	19.1	52	80	45	3.18
28	14	171.22	181	159.31	19.1	57	85	45	3.50
29	14 1/2	177.23	187	165.06	19.1	57	85	45	3.65

C2080 (T=14.6) Chain pitch 50.80, Distance between inside links 15.88 mm, roller diam. 15.88 mm

No. of teeth	No. of working teeth	Pitch diam P.C.D	Pitch Diam OD	Tooth root diam ▲	Shaft hole diam d		Boss		Approx weight kg
					Original hole dia.	Max	Diam. BD	Length BL	
15	7 1/2	124.90	135	108.33					
17	8 1/2	140.62	151	124.15					
18	9	148.53	159	132.65					
19	9 1/2	156.45	167	140.04	25.4	60	90	50	3.77
20	10	164.39	176	148.51	25.4	60	90	60	4.46
21	10 1/2	172.34	184	155.99	25.4	60	90	60	4.70
22	11	180.31	192	164.43	25	60	92	59	5.02
23	11 1/2	188.29	200	171.97	25	60	92	59	5.28
24	12	196.28	208	180.40	25	60	92	59	5.56
25	12 1/2	204.27	216	187.99	25	60	92	59	5.85
26	13	212.27	224	196.39	25	60	92	59	6.15
27	13 1/2	220.28	233	204.03	25	60	92	59	6.46
28	14	228.30	241	212.42	25	60	92	59	6.78
29	14 1/2	236.31	249	220.09	25	60	92	59	7.12



# DOUBLE-PITCH ROLLER CHAIN SPROCKET R TYPE

## ● R-type Roller Chain Sprockets

The R-type roller chain sprockets are exclusively designed for the double pitch roller chain.

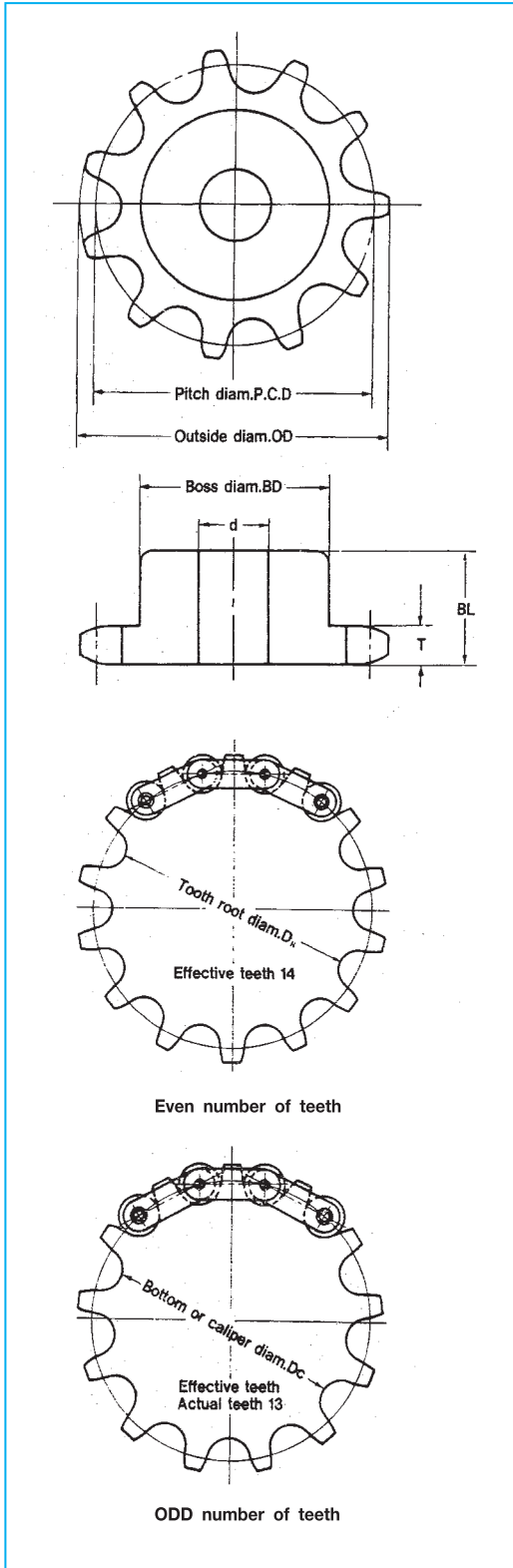

NOTES: Bottom diameter for even number of teeth, Caliper diameter for odd number of teeth.  
 SHADED ZONE is hardened teeth stock sprockets.

C2042 (T=7.2) Chain pitch 25.40, Distance between inside links 7.95 mm, roller diam. 15.88 mm

No. of working teeth	Pitch diam P.C.D	Pitch Diam OD	Tooth root diam ▲	Shaft hole diam d		Boss		Approx weight kg
				Original hole diam	Max	Diam. BD	Length BL	
10	82.20	93	66.32	19.1	35	56	40	0.85
11	90.16	102	73.36	19.1	35	56	40	0.91
12	98.14	110	82.26	19.1	35	56	40	0.97
13	106.14	118	89.48	19.1	35	56	40	1.05
14	114.15	127	98.27	19.1	35	56	40	1.12
15	122.17	135	105.62	19.1	42	65	40	1.43
16	130.20	143	114.32	19.1	42	65	40	1.52
18	146.27	159	130.39	19.1	42	65	40	1.72
20	162.37	176	146.49	19.1	46	70	45	2.21
24	194.60	208	178.72	25	50	75	50	2.97
25	202.66	216	186.38	25	50	75	50	3.12
26	210.72	224	194.84	25	50	75	50	3.26
28	226.86	241	210.98	25	50	75	50	3.58
30	243.00	257	227.12	25	50	75	50	3.91

C2052 (T=8.7) Chain pitch 31.75, Distance between inside links 9.53 mm, roller diam. 19.05 mm

10	102.75	117	83.70	25.4	46	70	45	1.49
11	112.70	127	92.50	25.4	46	70	45	1.60
12	112.67	138	103.62	25.4	46	70	46	1.73
13	132.67	148	112.65	25.4	46	70	45	1.86
14	142.68	158	123.63	25.4	46	70	45	2.01
15	152.71	168	132.82	25.4	46	70	45	2.17
16	162.74	179	143.69	25.4	46	70	45	2.24
18	182.84	199	163.79	25.4	46	70	45	2.71
20	202.96	220	183.91	25.4	50	75	50	3.45
24	243.25	260	224.20	25	57	85	60	5.23
25	253.32	270	223.78	25	57	85	60	5.50
26	263.40	281	244.35	25	57	85	60	5.78
28	283.57	301	264.52	25	57	85	60	6.37
30	303.75	321	284.70	25	57	85	60	7.00

C2062 (T=11.7) Chain pitch 38.10, Distance between inside links 12.70 mm, roller diam. 22.23 mm

10	123.30	140	101.07	25.4	52	80	45	2.23
11	135.24	153	111.63	25.4	52	80	45	2.45
12	147.21	165	124.98	25.4	52	80	45	2.70
13	159.20	177	135.81	25.4	52	80	45	2.9
14	171.22	190	148.99	25.4	52	80	45	3.22
15	183.25	202	160.02	25	57	85	50	3.94
16	195.29	214	173.06	25	57	85	50	4.27
18	219.41	239	197.18	25	57	85	55	5.19
20	243.55	263	221.32	25	57	85	55	6.00
24	291.90	312	269.67	25	57	85	55	7.87
25	303.99	324	281.16	25	57	85	55	8.39
26	316.09	337	293.86	25	57	85	55	8.93
28	340.29	361	318.06	25	63	95	65	11.1
30	364.50	385	342.27	25	63	95	65	12.3

C2082 (T=14.6) Chain pitch 50.80, Distance between inside links 15.88 mm, roller diam. 28.58 mm

10	164.39	187	135.81	25	63	95	65	4.90
11	180.31	204	149.90	25	63	95	65	5.48
12	196.28	220	167.70	25	63	95	65	6.02
13	212.27	237	182.14	25	63	95	65	6.61
14	228.30	253	199.72	25	63	95	65	7.25
15	244.33	269	214.42	25	63	95	65	7.93
16	260.39	286	231.81	25	63	95	55	8.66
18	292.55	319	263.97	25	72	105	75	11.5
20	324.74	351	296.16	25	72	105	75	13.3
24	389.19	416	360.61	25	72	105	75	17.5
25	405.32	433	375.94	25	72	105	75	18.6
26	421.45	449	392.87	25	72	105	75	19.8
28	453.72	481	425.14	25	78	115	85	23.9
30	485.99	514	457.41	25	78	115	85	26.7

**PITCH 3/8" FOR SPROCKET INDUCTION**

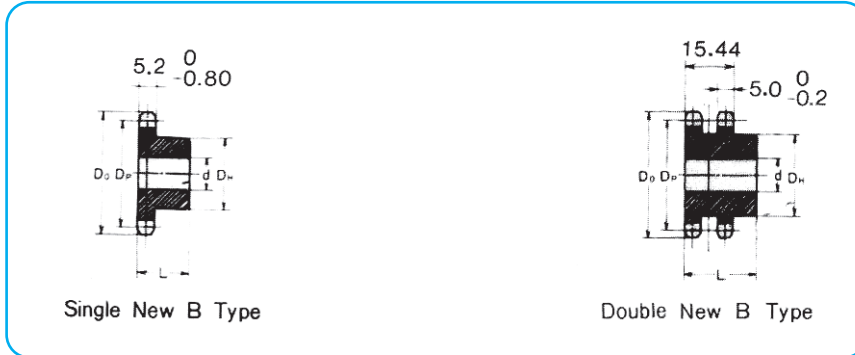

No. of Teeth	Pitch Dia. Dp	Out-Side Dia. Do	SINGLE B TYPE					DOUBLE-B-TYPE						
			Bore d		Hub		Approx. Weight (kg)	Material	Bore d		Hub		Approx. Weight (kg)	Material
			Stock	Max.	DH	L			Stock	Max.	DH	L		
PM 9	27.84	32	9	11	★ 22	20	0.06							
PM 10	30.84	34	9	12	★ 25	20	0.08							
PM 11	33.81	38	9	14	★ 27	20	0.09							
PM 12	36.80	41	10	16	★ 31	20	0.12		10	16	26	32	0.18	
PM 13	39.80	44	10	18	★ 32	20	0.12		10	18	32	32	0.21	
PM 14	42.81	47	10	18	32	20	0.12		12	19	35	32	0.25	
PM 15	45.81	51	10	20	35	20	0.16		12	19	35	32	0.28	
PM 16	48.82	54	10	20	37	20	0.19		12	20	37	32	0.32	
PM 17	51.84	57	12	25	41	20	0.22		12	24	41	32	0.38	
PM 18	54.85	60	12	25	44	20	0.25		12	25	44	32	0.44	
PM 19	57.87	63	12	28	47	20	0.28		12	28	47	32	0.49	
PM 20	60.89	66	12	30	50	20	0.32		13	30	50	35	0.60	
PM 21	63.91	69	12	30	53	20	0.36		13	32	53	35	0.67	
PM 22	66.93	72	12	35	56	20	0.37		13	37	55	35	0.73	
PM 23	69.95	75	12	38	60	20	0.38		15	38	57	35	0.78	
PM 24	72.97	78	12	32	53	22	0.43		15	38	57	35	0.83	
PM 25	76.00	81	12	32	53	22	0.44		15	38	57	35	0.87	
PM 26	79.02	84	12	32	53	22	0.45		15	38	57	35	0.91	
PM 27	82.05	87	12	32	53	22	0.46		15	38	57	35	0.98	
PM 28	85.07	90	12	32	53	22	0.48		15	38	57	35	1.03	
PM 29	88.10	93	12	32	53	22	0.49							
PM 30	91.12	96	12	32	53	22	0.51		15	38	57	35	1.07	
PM 31	94.15	99	12	32	53	22		S45C						S45C
PM 32	97.18	102	12	32	53	22	0.54		15	38	57	35	1.17	
PM 33	100.20	105	12	32	53	22								
PM 34	103.23	109	12	32	53	22	0.57							
PM 35	106.26	112	12	32	53	22	0.59		15	38	57	35	1.33	
PM 36	109.29	115	13	32	53	22	0.61		15	38	57	35	1.38	
PM 37	112.31	118	13	42	63	25								
PM 38	115.34	121	13	42	63	25	0.82		15	38	57	35	1.55	
PM 39	118.37	124	13	42	63	25								
PM 40	121.40	127	13	42	63	25	0.85		19	48	73	40	2.05	
PM 41	124.43	130	16	42	63	25	0.91							
PM 42	127.46	133	16	42	63	25	0.93		19	48	73	40	2.18	
PM 43	130.48	136	16	42	63	25	0.95							
PM 44	133.52	139	16	42	63	25	0.97							
PM 45	136.55	142	16	42	63	25	1.00		19	48	73	40	2.38	
PM 48	145.64	151	16	42	63	25	1.07		19	48	73	40	2.60	
PM 50	151.70	157	16	42	63	25	1.10		19	48	73	40	2.90	
PM 54	163.81	169	16	42	63	25	1.20		16	48	73	40	3.07	
PM 55	166.85	172	16	42	63	25	1.25							
PM 60	182.00	187	16	42	63	25	1.30		19	48	73	40	3.51	
PM 65	197.15	203	18	45	68	25	1.60		19	48	73	40	4.10	
PM 70	212.30	218	18	45	68	25	1.80		19	48	73	40	4.64	
PM 75	227.46	233	18	45	68	25	1.90							
PM 80	242.61	248	18	45	68	25	2.40							









**BS / SPROCKET no. 12 B**

**PITCH 3/4" FOR SPROCKET INDUCTION**

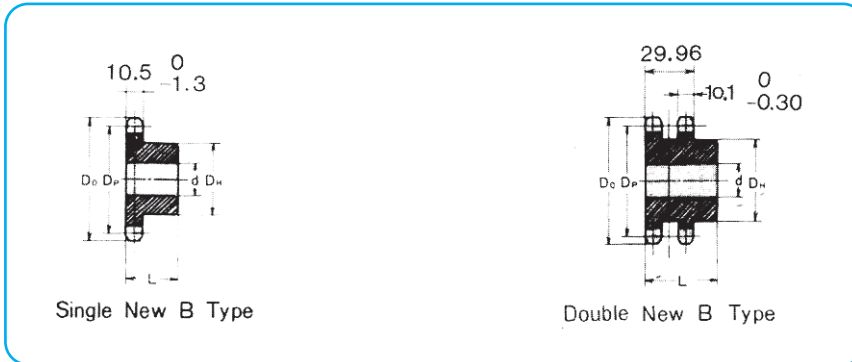

No. of Teeth	Pitch Dia. Dp	Out-Side Dia. Do	SINGLE B TYPE					DOUBLE-B-TYPE						
			Bore d		Hub		Approx. Weight (kg)	Material	Bore d		Hub		Approx. Weight (kg)	Material
			Stock	Max.	DH	L			Stock	Max.	DH	L		
PM 9	55.70	63	12	25	★ 43	32	0.40		16	20	35	50	0.90	
PM 10	61.65	70	15	30	★ 49	32	0.49		16	25	44	50	1.00	
PM 11	67.62	76	15	32	★ 51	32	0.60		16	30	50	50	1.20	
PM 12	73.60	83	15	32	51	32	0.69		18	38	60	50	1.40	
PM 13	79.60	89	15	35	57	32	0.81		18	45	66	56	1.80	
PM 14	85.61	95	17	40	62	32	0.96		18	48	72	56	2.10	
PM 15	91.62	101	17	45	68	32	1.10		18	51	78	56	2.50	
PM 16	97.65	107	17	48	73	32	1.30		18	55	82	56	2.60	
PM 17	103.67	113	17	48	73	32	1.40		18	60	90	56	3.20	
PM 18	109.71	119	17	55	83	40	2.00		18	63	94	56	3.70	
PM 19	115.74	126	17	55	83	40	2.10		23	66	100	56	4.20	
PM 20	121.78	132	17	55	83	40	2.20		23	66	100	56	4.40	
PM 21	127.82	138	17	55	83	40	2.30		23	66	100	56	4.90	
PM 22	133.86	144	17	55	83	40	2.50		23	66	100	56	4.70	
PM 23	139.90	150	17	55	83	40	2.50		23	89	120	56	6.00	
PM 24	145.95	156	17	55	83	40	2.60		23	89	120	56	6.40	
PM 25	151.99	162	17	55	83	40	2.70		23	89	120	56	6.80	
PM 26	158.04	168	17	55	83	40	2.90		23	89	120	56	7.30	
PM 27	164.09	174	21	55	83	40	3.00		23	89	120	56	7.80	
PM 28	170.14	180	21	55	83	40	3.10							
PM 29	176.20	187	21	55	83	40	3.30		28	89	130	56	9.00	
PM 30	182.25	193	21	55	83	40	3.40							
PM 31	188.30	199	21	55	83	40	3.64		28	89	127	56	9.50	
PM 32	194.35	205	21	55	83	40	3.80							
PM 33	200.41	211	21	55	83	40	4.00							
PM 34	206.46	217	21	55	83	40	4.15							
PM 35	212.52	223	21	55	83	40	4.33		28	89	127	56	11.00	
PM 36	218.57	229	21	55	83	40	4.52		28	66	98	56	8.50	
PM 37	224.63	235	21	55	83	40	4.70							
PM 38	230.69	241	21	55	83	40	4.90		28	66	98	56	9.00	
PM 39	236.74	247	21	55	83	40	5.10							
PM 40	242.80	253	21	55	83	40	5.30		28	66	98	56	9.70	
PM 41	248.86	260	23	63	93	45	6.00							
PM 42	254.92	266	23	63	93	45	6.40		28	75	107	56	11.00	
PM 43	260.98	272	23	63	93	45	6.60							
PM 44	267.03	278	23	63	93	45	6.88							
PM 45	273.09	284	23	63	93	45	7.10		28	75	107	71	12.80	
PM 48	291.27	302	23	63	93	45	7.85		28	75	107	71	14.00	
PM 50	303.39	314	23	63	93	45	8.40		28	75	107	71	16.00	
PM 54	327.63	338	23	63	93	45	9.50		28	75	107	71	18.00	
PM 60	363.99	375	23	63	93	45	11.30		28	75	107	71	21.50	
PM 65	394.30	405	26	70	107	45	13.50		28	75	107	71	24.00	
PM 70	424.61	436	26	70	107	45	15.30		28	75	107	71	30.00	
PM 72	436.73	448	26	70	107	45	16.00							
PM 75	454.92	466	26	70	107	45	17.20							
PM 80	485.23	496	30	80	117	50	20.00							
PM 84	509.48	521	30	80	117	50	21.90							
PM 85	515.54	527	30	80	117	50	22.30							
PM 90	545.85	557	30	80	117	50	24.60							
PM 92	557.98	569	30	80	117	50	25.60							
PM 95	576.17	587	30	80	117	50	27.10							
PM 96	582.23	593	30	80	117	50	26.70							



**BS / SPROCKET no. 16 B**

**PITCH 1" FOR SPROCKET INDUCTION**

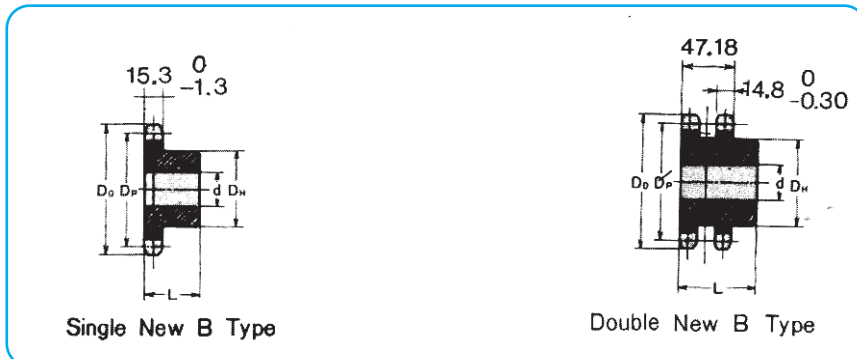

No. of Teeth	Pitch Dia. Dp	Out-Side Dia. Do	SINGLE B TYPE					DOUBLE-B-TYPE						
			Bore d		Hub		Approx. Weight (kg)	Material	Bore d		Hub		Approx. Weight (kg)	Material
			Stock	Max.	DH	L			Stock	Max.	DH	L		
PM 9	74.27	85	17	35	★58	40	0.87							
PM 10	82.19	93	17	32	52	40	0.97			21	35	58	63	2.00
PM 11	90.15	102	17	38	60	40	1.20			21	38	60	63	2.50
PM 12	98.14	110	21	45	67	40	1.50			23	46	69	63	2.70
PM 13	106.14	118	21	51	77	40	1.90			23	55	80	63	3.40
PM 14	114.15	127	21	51	77	40	2.00			23	60	88	63	3.90
PM 15	122.17	135	21	63	93	40	2.60			23	63	95	63	4.40
PM 16	130.20	143	21	63	93	40	2.80			23	66	100	71	5.40
PM 17	138.23	151	21	63	93	40	3.00			23	66	100	71	6.00
PM 18	146.27	159	21	63	93	40	3.20			23	80	120	71	7.50
PM 19	154.32	167	22	63	93	40	3.40			23	80	120	71	8.00
PM 20	162.37	176	22	63	93	40	3.60			23	80	130	71	9.00
PM 21	170.42	184	22	63	93	40	3.80			23	80	130	71	9.50
PM 22	178.48	192	26	75	107	45	5.00			33	80	117	71	8.80
PM 23	186.54	200	26	75	107	45	5.23			33	80	117	71	9.30
PM 24	194.60	208	26	75	107	45	5.50			33	80	117	80	10.50
PM 25	202.66	216	26	75	107	45	5.80			33	80	117	80	11.10
PM 26	210.72	224	26	75	107	45	6.10			33	80	117	80	11.70
PM 27	218.79	233	26	75	107	45	6.40			33	80	117	80	12.50
PM 28	226.86	241	26	75	107	45	6.75			33	80	117	80	13.50
PM 29	234.93	249	26	75	107	45	7.10							
PM 30	243.00	257	26	75	107	45	7.40			33	80	117	80	14.20
PM 31	251.07	265	26	75	107	45	7.80							
PM 32	259.14	273	26	75	107	45	8.15			33	80	117	80	16.50
PM 33	267.21	281	26	75	107	45	8.50							
PM 34	275.29	289	26	75	107	45	8.90							
PM 35	283.36	297	26	75	107	45	9.30			33	80	117	80	17.90
PM 36	291.43	306	30	80	117	50	10.60			33	80	117	80	19.00
PM 37	299.51	314	30	80	117	50	11.00							
PM 38	307.58	322	30	80	117	50	11.40			38	89	127	80	21.00
PM 39	315.66	330	30	80	117	50	11.90							
PM 40	323.74	338	30	80	117	50	12.40			38	89	127	90	23.70
PM 41	331.81	346	30	80	117	50	12.80							
PM 42	339.89	354	30	80	117	50	13.30			38	89	127	90	26.00
PM 43	347.97	362	30	80	117	50	13.80							
PM 44	356.04	370	30	80	117	50	14.30							
PM 45	364.12	378	30	80	117	50	14.90			38	89	127	90	28.40
PM 48	388.36	403	30	80	117	50	15.80			38	89	127	90	32.00
PM 50	404.52	419	30	80	117	50	17.65			38	89	127	90	34.00
PM 54	436.84	451	30	80	117	50	20.00			38	89	127	90	38.50
PM 60	485.33	500	30	80	117	50	23.10			38	89	127	90	46.20
PM 65	525.73	540	38	85	127	63	28.80			38	89	127	90	52.00
PM 70	566.15	581	38	85	127	63	32.10			38	89	127	90	65.00
PM 72	582.31	597	38	85	127	63	34.50							
PM 75	606.56	621	38	85	127	63	36.20							
PM 80	646.97	662	38	90	137	71	42.90							
PM 84	679.31	694	38	90	137	71	46.70							
PM 85	687.39	702	38	90	137	71	47.70							
PM 90	727.80	743	38	90	137	71	52.90							
PM 92	743.97	759	38	90	137	71	55.00							
PM 95	768.22	783	38	90	137	71	58.30							
PM 96	776.31	791	38	90	137	71	59.40							

S45C

S45C



**BS / SPROCKET no. 20 B**

**PITCH 1.1/4" FOR SPROCKET INDUCTION**

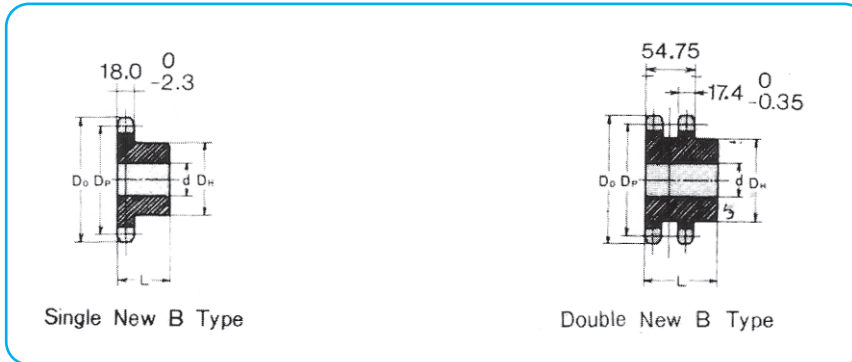

No. of Teeth	Pitch Dia. Dp	Out-Side Dia. Do	SINGLE B TYPE					Material	DOUBLE-B-TYPE					Material
			Bore d		Hub		Approx. Weight (kg)		Bore d		Hub		Approx. Weight (kg)	
			Stock	Max.	DH	L			Stock	Max.	DH	L		
PM 9	92.84	106	21	40	62	50	1.60							
PM 10	102.74	117	22	45	65	50	1.90		22	46	70	80	3.50	
PM 11	112.70	127	22	51	75	50	2.30		22	55	80	80	4.20	
PM 12	122.67	138	22	57	86	50	2.90		28	60	90	80	5.00	
PM 13	132.67	148	22	63	94	50	3.10		28	66	100	80	6.00	
PM 14	142.68	158	22	66	98	50	3.60		28	75	110	80	7.00	
PM 15	152.71	168	22	66	98	50	4.20		28	80	120	80	7.10	
PM 16	162.74	179	22	66	98	50	4.60		28	89	130	80	7.70	
PM 17	172.79	189	22	75	107	50	5.30		28	89	130	80	8.90	
PM 18	182.84	199	22	75	107	50	5.70		28	89	130	80	9.60	
PM 19	192.90	209	26	75	107	50	6.10		28	89	130	90	12.80	
PM 20	202.96	220	26	75	107	50	6.50		28	89	130	90	13.50	
PM 21	213.03	230	26	75	107	50	7.00		28	89	130	90	14.30	
PM 22	223.10	240	30	80	117	56	7.90		28	89	127	90	15.50	
PM 23	233.17	250	30	80	117	56	8.50		28	89	127	90	16.60	
PM 24	243.25	260	30	80	117	56	8.80		38	95	137	90	17.80	
PM 25	253.32	270	30	80	117	56	9.30		38	95	137	90	18.50	
PM 26	263.40	281	30	80	117	56	9.80		38	95	137	90	19.80	
PM 27	273.49	291	30	80	117	56	10.30		38	95	137	90	21.00	
PM 28	283.57	301	30	80	117	56	10.90		38	95	137	90	22.00	
PM 29	293.66	311	30	80	117	56	11.50							
PM 30	303.75	321	30	80	117	56	12.10		38	95	137	90	24.00	
PM 31	313.83	331	35	80	117	56	13.00							
PM 32	323.92	341	35	80	117	56	13.40		38	95	137	90	27.30	
PM 33	334.01	352	35	80	117	56	14.50							
PM 34	344.11	362	35	80	117	56	16.10							
PM 35	354.20	372	35	89	127	63	16.60		38	95	137	90	30.00	
PM 36	364.29	382	35	89	127	63	17.50		38	95	137	90	32.90	
PM 37	374.38	392	35	89	127	63	18.00							
PM 38	384.48	402	35	89	127	63	18.90		38	95	137	90	36.50	
PM 39	394.57	412	35	89	127	63	20.00							
PM 40	404.67	422	35	89	127	63	20.40		38	103	147	100	40.00	
PM 41	414.77	433	35	89	127	63	21.50							
PM 42	424.86	443	35	89	127	63	22.60		38	103	147	100	45.70	
PM 43	434.96	453	35	89	127	63	23.50							
PM 44	445.06	463	35	89	127	63	24.00							
PM 45	455.16	473	35	89	127	63	24.70		38	103	147	100	49.00	
PM 48	485.45	503	35	89	127	63	27.50		38	103	147	100	53.30	
PM 50	505.65	524	38	89	127	63	30.00							
PM 54	546.05	564	38	103	147	80	37.40		38	103	147	100	63.00	
PM 60	606.66	625	38	103	147	80	44.30		38	103	147	125	68.30	
PM 65	657.17	675	38	103	147	80	53.00							
PM 70	707.68	726	38	103	*147	100	44.70							
PM 72	727.89	746	38	103	*147	100	46.00							
PM 75	758.20	777	38	103	*147	100	47.00							

S45C

S45C

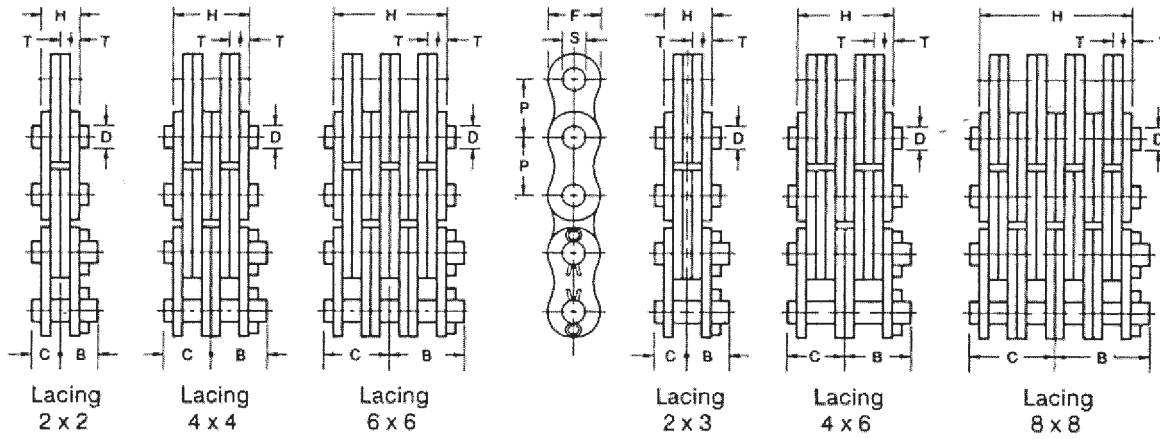

ANSI Chain No.	Pitch x Width		Lacing	Pin			Links				Avg. Ulti Tensile Strength kgf	Approx Weight kg/m
	P			C	B	D	S	T	H	F		
	inch	mm										
PM AL-222	1/4	6.35	2 x 2	2.40	3.40	2.32	3.34	0.76	3.40	5.01	420	0.09
PM AL-322	3/8	9.525	2 x 2	3.46	5.26	3.59	3.62	1.28	5.44	7.80	1050	0.21
PM AL-422	1/2	12.70	2 x 2	4.12	6.32	3.98	4.0	1.49	6.45	10.41	1800	0.35
PM AL-444			4 x 4	7.35	9.55				12.90		3600	0.69
PM AL-466			6 x 6	10.58	12.78				19.35		5400	1.03
PM AL-522	5/8	15.875	2 x 2	5.40	7.8	5.09	5.12	2.01	8.48	13.01	3000	0.58
PM AL-544			4 x 4	9.64	12.04				16.96		6000	1.14
PM AL-566			6 x 6	13.88	16.28				25.45		9000	1.69
PM AL-622	3/4	19.05	2 x 2	6.34	9.14	5.96	5.98	2.38	9.91	15.64	4200	0.79
PM AL-644			4 x 4	11.10	13.90				19.81		8400	1.53
PM AL-646			4 x 6	13.58	16.38				24.77		8400	1.91
PM AL-666			6 x 6	16.06	18.86				29.72		12600	2.29
PM AL-688	1	25.40	8 x 8	21.02	23.82	7.94	7.96	3.18	39.62	20.82	16800	3.05
PM AL-822			2 x 2	8.50	12.4				13.41		7200	1.44
PM AL-844			4 x 4	14.81	18.71				26.82		14400	2.81
PM AL-866			6 x 6	21.52	25.42				40.23		21600	4.20
PM AL-888	8 x 8	28.22	32.12	53.64	28800	5.57						
PM AL-1044	1 1/4	31.75	4 x 4	18.70	22.60	9.54	9.57	3.99	33.12	26.03	23000	4.69
PM AL-1066			6 x 6	26.75	30.65				49.68		34000	6.99
PM AL-1088			8 x 8	34.85	38.75				66.24		46000	9.29
PM AL-1244	1 1/2	38.10	4 x 4	22.19	26.29	11.11	11.14	4.80	39.62	31.24	29600	6.24
PM AL-1266			6 x 6	31.72	36.32				59.44		44400	9.30
PM AL-1288			8 x 8	41.66	46.26				79.25		59200	12.37
PM AL-1444	1 3/4	44.45	4 x 4	25.3	30.3	12.71	12.75	5.57	46.60	36.44	43000	9.15
PM AL-1466			6 x 6	37.0	42.0				69.60		65000	13.70
PM AL-1488			8 x 8	48.0	53.0				92.60		86700	18.30
PM AL-1644	2	50.80	4 x 4	29.3	34.3	14.29	14.33	6.49	52.9	41.65	57100	11.3
PM AL-1666			6 x 6	42.5	47.5				79.6		85800	16.9
PM AL-1688			8 x 8	54.5	59.5				105.2		114000	22.6



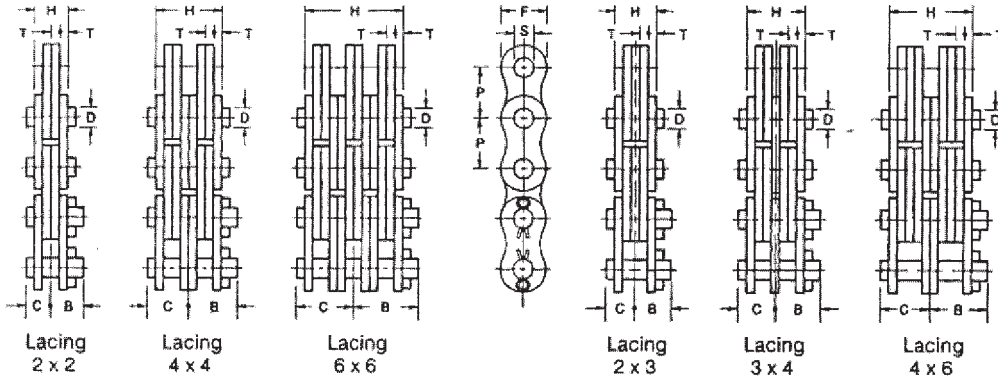

ANSI Chain No.	Pitch x Width		Lacing	Pin			Links				Avg. Ulti Tensile Strength kgf	Approx. Weight kg/m
	P			C	B	D	S	T	H	F		
	inch	mm										
PM BL-422	1/2	12.70	2 x 2	5.40	7.8	5.09	5.12	2.01	8.48	12.06	2700	0.58
PM BL-423			2 x 3	6.46	8.86				10.62		2700	0.72
PM BL-434			3 x 4	8.58	10.98				14.86		4050	1.00
PM BL-444			4 x 4	9.64	12.04				16.97		5400	1.13
PM BL-446			4 x 6	11.76	14.16				21.21		5400	1.42
PM BL-466			6 x 6	13.88	16.28				25.45		8100	1.69
PM BL-522	5/8	15.875	2 x 2	6.34	9.14	5.96	5.98	2.38	9.91	15.08	4250	0.87
PM BL-523			2 x 3	7.48	10.28				12.40		4250	1.06
PM BL-534			3 x 4	9.94	12.74				17.35		6400	1.49
PM BL-544			4 x 4	11.10	13.9				19.81		8500	1.69
PM BL-546			4 x 6	13.58	16.38				24.77		8500	2.10
PM BL-566			6 x 6	16.06	18.86				29.72		12750	2.52
PM BL-622	3/4	19.05	2 x 2	8.50	12.4	7.94	7.96	3.18	13.41	18.10	6550	1.44
PM BL-623			2 x 3	9.86	13.76				16.76		6550	1.77
PM BL-634			3 x 4	13.14	17.04				23.47		10000	2.45
PM BL-644			4 x 4	14.81	18.71				26.82		13200	2.79
PM BL-646			4 x 6	18.16	22.06				33.53		13200	3.47
PM BL-666			6 x 6	21.52	25.42				40.23		19800	4.15
PM BL-822	1	25.40	2 x 2	10.3	14.2	9.54	9.56	3.99	16.56	24.13	10500	2.30
PM BL-823			2 x 3	12.45	16.35				20.70		10500	2.86
PM BL-834			3 x 4	16.40	20.30				28.98		15500	3.96
PM BL-844			4 x 4	18.70	22.60				33.12		21000	4.52
PM BL-846			4 x 6	22.45	26.35				41.40		21000	5.61
PM BL-866			6 x 6	26.75	30.65				49.68		30000	6.72
PM BL-1022	1 1/4	31.75	2 x 2	12.68	17.28	11.11	11.14	4.80	19.81	30.16	15000	3.66
PM BL-1023			2 x 3	15.04	19.64				24.77		15000	4.54
PM BL-1034			3 x 4	19.84	24.44				34.67		22500	6.30
PM BL-1044			4 x 4	22.19	26.79				39.62		30000	7.18
PM BL-1046			4 x 6	26.96	31.56				49.53		30000	8.94
PM BL-1066			6 x 6	31.72	36.32				59.44		45000	10.69
PM BL-1222	1 1/2	38.10	2 x 2	14.36	19.36	12.71	12.74	5.57	23.27	36.19	20000	5.03
PM BL-1223			2 x 3	17.16	22.16				29.08		20000	6.25
PM BL-1234			3 x 4	22.76	27.76				40.72		30000	8.69
PM BL-1244			4 x 4	25.58	30.58				46.53		40000	9.91
PM BL-1246			4 x 6	31.18	36.18				58.17		40000	12.34
PM BL-1266			6 x 6	37.0	42.0				69.80		60000	14.78
PM BL-1422	1 3/4	44.45	2 x 2	16.12	21.16	14.29	14.31	6.49	26.42	42.22	24000	6.76
PM BL-1423			2 x 3	19.27	24.31				33.22		24000	8.40
PM BL-1434			3 x 4	25.80	30.84				46.23		36000	11.70
PM BL-1444			4 x 4	29.05	34.09				52.83		48000	13.35
PM BL-1446			4 x 6	35.3	40.34				66.04		48000	16.62
PM BL-1466			6 x 6	41.82	46.86				79.25		72000	19.92
PM BL-1622	2	50.80	2 x 2	18.0	23.0	17.46	17.52	7.14	29.5	48.26	35000	8.25
PM BL-1623			2 x 3	21.7	26.7				36.9		35000	10.20
PM BL-1634			3 x 4	29.0	34.0				51.5		63000	14.20
PM BL-1644			4 x 4	32.8	37.8				58.8		71200	16.20
PM BL-1646			4 x 6	40.0	45.0				73.3		71200	20.30
PM BL-1666			6 x 6	47.3	52.3				87.8		106800	24.3

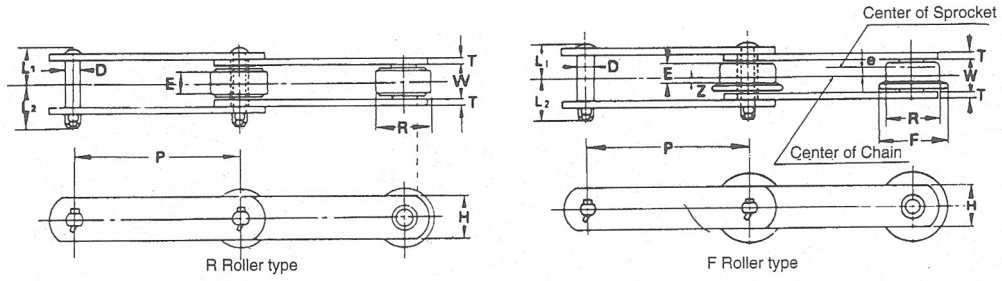

Chain Size	Roller Type	Average Tensile Strength (kgf)	Pitch P	Roller									Inner Width of Chain
				R		F				S	M, N		
				R	E	R	F	E	e	Z	R	R	
03075	R-F-S	3,000	75										
03100	R-F-S		100	31.8	15.5	31.8	42	12	1.8	4.3	15.9	-	16.1
430	R-S	5,500	101.6	38.1	19	-	-	-	-	-	20.1	-	22.6
05075	S	7,000	75										
05100	R-F-S		100	40	19	40	50	14	2.5	4.5	22.2	-	22
05150	R-F-S		150										
204	S	8,000	66.27	-	-	-	-	-	-	-	22.2	-	27
450	R-F-S-M	8,000	101.6	44.5	23	44.5	55	18	2.5	6.5	22.2	-	27
08150	R-F-S-M	8,000	150	44.5	23	44.5	55	18	2.5	6.5	22.2	25.4	27
650	R-F-S-M	8,000	152.4	50.8	26	50.8	65	20	3	7	25.8	31.8	30.2
10100	R-S-M	11,500	100										
10150	R-F-S-M		150	50.8	27	50.8	65	20	3	7	29	31.8	30.0
214	R-S-M	13,000	101.6	44.5	27	-	-	-	-	-	31.8	34.9	31.6
205	S	13,000	78.11	-	-	-	-	-	-	-	31.8	-	37.1
6205	R-F-S-M	19,000	152.4	57.2	32	57.2	70	25	3.5	9	34.9	38.1	37.1
12200	R-F-S-M	19,000	200										
12250	R-F-S-M		250	65	32	65	80	24	4	8	34.9	38.1	37.1
212	R-S-M	25,000	152.4	69.9	32.5	-	-	-	-	-	40.1	44.4	37.1
17200	R-F-S-M	25,000	200										
17250	R-F-S-M		250	80	44	80	100	34	5	12	40.1	44.5	51.4
17300	R-F-S-M		300										
26200	S-M	32,000	200	-	-	-	-	-	-	-			
26250	R-F-S-M		250										
26300	R-F-S-M		300	100	50	100	125	38	6	13	44.5	50.8	57.2
26450	R-F-S-M		450										
36250	S-M	48,500	250	-	-	-	-	-	-	-			
36300	R-F-S-M		300										
36450	R-F-S-M		450	125	56	125	150	42	7	14	50.8	57.2	66.7
36600	R-F-S-M		600										
52300	R-F-S	51,000	300										
52450	R-F-S		450	140	65	140	170	49	8	16.5	57.2	-	77
52600	R-F-S		600										
60300	R-F-N	51,000	300										
60350	R-F-N		350	140	68	140	170	49	8	16.5	-	70	77
60400	R-F-N		400										
90350	N	80,500	350	-	-	-	-	-	-	-			
90400	R-F-N		400	170	76	170	205	56	10	18	-	85	88
90500	R-F-N		500										
120400	R-N	113,000	400										
120600	R-F-N		600	200	87	200	240	64	11.5	20.5	-	100	100

R = Large Roller      F = Fringe Type      S = Regular Roller  
M, N = Roller Dia Laeger Than Regular Roller But Smaller Than Plate Height

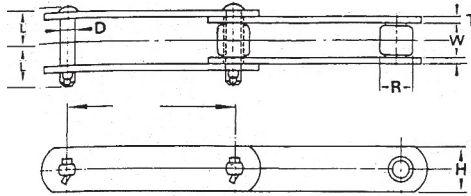

S, M, and N Roller types

Plate		Pin				Weight of Roller (kgf/m)				Attachments						
H	T	D	L1+L2	L1	L2	R	F	S	M	A-1 K-1	A-2 K-2	A-2 Welded	A-3 Welded	SA-2 SK-2	G-2	G-4
22	3.2	8.0	38	18	20	2.7	2.8	1.9	-	R.F.S	R.F.S			R.S		
						2.3	2.4	1.7	-	R.F.S	R.F.S			R.S		
25.4	4.8(5.0)	9.7	55	25.5	29.5	4.3	-	3.0	-	R. S	R. S			R.S		
						-	-	4.2	-	S	S					
32	4.5	11.3	53.5	25	28.5	5.0	5.2	3.7	-	R.F.S	R.F.S			R.S	RS*1	
						4.1	4.2	3.2	-	R.F.S	R.F.S			R.S	R.F.S	
28.6	6.3(6.0)	11.3	65.5	31	34.5	-	-	5.6	-	S						
28.6	6.3(6.0)	11.3	65.5	31	34.5	6.8	7.2	4.6	4.9	R.F.S.M	R.F.S.M			R.S.M		
28.6	6.3(6.0)	11.3	65.5	31	34.5	5.5	5.6	4.0	4.2	R.F.S.M	R.F.S.M			R.S.M		
38.1	6.3(6.0)	11.3	69	32.5	36.5	7.7	8.0	6.0	6.4	R.F.S.M	R.F.S.M			R.S.M	R.F.S.M	S.M
						9.8	-	6.8	7.1	R. S.M	R. S.M			R.S.M	S.M * 2	
38.1	6.3(6.0)	14.5	69	33	36	7.9	8.1	5.9	6.1	R.F.S.M	R.F.S.M			R.S.M	R.F.S.M	S.M
38.1	7.9	15.9	77.5	37.5	40	10.4	-	8.7	9.1	R. S.M	R. S.M			R.S.M		
38.1	7.9	15.9	83.5	40.5	43	-	-	10.4	-		S					
44.5	7.9	15.9	83.5	40.5	43	12.1	12.4	9.3	9.6	R.F.S.M	R.F.S.M			R.S.M	R.F.S.M	S.M
						11.4	11.9	8.4	8.7	R.F.S.M	R.F.S.M			R.S.M	R.F.S.M	S.M
44.5	7.9	15.9	83.5	40.5	43	10.3	10.6	7.8	8.0	R.F.S.M	R.F.S.M			R.S.M	R.F.S.M	
50.8	9.5(10)	19.1	95.5	44.5	51	17.1	-	12.6	13.1	R. S.M	R. S.M			R.S.M		
						18.8	19.8	12.0	12.6	R.F.S.M	R.F.S.M				R.F.S.M	S.M
50.8	9.5(10)	19.1	109.5	51.5	58	16.5	17.3	11.1	11.6	R.F.S.M	R.F.S.M				R.F.S.M	S.M
						15.0	15.7	10.5	10.9			R.F.S.M			R.F.S.M	
						-	-	16.0	17.0							S.M
						25.3	26.2	14.7	15.5							S.M* <sub>3</sub>
63.5	9.5(10)	22.2	116.5	55.5	61	22.3	23.6	13.8	14.5			R.F.S.M			R.F.S.M	S.M
						18.0	18.9	12.4	12.9				R.F.S.M		R.F.S.M	
						-	-	24.4	25.5							S.M
						39.0	40.1	22.9	23.8							S.M* <sub>4</sub>
76.2	12.7	25.4	146	68	78	30.7	31.9	20.2	20.8				R.F.S.M		R.F.S.M	
						26.9	27.8	19.0	19.5				R.F.S.M		R.F.S.M	
						48.8	52.5	29.7	-							
76.2	16	31.8	172	82	90	37.5	39.3	26.2	-				R.F		R.F.S	
						32.9	34.3	24.4	-				R.F		R.F.S	
						52.4	55.1	-	31.0			R.F.N				
90	12.7	35.0	160.5	77	83.5	47.2	49.5	-	28.8				R.F.N			
						43.8	45.8	-	27.7				R.F.N			
						-	-	-	42.4							
110	16	42.0	189.5	89.5	100	66.9	71.6	-	40.8							
						59.0	62.8	-	38.1					R.F.N		
						105.7	-	-	63.9							
130	19	50.0	218.5	105.5	113	83.3	88.0	-	55.4			R. N				
														R.F.N		

## A-1, K-1

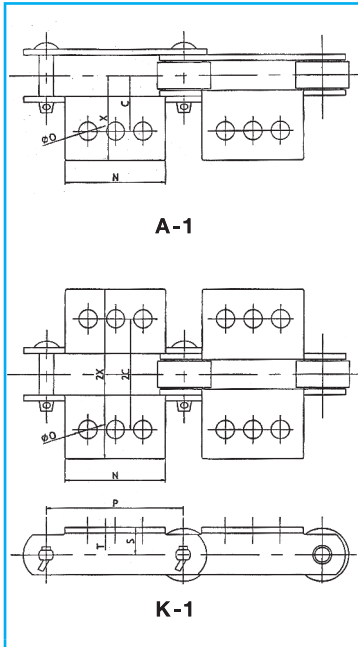

Chain Size	Roller Type	P	S	C	2C	X	2X	N	T	O	Screw Diameter	Attachment weight/pc
03075	R-F-S	75	20	30	60	46	92	55	3.2	10	M8	0.05
03100	R-F-S	100	20	30	60	46	92	65	3.2	10	M8	0.06
430	R-S	101.6	22	40	80	54	108	70	4.8(5.0)	12	M10	0.11
05075	S	75						55				0.03
05100	R-F-S	100	22	35	70	47	94	65	4.5	10	M8	0.08
05150	R-F-S	150						85				0.10
204	S	66.27	24	45	90	59	118	35	6.3(6.0)	12	M10	0.08
450	R-F-S-M	101.6	28	50	100	64	128	70	6.3(6.0)	12	M10	0.18
08150	R-F-S-M	150	28	50	100	64	128	90	6.3(6.0)	12	M10	0.22
650	R-F-S-M	152.4	32	50	100	64	128	90	6.3(6.0)	12	M10	0.22
10100	R-S-M	100						70				0.16
10150	R-F-S-M	150	28	50	100	65	130	90	6.3(6.0)	12	M10	0.20
214	R-S-M	101.6	35	55	110	73	146	80	7.9	15	M12	0.28
6205	R-F-S-M	152.4	38	60	120	79	158	100	7.9	15	M12	0.37
12200	R-F-S-M	200						120				0.45
12250	R-F-S-M	250	38	60	120	79	158	165	7.9	15	M12	0.62
212	R-S-M	152.4	45	65	130	83	166	100	9.5(10.0)	15	M12	0.49
17200	R-F-S-M	200						120				0.66
17250	R-F-S-M	250	45	75	150	98	196	165	9.5(10.0)	15	M12	0.79

## A-2, K-2

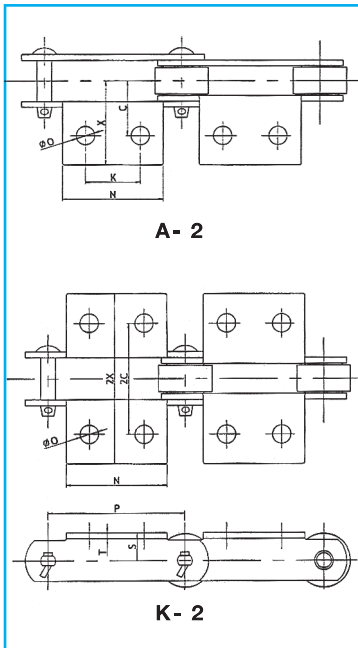

Chain Size	Roller Type	P	S	C	2C	X	2X	N	K	T	O	Screw Diameter	Attachment weight/pc
03075	R-F-S	75	20	30	60	46	92	55	30	3.2	10	M8	0.05
03100	R-F-S	100	20	30	60	46	92	65	40	3.2	10	M8	0.06
430	R-S	101.6	22	40	80	54	108	70	40	4.8(5.0)	12	M10	0.11
05075	R-F-S	75						55	30				0.07
05100	R-F-S	100	22	35	70	47	94	65	40	4.5	10	M8	0.08
05150	R-F-S	150						86	60				0.10
450	R-F-S-M	101.6	28	50	100	64	128	70	40	6.3(6.0)	12	M10	0.18
08150	R-F-S-M	150	28	50	100	64	128	90	60	6.3(6.0)	12	M10	0.22
650	R-F-S-M	152.4	32	50	100	64	128	90	60	6.3(6.0)	12	M10	0.22
10100	R-S-M	100						90	40				0.16
10150	R-F-S-M	150	28	50	100	65	130	90	60	6.3(6.0)	12	M10	0.20
214	R-S-M	101.6	35	55	110	73	146	80	40	7.9	15	M12	0.28
205	S	78.11	35	60	120	75	150	65	30	7.9	12	M10	0.23
6205	R-F-S-M	152.4	38	60	120	79	158	100	60	7.9	15	M12	0.37
12200	R-F-S-M	200						120	80				0.45
12250	R-F-S-M	250	38	60	120	79	158	165	125	7.9	15	M12	0.62
212	R-S-M	152.4	45	46	130	83	166	100	60	9.5(10.0)	15	M12	0.49
17200	R-F-S-M	200						120	80	9.5(10.0)	15	M12	0.66
17250	R-F-S-M	250	45	75	150	98	196	165	125	9.5(10.0)	15	M12	0.79

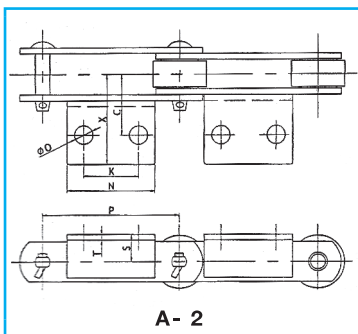

## WELDED A-2, K-2

Chain Size	Roller Type	P	S	C	X	K	N	O	Angle Steel	Screw Diameter	Attachment weight/pc
17300	R-F-S-M	300	45	75	110.5	180	220	15	L 65x65x6	M12	1.34
26300	R-F-S-M	300	55	80	123.5	180	220	15	L 75x75x9	M12	2.22
60300	R-F-N	300	90	115	165	110	170	24	L 100x100x13	M20	3.30
90350	N	350	100	140	210	100	180	28	L 130x130x15	M24	5.20
90400	R-F-N	400				150	230				6.60
20400	R-N	400	120	150	220	120	200	28	L 130x130x15	M24	5.80

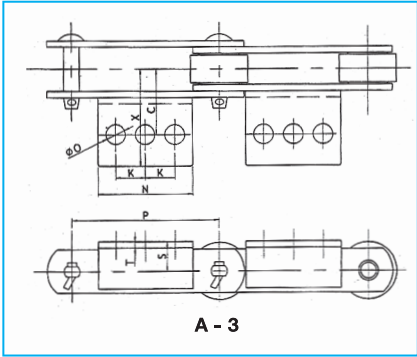

A - 3

### A - 3 (WELDED)

Chain Size	Roller Type	P	S	C	X	K	N	O	Angle Steel	Screw Diameter	Attachment weight/pc
26450	R-F-S-M	450	55	80	123.5	140	320	15	L75x75x9	M12	3.26
26450	R-F-S-M	450	70	100	160	140	330	19	L100x100x10	M16	5.07
36600	R-F-S-M	600				180	410				6.26
52450	R-F	450	80	120	171.4	140	330	24	L100x100x13	M20	6.30
52600	R-F	600				180	410				7.80
60350	R-F-N	350	90	115	165	80	220	24	L100x100x13	M20	4.20
60400	R-F-N	400				100	260				6.00
90500	R-F-N	500	100	140	210	130	340	28	L130x130x15	M24	9.80
120600	R-F-N	600	220	150	220	160	400	28	L130x130x15	M24	11.50

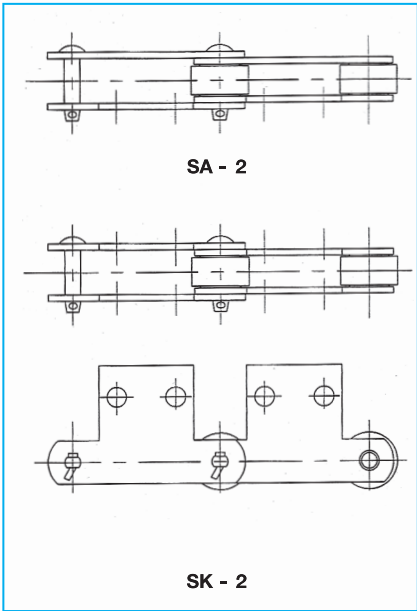

SA - 2

SK - 2

### SA-2 · SK-2

Chain Size	Roller Type	P	S <sub>1</sub>	S <sub>2</sub>	Q <sub>1</sub>	Q <sub>2</sub>	K	N	T	O	Screw Diameter	Attachment weight/pc
03075	R-S	75	33	49	15.5	11.5	30	55	32	10	M8	0.05
03100	R-S	100					40	65				0.06
0430	R-S	101.6	37.6	51.6	22(22.5)	16(16.5)	40	70	4.8(5.0)	12	M10	0.11
05100	R-S	100	33.4	50.7	21	15.5	40	65	4.5	10	M8	0.08
05150	R-S	150					60	85				0.10
450	R-S-W	101.6	47.6	60.7	27(26.5)	20(19.5)	40	70	6.3(6.0)	12	M10	0.18
08150	R-S-W	150	46.1	58.7	27(26.5)	20(19.5)	60	90	6.3(6.0)	12	M10	0.22
650	R-S-W	152.4	50	63	28.5(28)	21.5(21)	60	90	6.3(6.0)	12	M10	0.22
10100	R-S-W	100	46.1	61	28.5(28)	21.5(21)	40	70	6.3(6.0)	12	M10	0.16
10150	R-S-W	150					60	90				0.20
214	R-S-W	101.6	50	70	32.5	23.5	40	80	7.9	15	M12	0.28
6205	R-S-W	152.4	55	75.7	35.5	26.5	60	100	7.9	15	M12	0.37
12200	R-S-W	200	55	75.7	35.5	26.5	80	120	7.9	15	M12	0.45
12250	R-S-W	250					125	165				0.62
212	R-S-W	152.4	152.4	60	38(39.5)	28(28.5)	60	100	9.5(10.0)	15	M12	0.49

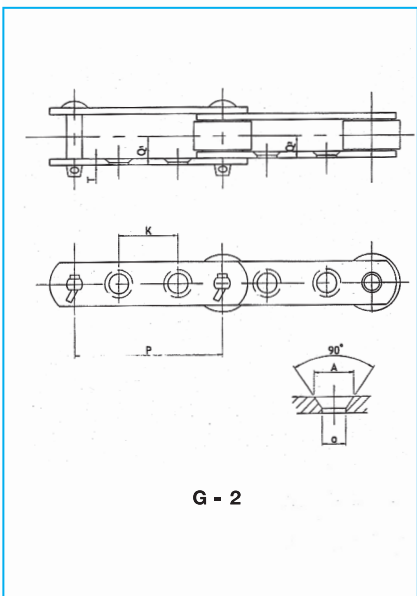

G - 2

### G - 2

Chain Size	Roller Type	P	K	T	Q <sub>1</sub>	Q <sub>2</sub>	A	O	Bolt		Attachment weight/pc
									Pin Link	Roller Link	
05100	R-S	100	40	4.5	21	15.5	15	10	36	26	M8
05150	R-F-S	150	60								
650	R-F-S-M	152.4	60	6.3(6)	28.5(28)	21.5(21)	20	12	49	35	M10
10100	S-M	100	30	6.3(6)	28.5(28)	21.5(21)	20	12	49	35	M10
10150	R-F-S-M	150	60								
6205	R-F-S-M	152.4	50	7.9	35.5	26.5	26	15	63	45	M12
12200	R-F-S-M	200	80	7.9	35.5	26.5	26	15	63	45	M12
12250	R-F-S-M	250	125								
17200	R-F-S-M	200	70	9.5(10.0)	45.5(46.5)	35(35.5)	26	15	81	61	M12
17250	R-F-S-M	250	110								
17300	R-F-S-M	300	150								
26300	R-F-S-M	300	140	9.5(10.0)	45.5(46.5)	38(38.5)	26	15	88	67	M12
26450	R-F-S-M	450	220								
36450	R-F-S-M	450	220	12.7	59.5	46	32	19	105	75	M16
36600	R-F-S-M	600	300								
52450	R-F-S	450	200	16	71.5	45.5	38	24	125	90	M20
52600	R-F-S	600	300								

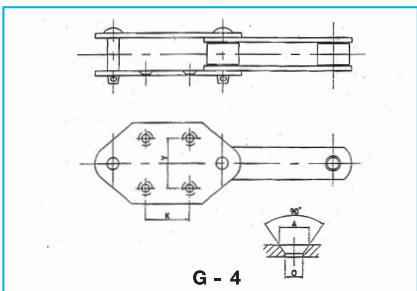

G - 4

### G - 4

Chain Size	Attachment			
	K	Y	O	A
10150-S	75	70	11	19.5
6205-S	75	70	15	27
12200-S	100	70	15	27
17200-S	100	80	15	27
26250-S	140	100	15	27
26300-S	180	100	15	27
650-S	75	70	11	19.5
26200-S	100	80	15	27
36250-S	140	100	19	32
36300-S	180	100	19	32



PCM Standard conveyor sprockets are manufactured by a precision flame-cutting technique. The special tooth profile designed by PCM minimizes the play of the roller and permits smooth normal and reverse action. PCM Standard Conveyor Sprockets are available in A, B and C types from stock. A standard or special hub can be easily welded to the sprocket.

STYLE R F

STYLE S

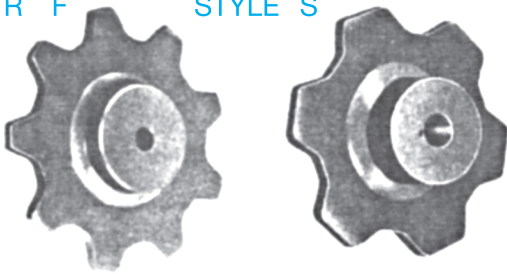

**MATERIAL**  
Plates: S45C

STYLE R • F

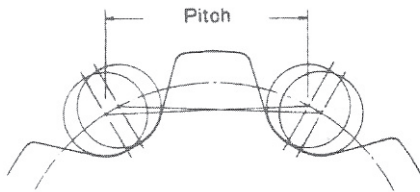

STYLE S

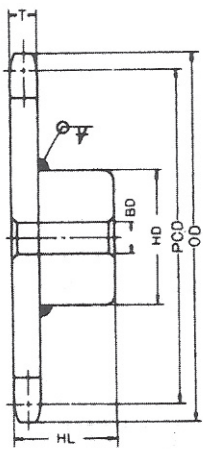
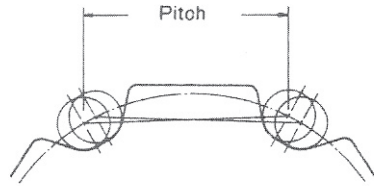

TYPE B

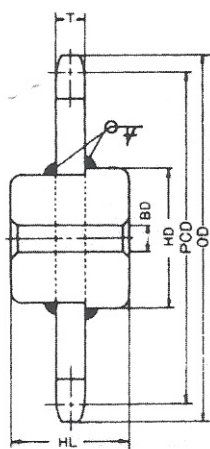

TYPE C

**SC 3075-S.R.F**

No. of Teeth	Style	Teeth Face T	OD	P.C.D.	Bore Dia		Type B		Type C		Approx Weight Each	
					Min.	Max.	HD	HL	HD	HL	B	C
6	S	12	154	150.00	20	40	68	50	73	55	2.9	3.2
	R	12	171								2.7	3.0
	F	9	171								2.4	2.7
7	S	12	178	172.86	20	45	73	55	83	60	3.8	4.4
	R	12	194								3.5	4.1
	F	9	194								3.1	3.7
8	S	12	203	195.92	20	45	73	55	83	60	4.4	5.0
	R	12	217								4.1	4.7
	F	9	217								3.5	4.2
9	S	12	228	219.30	20	55	83	60	93	70	5.8	6.8
	R	12	240								5.4	6.5
	F	9	240								4.7	5.8
10	S	12	252	242.27	20	55	83	60	93	70	6.6	7.6
	R	12	263								6.2	7.2
	F	9	263								5.3	6.4
11	S	12	278	266.24	20	55	83	60	93	70	7.5	8.5
	R	12	287								7.1	8.1
	F	9	287								6.0	7.0
12	S	12	302	289.80	20	55	83	60	93	70	8.5	9.6
	R	12	311								8.1	9.1
	F	9	311								6.7	7.8

**SC 3100-S.R.F**

6	S	12	203	200.00	20	45	73	55	83	60	4.6	5.2
	R	12	221								4.5	5.1
	F	9	221								3.8	4.5
7	S	12	237	230.48	20	45	73	55	83	60	5.5	6.2
	R	12	251								5.4	6.0
	F	9	251								4.5	5.2
8	S	12	268	261.23	20	45	73	55	83	60	6.7	7.3
	R	12	282								6.5	7.2
	F	9	282								5.3	6.0
9	S	12	301	292.40	20	55	83	60	93	70	8.6	9.7
	R	12	310								8.4	9.5
	F	9	313								7.0	8.1
10	S	12	334	323.62	20	55	83	60	93	70	10.1	11.5
	R	12	344								9.9	11.0
	F	9	344								8.1	9.2
11	S	12	365	354.99	20	55	83	60	93	70	11.7	12.7
	R	12	376								11.5	12.5
	F	9	376								9.3	10.3
12	S	12	398	386.40	20	55	83	60	93	70	13.4	14.5
	R	12	407								13.2	14.2
	F	9	407								10.5	11.6

**SC 5100-S.R.F**

6	S	16	209	200.00	25	60	93	70	98	80	7.1	8.0
	R	16	228								6.8	7.7
	F	12	228								6.0	6.9
7	S	16	243	230.48	25	65	98	80	108	90	9.3	10.8
	R	16	258								8.9	10.5
	F	12	258								7.9	9.5
8	S	16	276	261.23	25	65	98	80	108	90	10.8	12.4
	R	16	289								10.4	11.9
	F	12	289								9.0	10.6
9	S	16	309	292.40	25	65	98	80	108	90	12.6	14.1
	R	16	320								12.1	13.6
	F	12	320								10.3	11.8
10	S	16	342	323.62	25	70	108	90	117	100	16.1	17.8
	R	16	351								15.5	17.3
	F	12	351								13.3	15.1
11	S	16	374	354.99	25	70	108	90	117	100	18.2	19.9
	R	16	383								17.6	19.4
	F	12	383								14.8	16.7
12	S	16	406	386.40	25	70	108	90	117	100	20.5	22.2
	R	16	414								19.9	21.6
	F	12	414								16.5	18.3



SC 5150-S.R.F													
No. of Teeth	Style	Teeth Face T	OD	P.C.D.	Bore Dia		Type B		Type C		Approx Weight Each		
					Min.	Max.	HD	HL	HD	HL	B	C	
6	S	16	316	300.00	25	60	93	70	103	90	12.20	14.60	
	R	16	328								11.70	14.10	
	F	11	328								9.20	11.80	
7	S	16	361	345.72	25	70	108	90	117	100	17.60	19.50	
	R	16	374								17.00	19.90	
	F	11	374								13.70	15.60	
8	S	16	407	391.85	25	70	108	90	117	100	21.00	22.80	
	R	16	420								20.50	22.10	
	F	11	420								16.00	17.90	
9	S	16	454	438.60	25	70	108	90	117	100	25.00	26.80	
	R	16	467								24.10	25.90	
	F	11	467								18.60	20.50	
10	S	16	501	485.44	30	75	117	100	127	110	31.00	33.20	
	R	16	513								30.10	32.50	
	F	11	513								23.40	25.70	
11	S	16	548	532.48	30	75	117	100	127	110	36.00	38.00	
	R	16	560								35.00	37.00	
	F	11	560								26.60	29.00	
12	S	16	595	579.60	30	85	127	110	137	120	43.50	46.00	
	R	16	608								42.50	45.00	
	F	11	608								32.50	35.50	
SC 7100-S.R.F													
6	S	20	219	200.00	25	65	98	80	108	90	9.00	10.50	
	R	20	232								8.40	9.90	
	F	12	232								7.00	8.60	
7	S	20	249	230.48	25	70	108	90	117	100	12.20	13.90	
	R	20	262								11.50	13.20	
	F	12	262								9.50	11.30	
8	S	20	280	261.23	25	70	108	90	117	100	14.10	15.90	
	R	20	293								13.40	15.10	
	F	12	293								10.60	12.40	
9	S	20	311	292.40	30	75	117	100	127	110	18.00	20.20	
	R	20	324								17.20	19.40	
	F	12	324								13.70	16.00	
10	S	20	342	323.62	30	75	117	100	127	110	20.60	22.80	
	R	20	355								19.60	21.80	
	F	12	355								15.10	17.50	
11	S	20	374	354.99	30	85	127	110	137	120	25.40	28.10	
	R	20	387								24.50	27.00	
	F	12	387								19.00	21.80	
12	S	20	405	386.40	30	85	127	110	137	120	28.30	31.00	
	R	20	418								27.20	30.00	
	F	12	418								20.70	23.50	
SC 10100-S.R.F													
6	S	22	221	200.00	25	70	108	90	98	100	10.90	12.60	
	R	22	235								10.30	12.00	
	F	16	235								9.20	11.00	
7	S	22	251	230.48	25	75	108	90	108	100	12.70	14.40	
	R	22	265								12.00	13.70	
	F	16	265								10.50	12.30	
8	S	22	282	151.23	25	70	108	90	108	100	14.90	16.60	
	R	22	296								14.00	15.70	
	F	16	296								12.00	13.80	
9	S	22	313	292.40	30	75	117	100	108	110	19.00	21.20	
	R	22	327								18.00	20.20	
	F	16	327								15.40	18.70	
10	S	22	345	323.62	30	75	117	100	117	110	21.80	24.90	
	R	22	359								20.70	22.90	
	F	16	359								17.40	20.60	
11	S	22	376	354.99	30	85	127	110	117	120	24.90	29.50	
	R	22	390								25.70	28.30	
	F	16	390								22.70	24.40	
12	S	22	407	386.40	30	85	127	110	117	120	30.00	32.70	
	R	22	421								28.80	21.40	
	F	16	421								25.00	26.70	

SC 430-S.R													
No. of Teeth	Style	Teeth Face T	OD	P.C.D.	Bore Dia		Type B		Type C		Approx Weight Each		
					Min.	Max.	HD	HL	HD	HL	B	C	
6	S	16	217	203.20	25	55	83	60	93	70	6.20	7.20	
	R	16	230								5.90	6.90	
7	S	16	248	234.21	25	55	87	70	98	80	8.20	9.50	
	R	16	261								7.90	9.10	
8	S	16	279	265.41	25	55	87	70	98	80	19.80	11.10	
	R	16	292								9.40	10.70	
9	S	16	311	297.08	25	55	87	70	98	80	11.60	12.90	
	R	16	324								11.20	12.40	
10	S	16	343	328.80	25	65	98	80	108	90	14.90	16.40	
	R	16	355								14.40	15.90	
11	S	16	375	360.67	25	65	98	80	108	90	17.10	18.60	
	R	16	387								16.50	18.10	
12	S	16	407	392.58	25	65	98	80	108	90	19.50	21.10	
	R	16	419								18.90	20.40	
SC 450-S.R.F													
6	S	19	219	203.20	25	55	87	70	98	80	7.50	8.80	
	R	19	234								7.20	8.40	
	F	16	234								6.50	7.80	
7	S	19	250	234.21	25	60	93	70	108	90	9.50	11.90	
	R	19	265								9.10	11.50	
	F	16	265								8.20	10.70	
8	S	19	281	265.41	25	60	93	70	108	90	11.40	13.80	
	R	19	297								10.90	13.20	
	F	16	297								9.70	12.20	
9	S	19	313	297.08	25	70	108	90	117	100	15.90	17.60	
	R	19	328								15.50	17.10	
	F	16	328								14.00	15.70	
10	S	19	344	328.80	25	70	108	90	117	100	18.30	20.00	
	R	19	360								17.70	19.40	
	F	16	360								15.90	17.70	
11	S	19	376	360.67	25	70	108	90	117	100	21.00	22.70	
	R	19	392								21.10	22.00	
	F	16	392								18.10	19.80	
12	S	19	408	392.58	25	70	108	90	117	100	24.00	25.50	
	R	19	424								23.00	24.90	
	F	16	424								20.50	20.20	
SC 650-S.R.F													
6	S	22	323	304.80	25	70	108	90	117	100	18.40	20.10	
	R	22	340								17.40	19.10	
	F	16	340								14.40	16.20	
7	S	22	369	351.31	25	70	108	90	117	100	22.60	24.30	
	R	22	387								21.50	23.10	
	F	16	387								17.40	19.20	
8	S	22	416	398.12	25	70	108	90	117	100	27.50	29.20	
	R	22	434								26.20	27.90	
	F	16	434								21.00	22.60	
9	S	22	464	445.61	25	70	108	90	117	100	33.10	34.80	
	R	22	481								31.70	33.40	
	F	16	481								24.80	26.60	
10	S	22	511	493.20	30	75	117	100	127	110	41.00	43.10	
	R	22	529								39.30	41.50	
	F	16	529								31.00	33.20	
11	S	22	559	541.00	30	85	127	110	137	120	50.00	52.60	
	R	22	577								48.20	50.80	
	F	16	577								38.00	41.00	
12	S	22	607	588.87	30	85	127	110	137	120	57.50	60.00	
	R	22	624								55.50	58.10	
	F	16	624								43.50	46.00	

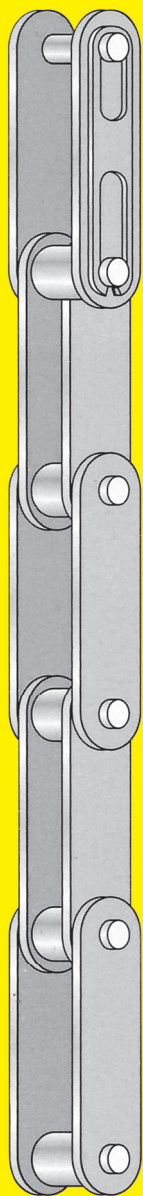

**PSM**<sup>®</sup>  
CHAIN

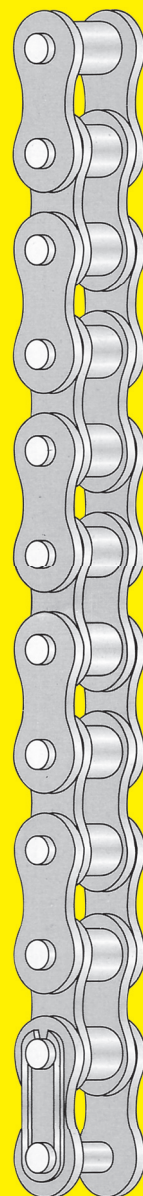

**P.S.M. MACHINERY LTD., PART.**

**ห.จ.ก. พี.เอส.เอ็ม แมชชีนเนอร์รี่**

88 หมู่ 4 ซอยชัยพฤกษ์ 18 (พื้ทักษ์ธรรม) ถนนชัยพฤกษ์ แขวงตลิ่งชัน เขตตลิ่งชัน กรุงเทพฯ 10170

88 MOO 4 SOI CHAIYAPHRUEK 18 (PHITAKTHAM) CHAIYAPHRUEK RD. TALING CHAN DISTRICT BANGKOK 10170

TEL : 02-882-2888, 02-882-2188 (AUTO 15 LINES) FAX : 02-882-1088, 02-886-7055

E-mail : [psm\\_service@psmbearing.com](mailto:psm_service@psmbearing.com) [www.psmbearing.com](http://www.psmbearing.com)